

NEW MEXICO  
OIL CONSERVATION COMMISSION

Form C-128

Well Location and/or Gas Proration Plat

Operator AUSTRAL OIL EXPLORATION CO., Inc <sup>1957 JAN 10</sup> <sup>DEC 27</sup> Date December 27, 1956 State of New Mexico

Well No. 3 Section 1 Township 16 South Range 35 East NMPM

Located 992.5 Feet From South Line, 2130.6 Feet From East Line,

Lea

County, New Mexico. G. L. Elevation 3968.5

Name of Producing Formation \_\_\_\_\_ Pool \_\_\_\_\_ Dedicated Acreage \_\_\_\_\_

(Note: All distances must be from outer boundaries of Section)

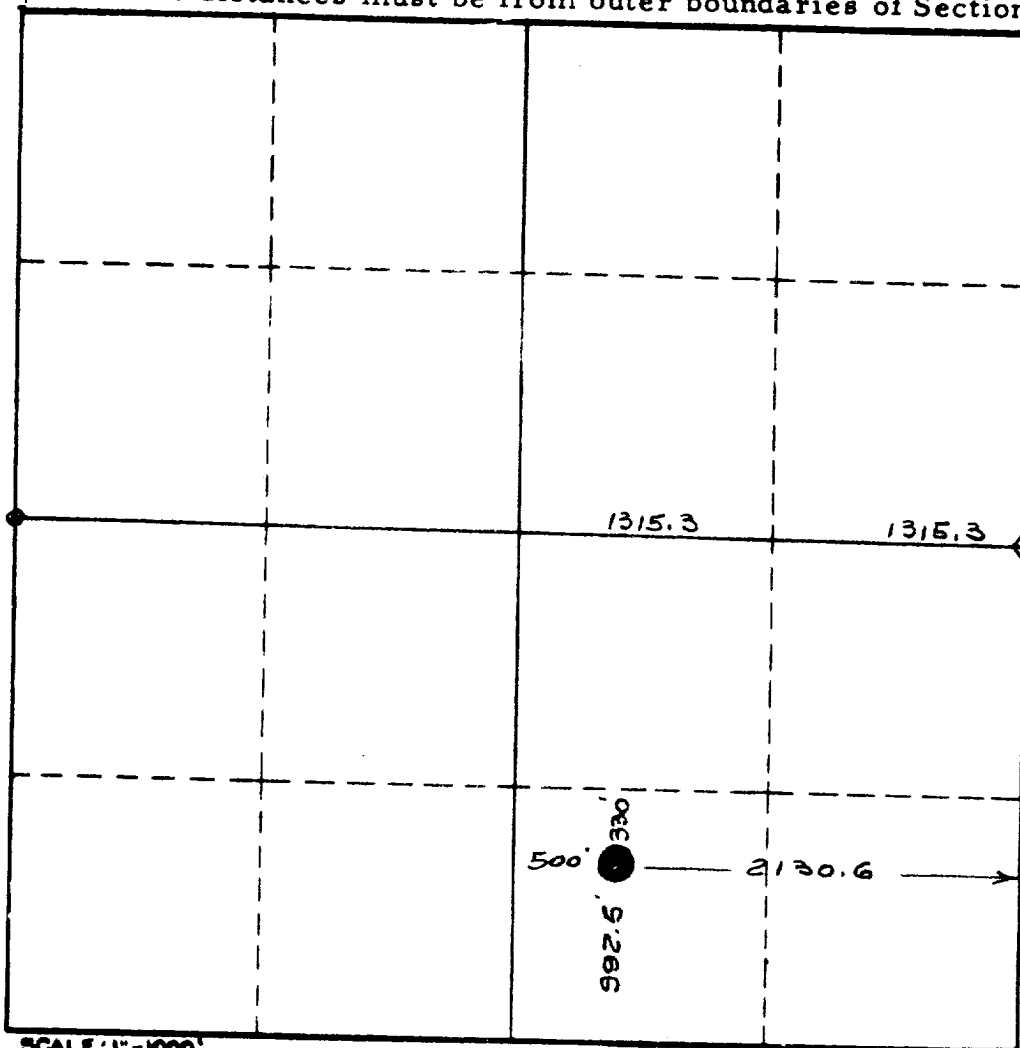

LEGEND:

○ Staked Well Location

◇ Std. GLO Rock Cor.

○ Std. GLO BC Corner

NOTE

This section of form is to be used for gas wells only.



1. Is this Well a Dual Comp.? Yes \_\_\_ No \_\_\_.
2. If the answer to Question 1 is yes, are there any other dually completed wells within the dedicated acreage? Yes \_\_\_ No \_\_\_.

This is to certify that the above plat was prepared from field notes of actual surveys made by me or under my supervision and that the same are true and correct to the best of my knowledge and belief.

Date Surveyed December 27, 1956

W. W. [Signature]  
Registered Professional Engineer and/or  
Land Surveyor License No. 1559

Name \_\_\_\_\_  
Position \_\_\_\_\_  
Representing \_\_\_\_\_  
Address \_\_\_\_\_