

NEW MEXICO  
OIL CONSERVATION COMMISSION

Form C-28

Well Location and/or Gas Proration Plat

Operator Austral Oil Exploration Company Inc. Date November 23, 1956  
Lease State of New Mexico "B"  
Well No. 4 Section 1 Township 16 South Range 35 East NMPM  
Located 4610 Feet From South Line 2300.6 Feet From East Line,  
Lea County, New Mexico. G. L. Elevation 3973.7  
Name of Producing Formation \_\_\_\_\_ Pool \_\_\_\_\_ Dedicated Acreage \_\_\_\_\_

(Note: All distances must be from outer boundaries of Section)

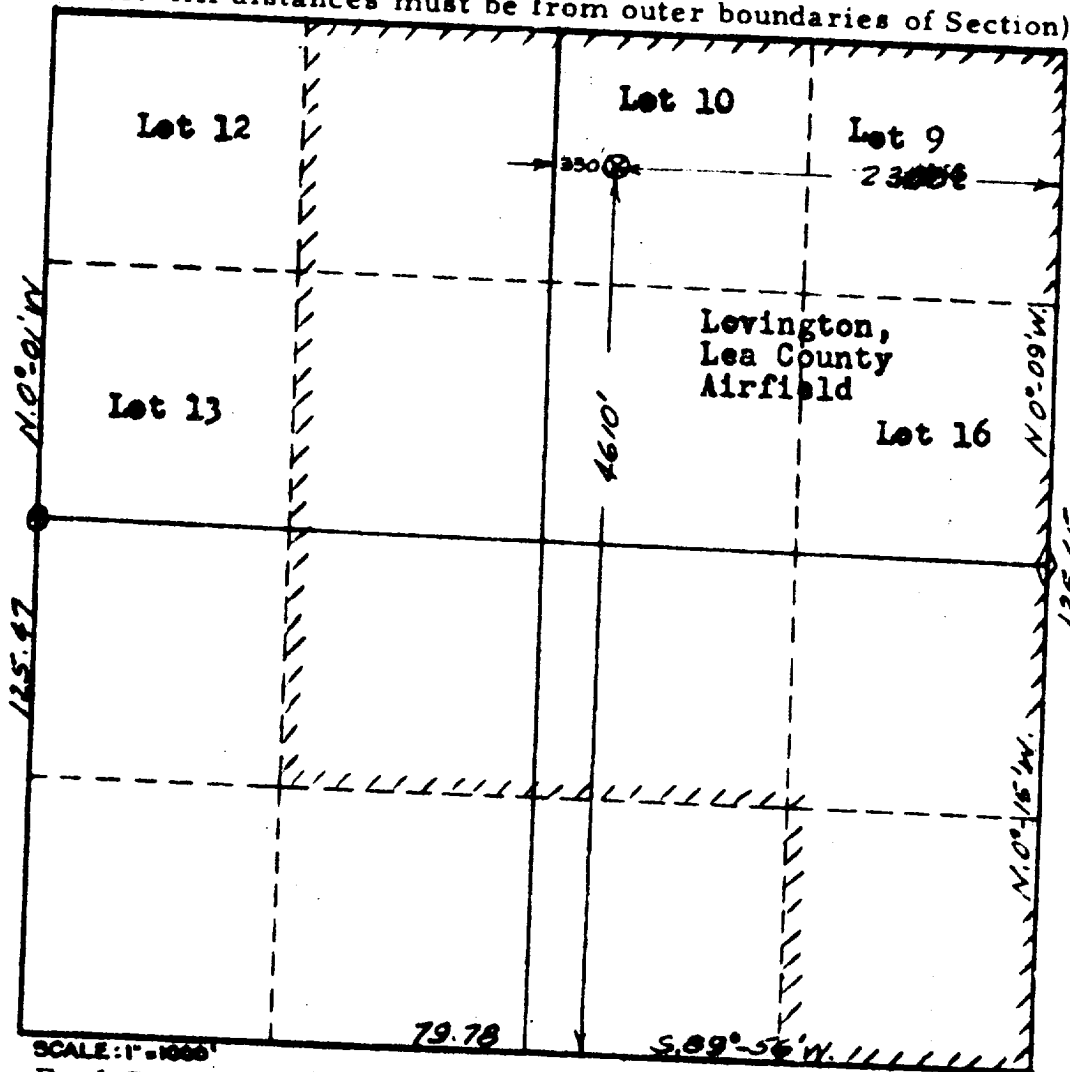

LEGEND:

- ⊗ Staked Well Location
- Std. GLO BC Corner
- ◇ Std. GLO Rock Corn

SCALE: 1"=1000'

1. Is this Well a Dual Comp. ? Yes ☐ No ☐
2. If the answer to Question 1 is yes, are there any other dually completed wells within the dedicated acreage? Yes ☐ No ☐

This is to certify that the above plat was prepared from field notes of actual surveys made by me or under my supervision and that the same are true and correct to the best of my knowledge and belief.

Name \_\_\_\_\_  
Position \_\_\_\_\_  
Representing \_\_\_\_\_  
Address \_\_\_\_\_

Date Surveyed November 23, 1956  
John W. Pharr  
Registered Professional Engineer and/or  
Land Surveyor License No. 1559