

NEW MEXICO OIL CONSERVATION COMMISSION
Santa Fe, New Mexico

NOTICE OF INTENTION TO DRILL OR RECOMPLETE

Notice must be given to the District Office of the Oil Conservation Commission and approval obtained before drilling or recompletion begins. If changes in the proposed plan are considered advisable, a copy of this notice showing such changes will be returned to the sender. Submit this notice in **QUINTUPLICATE**. One copy will be returned following approval. See additional instructions in Rules and Regulations of the Commission. **If State Land submit 6 Copies**

Hobbs, New Mexico
(Place)

August 27, 1956
(Date)

OIL CONSERVATION COMMISSION
SANTA FE, NEW MEXICO

Gentlemen:

You are hereby notified that it is our intention to commence the (Drilling) ~~completion~~ of a well to be known as

Skelly Oil Company
(Company or Operator)

Hobbs #D
(Lease)

, Well No. **1**, in **"C"** (Unit) The well is

located **2310** feet from the **West** line and **330** feet from the

North line of Section **17**, T. **16S**, R. **35E**, NMPM.

(GIVE LOCATION FROM SECTION LINE) **Ridgely-Pennsylvanian** Pool, **Lee** County

If State Land the Oil and Gas Lease is No. **R-9970**

If patented land the owner is.....

Address.....

We propose to drill well with drilling equipment as follows: **To be drilled with rotary tools from surface to total depth.**

The status of plugging bond is.....

Drilling Contractor **Makin Drilling Company**

We intend to complete this well in the **Pennsylvanian** formation at an approximate depth of **10,750'** feet.

CASING PROGRAM

We propose to use the following strings of Casing and to cement them as indicated:

Size of Hole	Size of Casing	Weight per Foot	New or Second Hand	Depth	Sacks Cement
18"	13-3/8"OD	44.5#	New	350'	350'
11"	8-5/8"OD	32#	New	4700'	2800
7-7/8"	5-1/2"OD	17#	New	10,750	800

If changes in the above plans become advisable we will notify you immediately.

ADDITIONAL INFORMATION (If recompletion give full details of proposed plan of work.)

The Halliburton process will be used in cementing all casing and cement will be circulated to surface on the 13-3/8"OD casing.

Approved **AUG 28 1956**, 19.....
Except as follows:

Sincerely yours,

Skelly Oil Company
(Company or Operator)

By.....

Position.....

Send Communications regarding well to

Name.....

Address.....

Skelly Oil Company
Box 38 Hobbs, New Mexico

OIL CONSERVATION COMMISSION

By.....

NEW MEXICO
OIL CONSERVATION COMMISSION

Form C-128

Well Location and/or Gas Proration Plat

Date 8/22/56

Operator Shelly Oil Co.

Lease Hobbs D

7:50

Well No. 1 Section 17 Township 16 S Range 35 E NMPM

Located 2310 Feet From West Line, 330 Feet From North Line,

Lea County, New Mexico. G. L. Elevation _____

Name of Producing Formation _____ Pool _____ Dedicated Acreage _____

(Note: All distances must be from outer boundaries of Section)

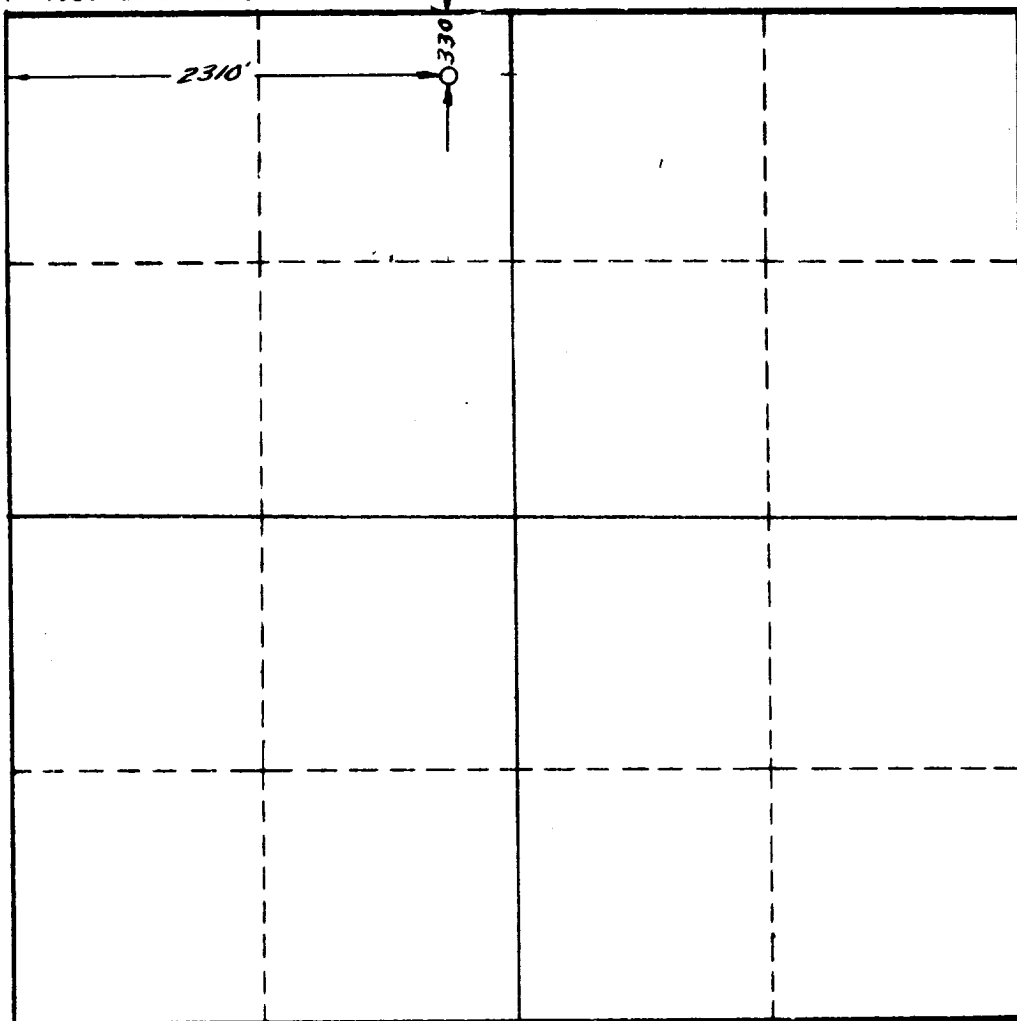

SCALE: 1"=1000'

1. Is this Well a Dual Comp. ? Yes No X.
2. If the answer to Question 1 is yes, are there any other dually completed wells within the dedicated acreage? Yes No .

This is to certify that the above plat was prepared from field notes of actual surveys made by me or under my supervision and that the same are true and correct to the best of my knowledge and belief.

Name _____
Position Dist. Supt.
Representing Shelly Oil Co.
Address Box 38 - Hobbs, N.M.

Date Surveyed 8-21-56
John W. Hunt
Registered Professional Engineer and/or
Land Surveyor