

NEW MEXICO OIL CONSERVATION COMMISSION

Well Location and Acreage Dedication Plat

Section A.

Date 6-20-57

Operator Western Natural Gas Co. Lease Edison "D"
Well No. 1 Unit Letter E Section 26 Township 16 S Range 35 E NMPM
Located 1980 Feet From North Line, 990 Feet From West Line
County Lea G. L. Elevation 3965.7 Dedicated Acreage 40 Acres
Name of Producing Formation Devonian Pool Shaw Box Devonian

1. Is the Operator the only owner* in the dedicated acreage outlined on the plat below?
Yes _____ No X _____.
2. If the answer to question one is "no," have the interests of all the owners been consolidated by communitization agreement or otherwise? Yes X _____ No _____. If answer is "yes," Type of Consolidation Joint operating agreement
3. If the answer to question two is "no," list all the owners and their respective interests below:

Owner

Land Description

Section B

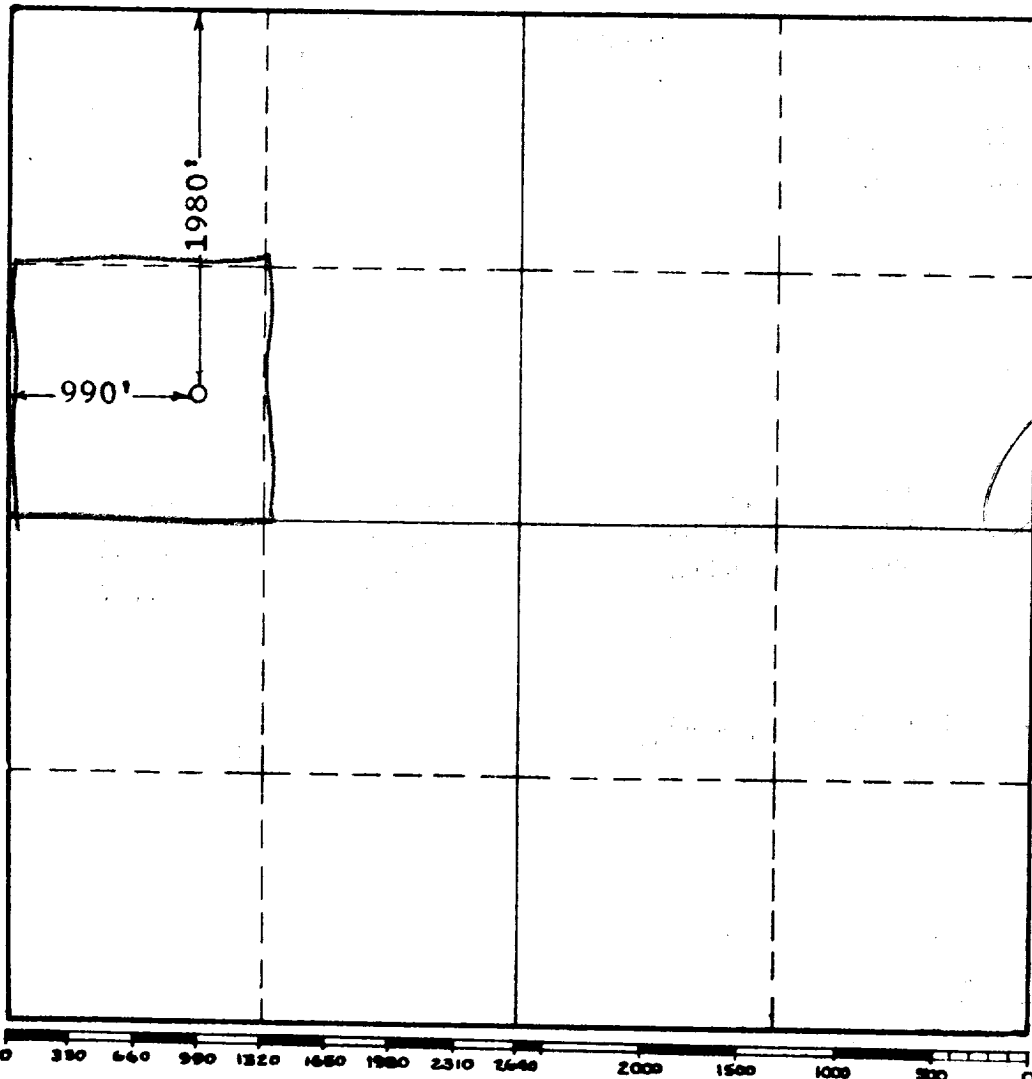

This is to certify that the information in Section A above is true and complete to the best of my knowledge and belief.

Western Natural Gas Company

(Operator)

John S. Thomas
(Representative)

823 Midland Tower, Midland, Tex.

Address

This is to certify that the well location shown on the plat in Section B was plotted from field notes of actual surveys made by me or under my supervision and that the same is true and correct to the best of my knowledge and belief.

Date Surveyed 6-20-57

John W. West
Registered Professional
Engineer and/or Land Surveyor.

Certificate No. 676

(See instructions for completing this form on the reverse side)