

# WELL LOCATION SURVEY PLAT

OPERATOR TOBE FOSTER  
LEASE STATE  
WELL NO. 1

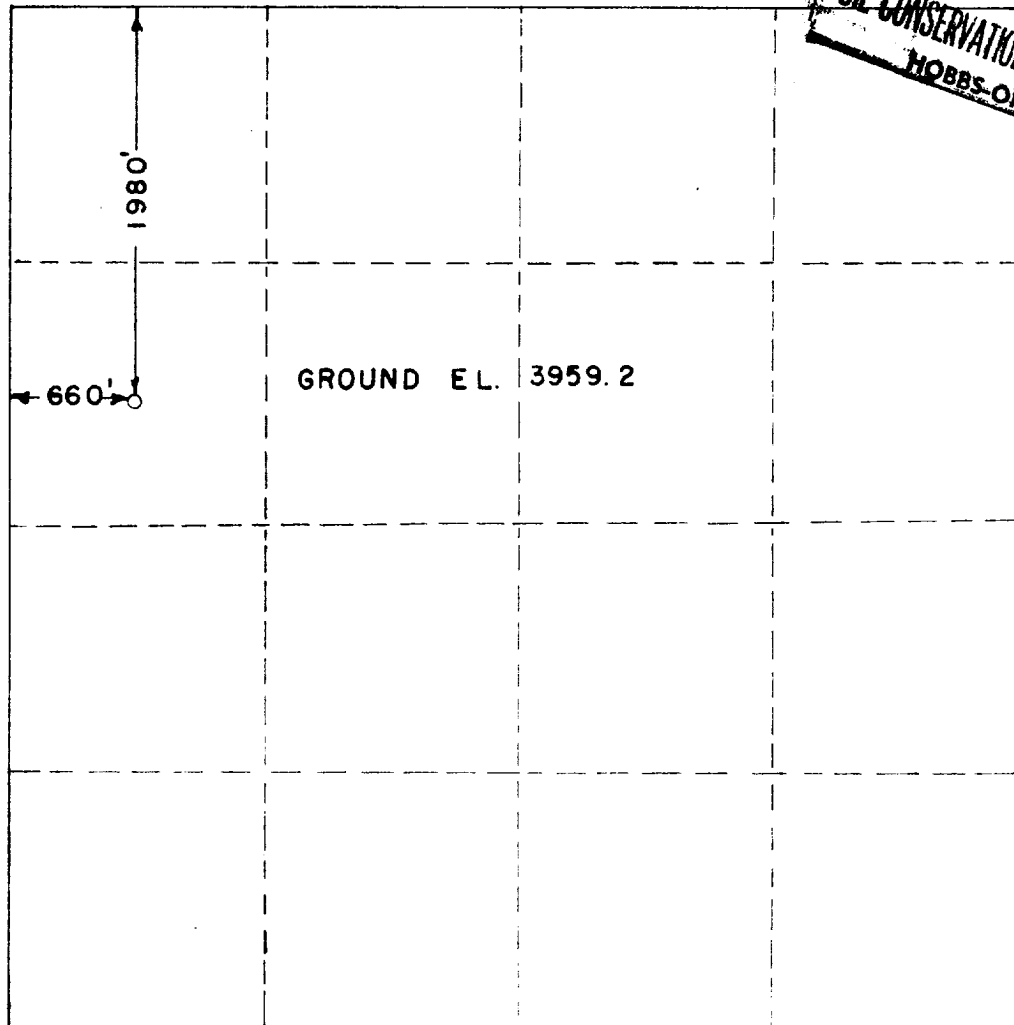
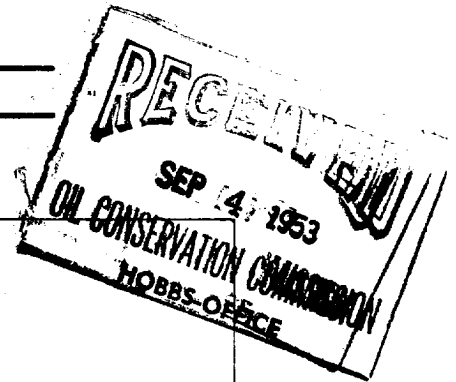

SEC. 36, TWP. 16 S., RGE. 35 E., N.M.P.M.

I HEREBY CERTIFY THAT THIS PLAT WAS MADE  
FROM NOTES TAKEN IN THE FIELD BY ME AND  
THAT THE SAME IS TRUE AND CORRECT TO  
THE BEST OF MY KNOWLEDGE AND BELIEF.

A handwritten signature in cursive script, appearing to read "John W. West".

JOHN W. WEST, PE & LS NO. 676

9 - 2 - 1953