

NEW MEXICO OIL CONSERVATION COMMISSION
Santa Fe, New Mexico

NOTICE OF INTENTION TO DRILL

Notice must be given to the District Office of the Oil Conservation Commission and approval obtained before drilling or recompletion begins. If changes in the proposed plan are considered advisable, a copy of this notice showing such changes will be returned to the sender. Submit this notice in **QUINTUPLICATE**. One copy will be returned following approval. See additional instructions in Rules and Regulations of the Commission. If State Land submit 6 Copies

Midland, Texas
(Place)

April 12, 1956
(Date)

OIL CONSERVATION COMMISSION
SANTA FE, NEW MEXICO

Gentlemen:

You are hereby notified that it is our intention to commence the (Drilling) **163519160** of a well to be known as **780-56**
Humble Oil & Refining Company (Purchase number **unknown**)
(Company or Operator)

Doughty Company et al, Well No. **1**, in **"G"**
(Lease) (Unit)

located **1980** feet from the **North** line and **1830** feet from the

East line of Section **32**, T. **-15-S**, R. **-36-E**, NMPM.

(GIVE LOCATION FROM SECTION LINE) **North Lovington Wildcat** Pool, **Lee** County

D	C	B	A
E	F	"G"	H
L	K	J	I
M	N	O	P

See attached plat

If State Land the Oil and Gas Lease is No. **--**

If patented land the owner is **--**

Address **--**

We propose to drill well with drilling equipment as follows: **Rotary Rig**

The status of plugging bond is **on file with commission.**

Drilling Contractor **Unknown**

We intend to complete this well in the **Devonian** formation at an approximate depth of **14,000** feet.

CASING PROGRAM

We propose to use the following strings of Casing and to cement them as indicated:

Size of Hole	Size of Casing	Weight per Foot	New or Second Hand	Depth	Sacks Cement
17-1/2"	13-5/8"	49#	New	350'	600*
12-1/4"	9-5/8"	30#	"	4950'	2500**
8-3/4"	5-1/2"	17, 20 & 23#	"	14,000'	1500***

If changes in the above plans become advisable we will notify you immediately.

ADDITIONAL INFORMATION (If recompletion give full details of proposed plan of work.)

- * Circulate to surface.
- ** Circulate to 13-5/8" casing.
- *** Circulate to 9-5/8" casing.

Approved **APR 18 1956**, 19.....

Except as follows:

This approval subject to final approval of unorthodox location.

OIL CONSERVATION COMMISSION

By **C. M. Kreder**

Sincerely yours,

Humble Oil & Refining Company
(Company or Operator)

By **[Signature]**

Position **Asst. Division Superintendent**
Send Communications regarding well to

Name **J. W. House**

Address **Box 1600, Midland, Texas**

1. The first part of the document is a list of the names of the persons who have been appointed to the various offices of the city of New York.

2.

3.

4.

5.

6.

7.

8.

9.

10.

11.

12.

13.

14.

15.

16.

17.

18.

19.

20.

21.

22.

23.

24.

25.

26.

27.

28.

29.

30.

31.

32.

33.

34.

35.

36.

37.

38.

39.

40.

41.

42.

43.

44.

45.

46.

47.

48.

49.

50.

51.

NEW MEXICO
OIL CONSERVATION COMMISSION

Form C-128

Well Location and/or Gas Proration

HOBBBS OFFICE - DEC 56
Date 1956 APR 13 PM 2:47

Operator HUMBLE OIL & REFINING CO Lease DAUGHTER COMPANY ET AL

Well No. 1 Section 32 Township 15-9 Range 36-E NMPM

Located 1980 Feet From NORTH Line, 1830 Feet From EAST Line,

LEA County, New Mexico. G. L. Elevation _____

Name of Producing Formation 14,000' WILDCAT Pool _____ Dedicated Acreage 40

(Note: All distances must be from outer boundaries of Section)

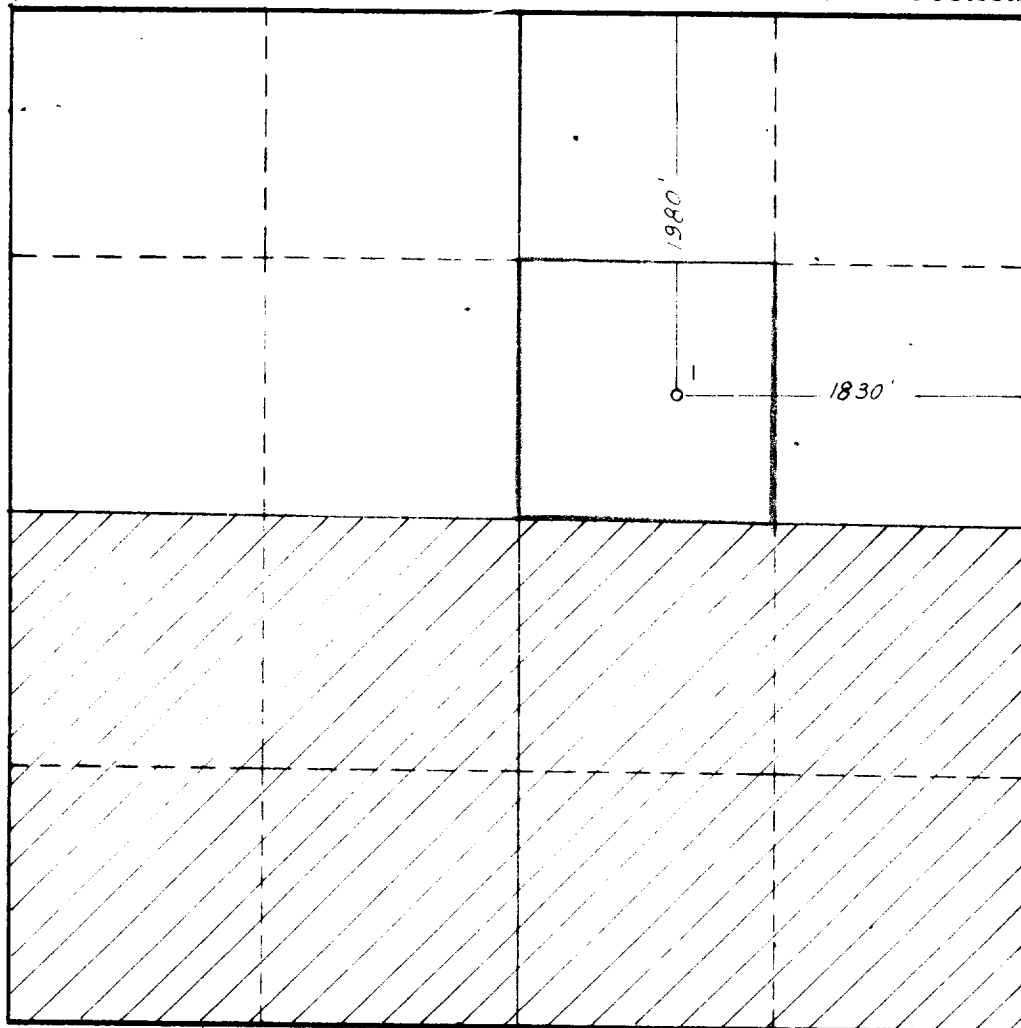

1. Is this Well a Dual Comp. ? Yes No
2. If the answer to Question 1 is yes, are there any other dually completed wells within the dedicated acreage? Yes No

This is to certify that the above plat was prepared from field notes of actual surveys made by me or under my supervision and that the same are true and correct to the best of my knowledge and belief.

Name E. T. Shahan
Position ASSISTANT DIVISION SUPERINTENDENT
Representing HUMBLE OIL & REFINING CO
Address BOX 1600

Date Surveyed 3-5-56
E. T. Shahan
Registered Professional Engineer and/or
Land Surveyor

WA 2100

113