

NEW MEXICO OIL CONSERVATION COMMISSION
Well Location and Acreage Dedication Plat

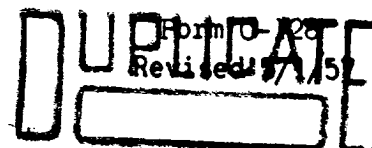

Section A.

Date March 19, 1958

Operator AUSTRAL OIL EXPLORATION COMPANY, Inc. Lease W. M. Snyder "B"
Well No. 2 Unit Letter Section 6 Township 16 South Range 36 East NMPM
Located 3656.4 Feet From North Line, 2310 Feet From East Line
County Lea G. L. Elevation 3954.1 Dedicated Acreage 40 Acres
Name of Producing Formation Wolfcamp Pool Undesignated

1. Is the Operator the only owner* in the dedicated acreage outlined on the plat below?
Yes X No .
2. If the answer to question one is "no," have the interests of all the owners been consolidated by communitization agreement or otherwise? Yes No . If answer is "yes," Type of Consolidation
3. If the answer to question two is "no," list all the owners and their respective interests below:

Owner

Land Description

Section B

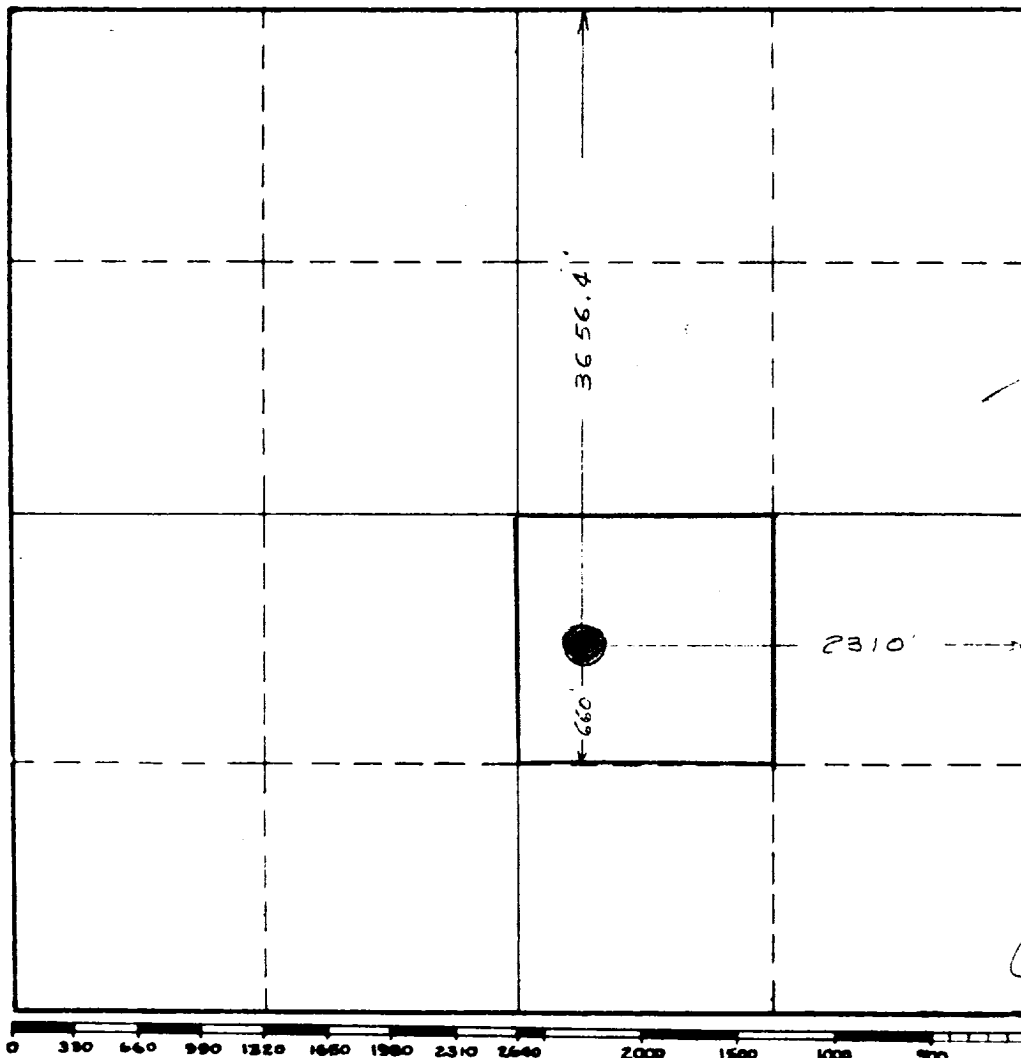

This is to certify that the information in Section A above is true and complete to the best of my knowledge and belief.

Austral Oil Exploration Company Incorporated
(Operator)

G. W. Frank
(Representative)

300 San Jacinto Building,
Address
Houston, Texas

This is to certify that the well location shown on the plat in Section B was plotted from field notes of actual surveys made by me or under my supervision and that the same is true and correct to the best of my knowledge and belief.

Date Surveyed March 17, 1958

John W. Dye
Registered Professional
Engineer and/or Land Surveyor.

Certificate No. 1559

(See instructions for completing this form on the reverse side)