

NEW MEXICO OIL CONSERVATION COMMISSION  
Santa Fe, New Mexico

Form C-101  
Revised (12/1/55)

NOTICE OF INTENTION TO DRILL

Notice must be given to the District Office of the Oil Conservation Commission and approval obtained before drilling or recompletion begins. If changes in the proposed plan are considered advisable, a copy of this notice showing such changes will be returned to the sender. Submit this notice in QUINTUPLICATE. One copy will be returned following approval. See additional instructions in Rules and Regulations of the Commission. If State Land submit 6 Copies Attach Form C- 128 in triplicate to first 3 copies of form C-101

Fort Worth 1, Texas  
(Place)

January 22, 1958  
(Date)

OIL CONSERVATION COMMISSION  
SANTA FE, NEW MEXICO

Gentlemen:

You are hereby notified that it is our intention to commence the Drilling of a well to be known as

TEXAS PACIFIC COAL AND OIL COMPANY

(Company or Operator)

State of New Mexico "T"  
(Lease)

Well No. 3, in 1/4 N The well is

located 3300 feet from the South line and 1551 feet from the West line of Section 6, T. 16-S, R. 36-E, NMPM.

(GIVE LOCATION FROM SECTION LINE)

Thousand Pool, Lea County

If State Land the Oil and Gas Lease is No. 382

If patented land the owner is

Address

We propose to drill well with drilling equipment as follows: Rotary

The status of plugging bond is Required Bond on File

Drilling Contractor Cactus Drilling Corporation

We intend to complete this well in the Wolfcamp formation at an approximate depth of 11,000' feet.

CASING PROGRAM

We propose to use the following strings of Casing and to cement them as indicated:

Size of Hole	Size of Casing	Weight per Foot	New or Second Hand	Depth	Sacks Cement
17-1/4"	13-3/8"	48#	New	300'	300
12-1/4"	8-5/8"	28-32#	"	4,700'	2,000
7-7/8"	5-1/2"	17-20#	"	11,000'	3,000

If changes in the above plans become advisable we will notify you immediately.

ADDITIONAL INFORMATION (If recompletion give full details of proposed plan of work.)

Approved \_\_\_\_\_, 19\_\_\_\_  
Except as follows:

OIL CONSERVATION COMMISSION

By \_\_\_\_\_

Sincerely yours,

TEXAS PACIFIC COAL AND OIL COMPANY

(Company or Operator)

By \_\_\_\_\_

Position Manager of Production

Send Communications regarding well to

Name R. W. Hines

Address P.O. Box 2110, Fort Worth 1, Texas

NEW MEXICO OIL CONSERVATION COMMISSION  
Well Location and Acreage Dedication Plat

Form C-128  
Revised 5/1/57

Section A.

Date 1-20-1958

Operator Texas Pacific Coal & Oil Co. lease State of New Mexico "T"  
Well No. 3 Unit Letter N Section 6 Township 16 South Range 36 East NMPM  
Located 3300 Feet From South Line, 1551 Feet From West Line  
County Lea C. L. Elevation 3958.2 Dedicated Acreage UNDESIGNATED Acres  
Name of Producing Formation Helford Pool UNDESIGNATED

1. Is the Operator the only owner\* in the dedicated acreage outlined on the plat below?  
Yes X No       .
2. If the answer to question one is "no," have the interests of all the owners been consolidated by communitization agreement or otherwise? Yes        No       . If answer is "yes," Type of Consolidation
3. If the answer to question two is "no," list all the owners and their respective interests below:

Owner

Land Description

Section B

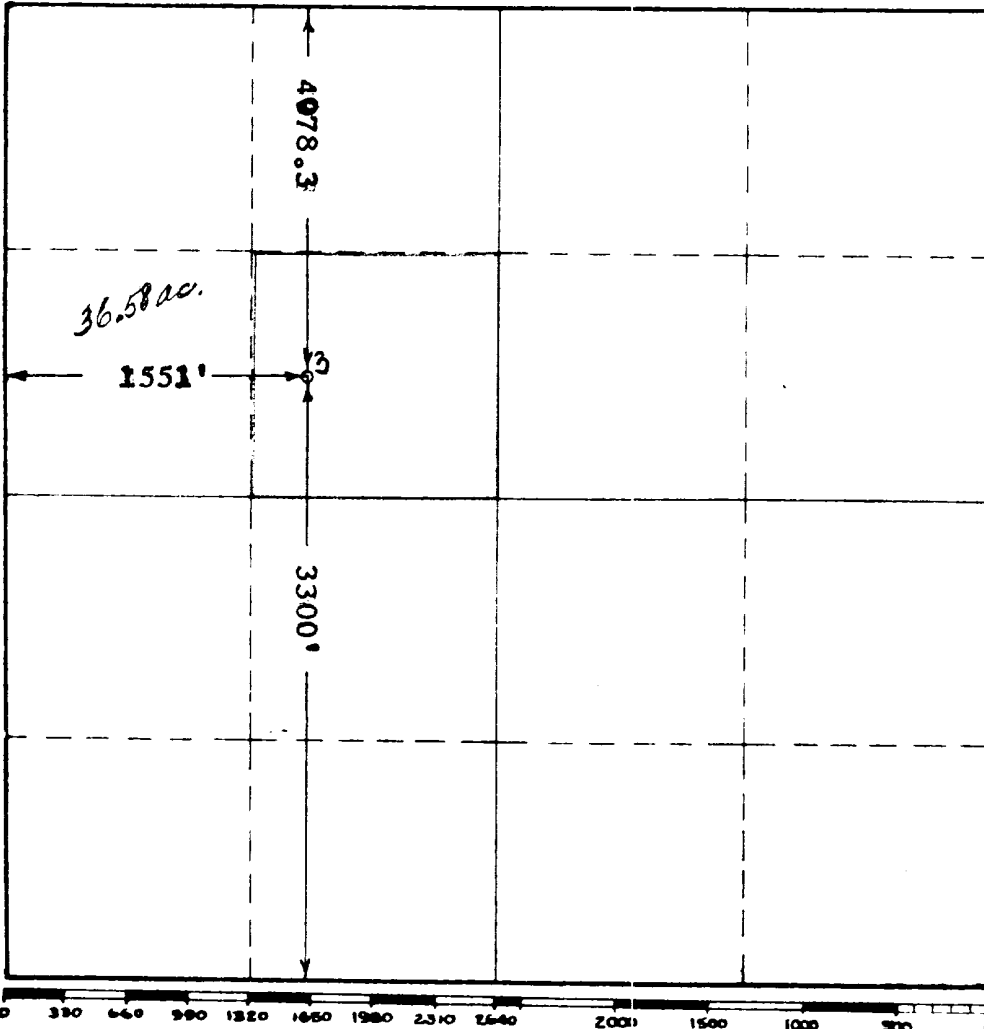

This is to certify that the information in Section A above is true and complete to the best of my knowledge and belief.

**TEXAS PACIFIC COAL & OIL COMPANY**

(Operator)

*R. W. Smith*

(Representative)

**P.O. Box 2110, Fort Worth 1, Texas**  
Address

This is to certify that the well location shown on the plat in Section B was plotted from field notes of actual surveys made by me or under my supervision and that the same is true and correct to the best of my knowledge and belief.

Date Surveyed 1-21-1958

*John W. West*  
Registered Professional  
Engineer and/or Land Surveyor.

Certificate No. 676

(See instructions for completing this form)