

NEW MEXICO OIL CONSERVATION COMMISSION
Well Location and Acreage Dedication Plat

Section A.

Date 7-22-1957

Operator Holder & Ross Lease Shell State
Well No. 1 Unit Letter N Section 26 Township 16 South Range 36 NMPM
Located 1980 Feet From West Line, 660 Feet From South Line
County Lea G. L. Elevation 3864 Dedicated Acreage 8.40 Acres
Name of Producing Formation Test - San Andres Pool Undesignated

1. Is the Operator the only owner* in the dedicated acreage outlined on the plat below?
Yes _____ No X.
2. If the answer to question one is "no," have the interests of all the owners been consolidated by communitization agreement or otherwise? Yes _____ No X. If answer is "yes," Type of Consolidation _____
3. If the answer to question two is "no," list all the owners and their respective interests below:

<u>Owner</u>		<u>Land Description</u>
<u>Holder and Ross</u>	<u>20 %</u>	<u>SW 1/4; Section 26, T 16S, R 36E</u>
<u>Valma Petroleum Corporation</u>	<u>20 %</u>	
<u>R. L. Summers</u>	<u>20 %</u>	
<u>Malvin Neal</u>	<u>20 %</u>	

Section B

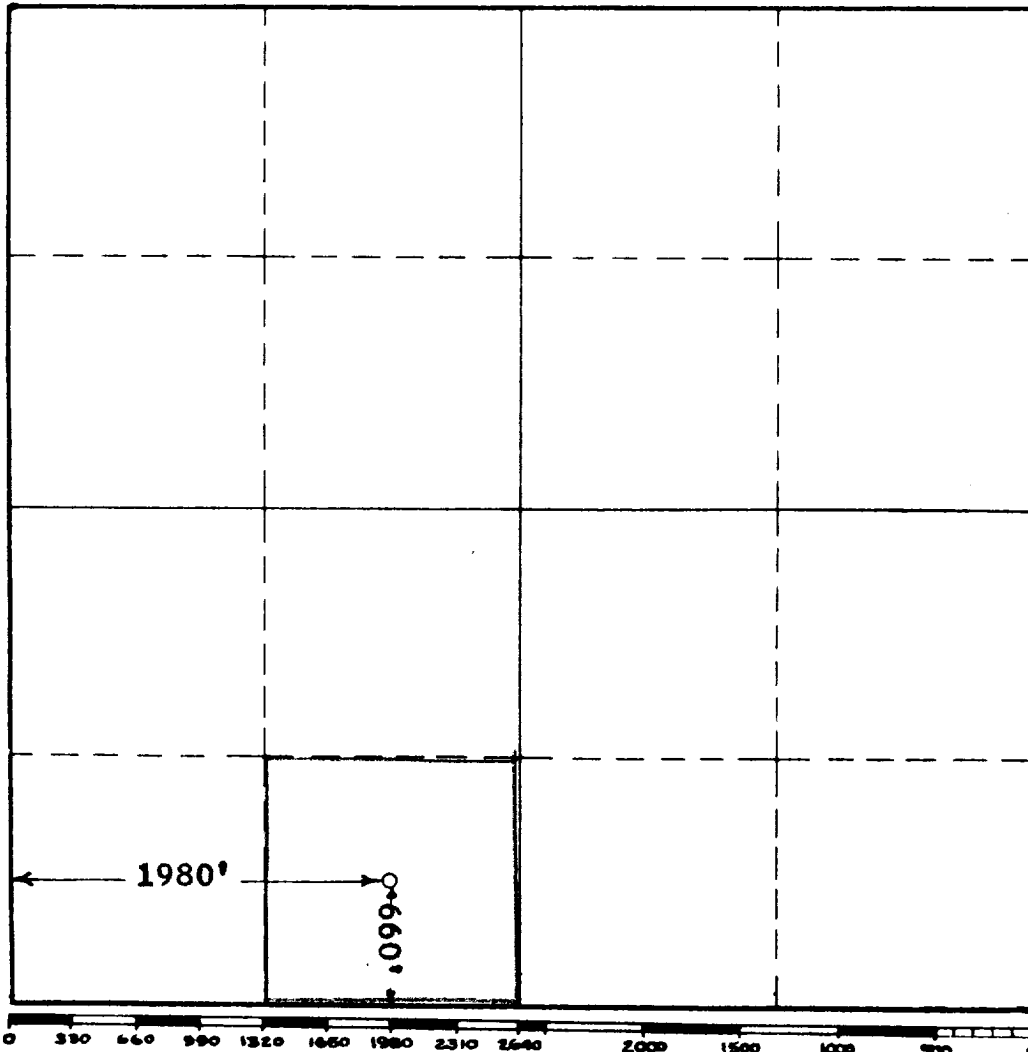

This is to certify that the information in Section A above is true and complete to the best of my knowledge and belief.

Holder & Ross
(Operator)

Leroy Ullis
(Representative)

Box 1955 Hobbs N.M.
Address

This is to certify that the well location shown on the plat in Section B was plotted from field notes of actual surveys made by me or under my supervision and that the same is true and correct to the best of my knowledge and belief.

Date Surveyed 7-22-57

John W. West
Registered Professional
Engineer and/or Land Surveyor.

Certificate No. 676

(See instructions for completing this form on the reverse side)