

DUPLICATE

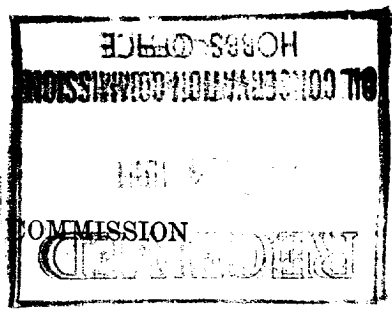

FORM C-105

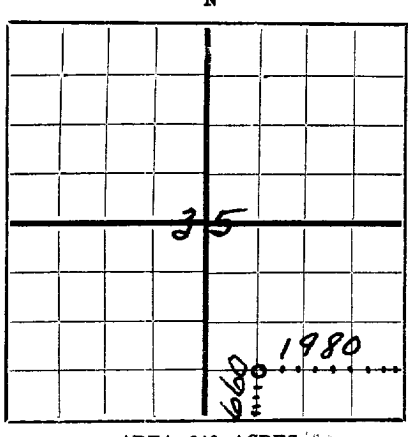

AREA 640 ACRES  
LOCATE WELL CORRECTLY

NEW MEXICO OIL CONSERVATION  
Santa Fe, New Mexico

WELL RECORD

Mail to Oil Conservation Commission, Santa Fe, New Mexico, or its proper agent not more than twenty days after completion of well. Follow instructions in the Rules and Regulations of the Commission. Indicate questionable data by following it with (?). SUBMIT IN TRIPLICATE. FORM C-110 WILL NOT BE APPROVED UNTIL FORM C-105 IS PROPERLY FILLED OUT.

Magnolia Petroleum Company  
T. D. Pope  
Well No. 1 in SE/4 of Sec. 35, T. 14-S  
R. 37-E, N. M. P. M., Denton Field, Lea County.  
Well is 660 feet North of the East line and 1980 feet west of the East line of Section 35  
If State land the oil and gas lease is No. Assignment No.  
If patented land the owner is T. D. Pope Address c/o B. H. Pope, Box 1035, Lovington, New Mexico  
If Government land the permittee is Address  
The Lessee is Magnolia Petroleum Company Address Box 727, Kermit, Texas.  
Drilling commenced May 12 19 51 Drilling was completed October 30 19 51  
Name of drilling contractor Helmerich & Payne, Inc. Address Tulsa, Oklahoma  
Elevation above sea level at top of casing 3815 feet.  
The information given is to be kept confidential until 19.

OIL SANDS OR ZONES

No. 1, from to No. 4, from to  
No. 2, from to No. 5, from to  
No. 3, from to No. 6, from to

IMPORTANT WATER SANDS

Include data on rate of water inflow and elevation to which water rose in hole.  
No. 1, from to feet.  
No. 2, from to feet.  
No. 3, from to feet.  
No. 4, from to feet.

CASING RECORD

| SIZE   | WEIGHT PER FOOT | THREADS PER INCH | MAKE | AMOUNT | KIND OF SHOE | CUT & FILLED FROM | PERFORATED |     | PURPOSE      |
|--------|-----------------|------------------|------|--------|--------------|-------------------|------------|-----|--------------|
|        |                 |                  |      |        |              |                   | FROM       | TO  |              |
| 13-3/8 | 48              | 8-RT             | B-40 | 411    | Howco        | - - -             | - -        | - - | Surface      |
| 8-5/8  | 32              | 8-RT             | J-55 | 4746   | Howco        | - - -             | - -        | - - | Intermediate |
| 5-1/2  | 20              | 8-RT             | B-80 |        |              |                   |            |     |              |
|        | 17              | 8-RT             | B-80 | 12487  | Howco        | - - -             | - -        | - - | Oil String   |
|        |                 |                  |      |        |              |                   |            |     |              |
|        |                 |                  |      |        |              |                   |            |     |              |
|        |                 |                  |      |        |              |                   |            |     |              |

MUDDING AND CEMENTING RECORD

| SIZE OF HOLE | SIZE OF CASING | WHERE SET | NO. SACKS OF CEMENT | METHODS USED | MUD GRAVITY | AMOUNT OF MUD USED |
|--------------|----------------|-----------|---------------------|--------------|-------------|--------------------|
| 17-1/2       | 13-3/8         | 411       | 425-75              | Pump & Plug  |             |                    |
| 11           | 8-5/8          | 4746      | 2899-800            | Pump & Plug  |             |                    |
| 7-7/8        | 5-1/2          | 12487     | 440-25/1328         | Pump & Plug  |             |                    |

PLUGS AND ADAPTERS

Heaving plug—Material Length Depth Set  
Adapters — Material Size

RECORD OF SHOOTING OR CHEMICAL TREATMENT

| SIZE | SHELL USED | EXPLOSIVE OR CHEMICAL USED | QUANTITY | DATE | DEPTH SHOT OR TREATED | DEPTH CLEANED OUT |
|------|------------|----------------------------|----------|------|-----------------------|-------------------|
|      |            |                            |          |      |                       |                   |
|      |            |                            |          |      |                       |                   |
|      |            |                            |          |      |                       |                   |

Results of shooting or chemical treatment

RECORD OF DRILL-STEM AND SPECIAL TESTS

If drill-stem or other special tests or deviation surveys were made, submit report on separate sheet and attach hereto.

TOOLS USED

Rotary tools were used from 0 feet to 12702 feet, and from feet to feet  
Cable tools were used from feet to feet, and from feet to feet

PRODUCTION

Put to producing November 4 19 51  
The production of the first 24 hours was 485.7 barrels of fluid of which % was oil; % emulsion; % water; and % sediment. Gravity, Be.  
If gas well, cu. ft. per 24 hours Gallons gasoline per 1,000 cu. ft. of gas  
Rock pressure, lbs. per sq. in.

EMPLOYEES

Driller Driller  
Driller Driller

FORMATION RECORD ON OTHER SIDE

I hereby swear or affirm that the information given herewith is a complete and correct record of the well and all work done on it so far as can be determined from available records.

Subscribed and sworn to before me this 21st Kermit, Texas December 21, 1951  
day of December 21, 19 51 Name Malesher Position District Superintendent

