

NEW MEXICO OIL CONSERVATION COMMISSION

Santa Fe, New Mexico

NOTICE OF INTENTION TO DRILL

Notice must be given to the Oil Conservation Commission or its proper agent and approval obtained before drilling begins. If changes in the proposed plan are considered advisable, a copy of this notice showing such changes will be returned to the sender. Submit this notice in triplicate. One copy will be returned following approval. See additional instructions in Rules and Regulations of the Commission.

Bartlesville, Oklahoma

Place

MAR 21 1951

Date

OIL CONSERVATION COMMISSION,
Santa Fe, New Mexico,

Gentlemen:

You are hereby notified that it is our intention to commence the drilling of a well to be known as

Phillips Petroleum CompanyDentonWell No. 2 in NE/4

Company or Operator

Lease

of Sec. 11, T. 15S, R. 37E, N. M., P. M., Denton Field, Lea County.

N

The well is 659 feet (N.) 1/4 of the south line and 1987 feet 1/4 (W.) of the east line of NE/4 Section 11

(Give location from section or other legal subdivision lines. Cross out wrong directions.)

If state land the oil and gas lease is No. - Assignment No. -If patented land the owner is James M. DentonAddress Brownfield, TexasIf government land the permittee is -Address -The lessee is Phillips Petroleum Company J. H. McClure (Assignor)Address Bartlesville, Oklahoma Midland, Texas

AREA 640 ACRES

LOCATE WELL CORRECTLY

We propose to drill well with drilling equipment as follows: Drill with rotary to depth sufficient to test the Devonian.The status of a bond for this well in conformance with Rule 39 of the General Rules and Regulations of the Commission is as follows: Blanket Bond

We propose to use the following strings of casing and to land or cement them as indicated:

Size of Hole	Size of Casing	Weight Per Foot	New or Second Hand	Depth	Landed or Cemented	Sacks Cement
<u>17-1/4</u>	<u>13-3/8</u>	<u>27.3#</u>	<u>new</u>	<u>300'</u>	<u>cemented</u>	<u>circulate</u>
<u>11"</u>	<u>8-5/8</u>	<u>28 & 32#</u>	<u>new</u>	<u>4800</u>	<u>cemented</u>	<u>circulate</u>
<u>7-7/8"</u>	<u>5-1/2</u>	<u>17 & 20#</u>	<u>new</u>	<u>11500</u>	<u>cemented</u>	<u>sufficient cement to tie in base of 8-5/8"</u>

If changes in the above plan become advisable we will notify you before cementing or landing casing. We estimate that the first productive oil or gas sand should occur at a depth of about 11500 feet.

Additional information:

Approved

except as follows:

MAR 21 1951

19

By

Title

OIL CONSERVATION COMMISSION,

Oil & Gas Inspector

Sincerely yours,

Phillips Petroleum Company

Company or Operator

By

Position Asst. Chief Clerk

Send communications regarding well to

Name Mr. C. P. Dimit - Vice-PresidentAddress Bartlesville, Oklahoma

This well will be located for #4
Denton - Phase 4
C-101 on Phillips
Denton #4
Filed 4-25-51
11-19-51

Telephone Phillips
Dec. 20-51

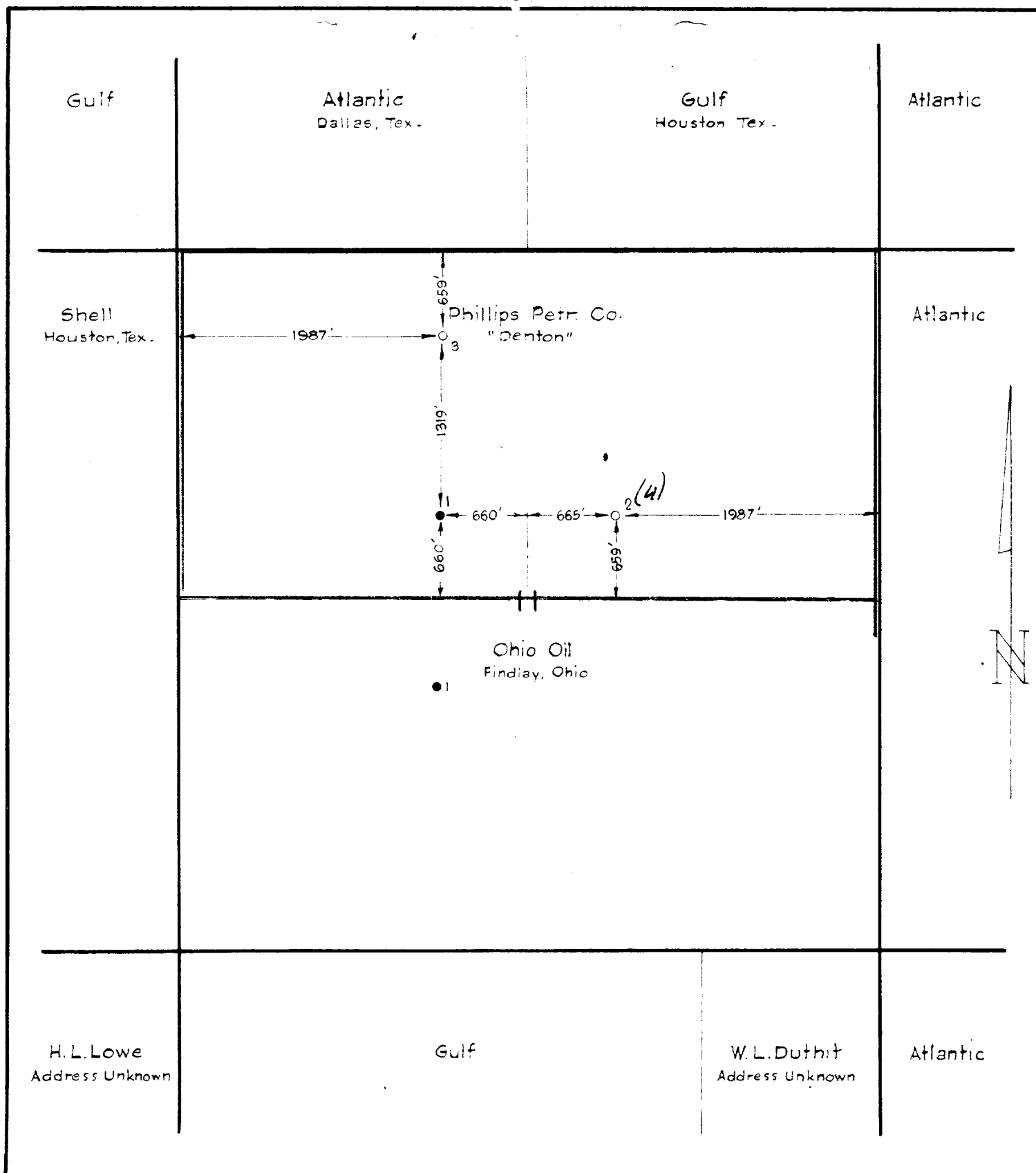

PHILLIPS PETROLEUM CO. BARTLESVILLE, OKLA.

DENTON LEASE-320.0 ACRES
N- $\frac{1}{2}$ OF SEC. II, TWP. 15 S. R. 37 E.
LEA CO. NEW MEXICO