

RECEIVED

DEC 10 1951

OIL CONSERVATION COMMISSION
HOBBS-OFFICENEW MEXICO OIL CONSERVATION COMMISSION
NOTICE OF INTENTION TO DRILL

See Rules 101 and 1104.

If changes in the proposed plan are considered advisable, a copy of this notice showing such changes will be returned to the sender. Submit this notice in triplicate. One copy will be returned following approval.

Bartlesville, Oklahoma

December 5, 1951

Place

Date

Notice hereby is given that it is our intention to commence the drilling of a well to be known as

Phillips Petroleum Company

Denton

11

NW/4 NE/4

Company or Operator

Lease

Denton Wolfcamp

Lea

County.

of Sec. 11, T. 15-S, R. 37-E, N. M., P. M., well No. 11 in 1837 feet from

The well is 659 feet from (N.) line and 1837 feet from (E.) line of the above section.

(Give location from section lines. Cross out wrong directions.)

If state land the oil and gas lease is No. James M. Denton Assignment No.

If patented land the owner is Brownfield, Texas

Address

If government land the permittee is

Address Phillips Petroleum Company J. H. McClure (Assignor)

The lessee is Bartlesville, Oklahoma Midland, Texas

Address Drill with rotary

We propose to drill well with drilling equipment as follows:

to depth sufficient to test Wolfcamp

The status of a bond for this well in conformance with Rule 101 of the General Rules and Regulations of the Commission is as follows: Blanket Bond

We propose to use the following strings of casing and to land or cement them as indicated:

Size of Hole	Size of Casing	Weight Per Foot	New or Second Hand	Depth	Landed or Cemented	Sacks Cement
17 1/4"	13 3/8"	27.3#	New	300'	Cemented	Circulate
11"	8 5/8"	28 and 32#	New	4800'	Cemented	Circulate
7 7/8"	5 1/2"	17 and 20#	New	9700'	Cemented	Sufficient cement to tie in base of 8 5/8".

If changes in the above plans become advisable we will notify you before cementing or landing casing. We estimate that the first productive oil or gas sand should occur at a depth of about 9700 feet.

Additional information:

DEC 10 1951

Approved _____, 19.

except as follows:

PHILLIPS PETROLEUM COMPANY

Company or Operator

By

R. D. Pulsifer
Asst. Chief Clerk

Position

Send communications regarding well to:

Mr. C. P. Dimit, Vice President

Name

Phillips Building

Address

Bartlesville, Oklahoma

OIL CONSERVATION COMMISSION,

By

Title

Roy Yarbrough
Oil & Gas Inspector

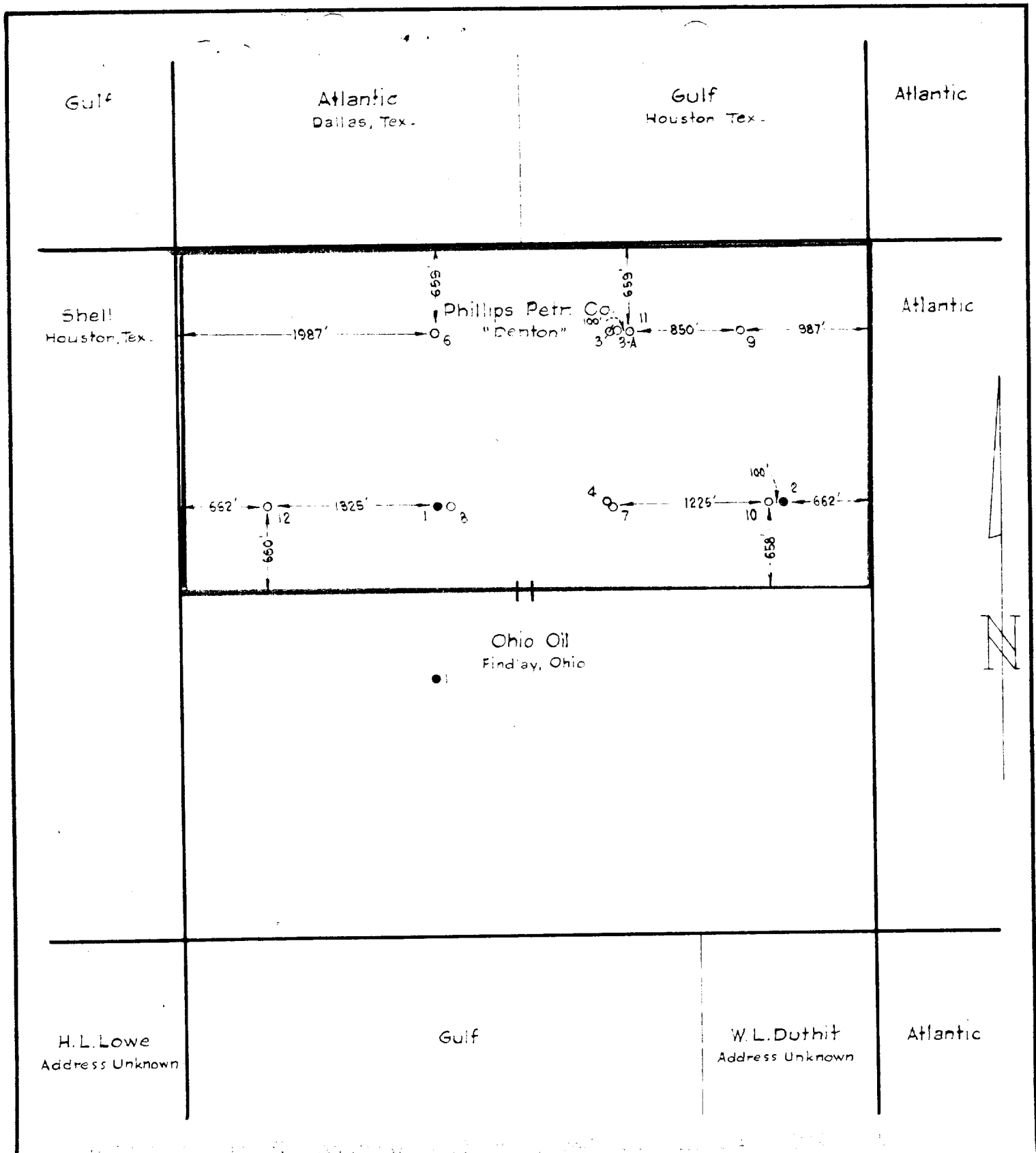

PHILLIPS PETROLEUM CO. BARTLESVILLE, OKLA.

DENTON LEASE-320.0 ACRES
 N. $\frac{1}{2}$ OF SEC. 11, TWP. 15 S. R. 37 E.
 LEA CO. NEW MEXICO

DRAWN BY: R.E.V.

8-28-50

SCALE 1"=1000'

CONTRACT NO.

DRAWING NO.

I,.....R. L. Pulsifer....., being first duly sworn on oath, state that I have knowledge of the facts and matter herein set forth on this plat and that the same are true and correct.

Name.....R. L. Pulsifer....., Title, Asst. Chief Clerk.....'

Subscribed and sworn to before me thisday of....., 19....

Notary Public Washington..... County, Okla.....

My Commission Expires Aug. 1, 1902

RAY E. HULING