

**NEW MEXICO
OIL CONSERVATION COMMISSION**
HOBBS OFFICE OCC

Form C-128

Well Location and/or Gas Proration Plat

1956 NOV 30 PM 12:48

Date November 19, 1956

Operator Magnolia Petroleum Company Lease Anderson Estate

Well No. One (1) Section 5 Township 16 S Range 37 E NMPM

Located 660 Feet From North Line, 660 Feet From West Line,

Lea County, New Mexico. G. L. Elevation _____

Name of Producing Formation Pennsylvanian Pool Dean Dedicated Acreage 91.75

(Note: All distances must be from outer boundaries of Section)

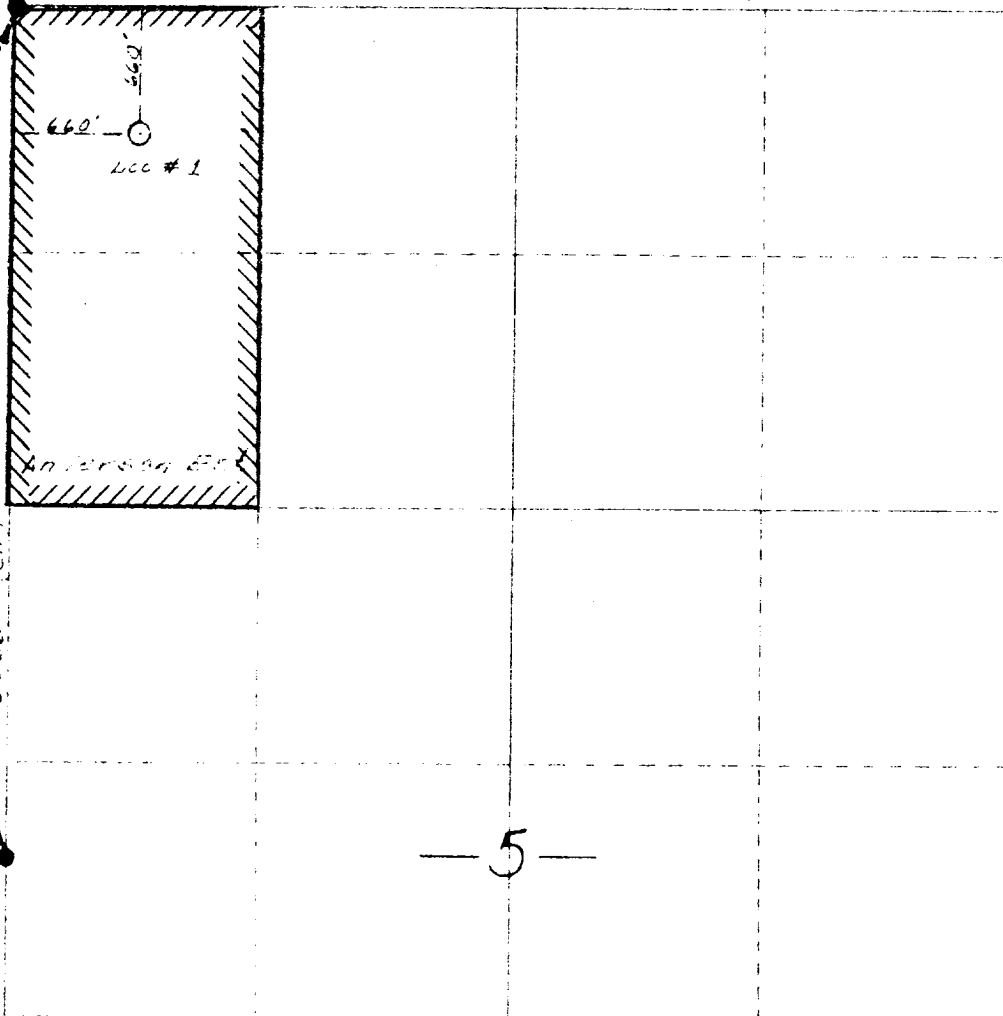

Scale: 1" = 1000'

LEGEND

Lease
Boundary

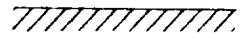

1. Is this Well a Dual Comp.? Yes _____ No. X

2. If the answer to Question 1 is yes, are there any other dually completed wells within the dedicated acreage?

Yes _____ No _____

Name E. B. Blundell
Position District Superintendent
Representing Magnolia Petroleum Company
Address Box 727, Kermit, Texas

This is to certify that the above plat was prepared from field notes of actual surveys made by me or under my supervision and that the same are true and correct to the best of my knowledge and belief.

Date Surveyed June 3, 1955

W. D. Gule
Registered Professional Engineer and/or Land Surveyor
#1115