

Form 9-331a
(Feb. 1951)

(SUBMIT IN TRIPLICATE)

Land Office Las Cruces
Lease No. 029406 (b)
Unit Lease

UNITED STATES
DEPARTMENT OF THE INTERIOR
GEOLOGICAL SURVEY

1962 JUN 25 AM 7:15

JUN 22 1962

SUNDRY NOTICES AND REPORTS ON WELLS

S. C. C.
ARTESIA, OFFICE

NOTICE OF INTENTION TO DRILL	<input checked="" type="checkbox"/>	SUBSEQUENT REPORT OF WATER SHUT-OFF	
NOTICE OF INTENTION TO CHANGE PLANS		SUBSEQUENT REPORT OF SHOOTING OR ACIDIZING	
NOTICE OF INTENTION TO TEST WATER SHUT-OFF		SUBSEQUENT REPORT OF ALTERING CASING	
NOTICE OF INTENTION TO RE-DRILL OR REPAIR WELL		SUBSEQUENT REPORT OF RE-DRILLING OR REPAIR	
NOTICE OF INTENTION TO SHOOT OR ACIDIZE		SUBSEQUENT REPORT OF ABANDONMENT	
NOTICE OF INTENTION TO PULL OR ALTER CASING		SUPPLEMENTARY WELL HISTORY	
NOTICE OF INTENTION TO ABANDON WELL			

(INDICATE ABOVE BY CHECK MARK NATURE OF REPORT, NOTICE, OR OTHER DATA)

June 14, 1962

Grace Mitchell "B"

Well No. 6 is located 1980 ft. from N line and 1980 ft. from E line of sec. 5

NE 1/4 of SE 1/4 Sec. 5 17 32 N 41° W

Malpais Lea New Mexico
(Field) (County or Subdivision) (State or Territory)

The elevation of the derrick floor above sea level is _____ ft.

DETAILS OF WORK

(State names of and expected depths to objective sands; show sizes, weights, and lengths of proposed casings; indicate mudding jobs, cementing points, and all other important proposed work)

It is our intention to drill a well at the above location to an approximate depth of 4125' to attempt a completion in the Grayburg-San Andres horizon. All casing points will be cemented in accordance with approved methods of the USGS, and any special requirements will be complied with.

It is planned to use the following casing pattern: 11" hole, 7 5/8" casing to be set at 950' and cemented with 475 sacks. Cement is to circulate. 6 3/4" hole, 4 1/2" casing to be set at 3900' and cemented with 225 sacks. Cement is to return to 1950'.

Permission is requested to produce this well upon completion.

Verbal approval granted 6-15-62.

I understand that this plan of work must receive approval in writing by the Geological Survey before operations may be commenced.

Company Continental Oil Company

Address Box 127

Hobbs, New Mexico

RECEIVED
JUN 18 1962
GEOLOGICAL SURVEY
ARTESIA, NEW MEXICO

By J. A. Green
Title Assistant District Superintendent

USGS (3) NMOSC (2) WAM File

NEW MEXICO OIL CONSERVATION COMMISSION
WELL LOCATION AND ACREAGE DEDICATION PLAT

FORM C-128
Revised 5/1/57

SEE INSTRUCTIONS FOR COMPLETING THIS FORM ON THE REVERSE SIDE

SECTION A

1952 JUN 25 AM 7:16

Operator

Lease

Well No.

CONTINENTAL OIL COMPANY

GRACE MITCHELL "B"

6

Unit Letter

Section

Township

Range

County

J

5

17 SOUTH

32 EAST

LEA

Actual Footage Location of Well:

1980

feet from the

SOUTH

line and

1980

feet from the

EAST

line

Ground Level Elev.

Producing Formation

Pool

Dedicated Acreage:

Grayburg-San Andres

Maljamar

10

Acres

1. Is the Operator the only owner in the dedicated acreage outlined on the plat below? YES ☒ NO ☐ ("Owner" means the person who has the right to drill into and to produce from any pool and to appropriate the production either for himself or for himself and another. (65-3-29 (a) NMSA 1935 Comp.)
2. If the answer to question one is "no," have the interests of all the owners been consolidated by communitization agreement or otherwise? YES ☐ NO ☐ If answer is "yes," Type of Consolidation _____
3. If the answer to question two is "no," list all the owners and their respective interests below:

Owner

Land Description

SECTION B

CERTIFICATION

I hereby certify that the information in SECTION A above is true and complete to the best of my knowledge and belief.

Name

Position

Asst. District Superintendent

Company

Continental Oil Company

Date

June 15, 1962

I hereby certify that the well location shown on the plat in SECTION B was plotted from field notes of actual surveys made by me or under my supervision, and that the same is true and correct to the best of my knowledge and belief.

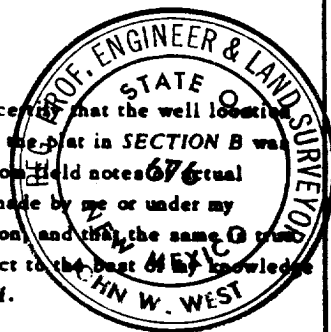

Date Surveyed

6-14-62

Registered Professional Engineer and/or Land Surveyor, JOHN W. WEST

John W. West

Certificate No.

N.M. - P.E. & L.S. NO. 676

0 330 660 990 1320 1650 1980 2310 2640 2000 1500 1000 500 0