

COPY TO O. C. C.

Budget Bureau No. 42-R158.4
Approval expires 12-31-60.

(SUBMIT IN TRIPLICATE)

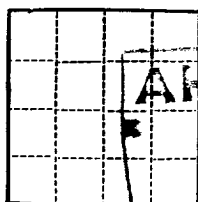

UNITED STATES
DEPARTMENT OF THE INTERIOR
MAR 6 1959
GEOLOGICAL SURVEY

Land Office Las Cruces
Lease No. 029405 b
Unit Lease

SUNDRY NOTICES AND REPORTS ON WELLS

NOTICE OF INTENTION TO DRILL	<input checked="" type="checkbox"/>	SUBSEQUENT REPORT OF WATER SHUT-OFF	
NOTICE OF INTENTION TO CHANGE PLANS		SUBSEQUENT REPORT OF SHOOTING OR ACIDIZING	
NOTICE OF INTENTION TO TEST WATER SHUT-OFF		SUBSEQUENT REPORT OF ALTERING CASING	
NOTICE OF INTENTION TO RE-DRILL OR REPAIR WELL		SUBSEQUENT REPORT OF RE-DRILLING OR REPAIR	
NOTICE OF INTENTION TO SHOOT OR ACIDIZE		SUBSEQUENT REPORT OF ABANDONMENT	
NOTICE OF INTENTION TO PULL OR ALTER CASING		SUPPLEMENTARY WELL HISTORY	
NOTICE OF INTENTION TO ABANDON WELL			

(INDICATE ABOVE BY CHECK MARK NATURE OF REPORT, NOTICE, OR OTHER DATA)

Mitchell B No. 28March 6, 1959Well No. 28 is located 1200 ft. from S line and 1030 ft. from E line of sec. 20N4 1/4 S4 1/4 Section 20
(1/4 Sec. and Sec. No.)17
(Twp.)32
(Range)N. M. P. M.
(Meridian)Wildcat
(Field)Lea
(County or Subdivision)New Mexico
(State or Territory)

RECEIVED
MAR 6 1959
U. S. GEOLOGICAL SURVEY
ARTESIA, NEW MEXICO

The elevation of the derrick floor above sea level is _____ ft.

DETAILS OF WORK

(State names of and expected depths to objective sands; show sizes, weights, and lengths of proposed casings; indicate mudding jobs, cementing points, and all other important proposed work)

It is our intention to drill a well with rotary tools at the above location to a total depth of approximately 14,000'. All casing points will be cemented in accordance with approved methods of the U. S. Geological Survey and any other special requirements will be complied with.

It is planned to use the following casing pattern: 13 3/8" casing to be set at approximately 400' and cemented with 350 sacks, cement to be circulated. 9 5/8" casing to be set at approximately 4700' and cemented with 2300 sacks, cement to return to surface casing. 7" casing to be set at 14,000' and cemented with 500 cubic feet of Trinity Inferno with 100 sacks neat around shoe.

Approval to produce this well upon completion is also requested.

I understand that this plan of work must receive approval in writing by the Geological Survey before operations may be commenced.

Company Continental Oil CompanyAddress Howley BuildingArtesia, New MexicoBy [Signature]Title District SuperintendentSo do plot

SECRET

CONFIDENTIAL

TOP SECRET

NEW MEXICO OIL CONSERVATION COMMISSION
WELL LOCATION AND ACREAGE DEDICATION PLAT

FORM C-128
Revised 5-1-57

SEE INSTRUCTIONS FOR COMPLETING THIS FORM ON THE REVERSE SIDE

SECTION A

Operator Continental Oil Co.		Lease Mitchell		Well No. 28	
Unit Letter J	Section 20	Township 17 S	Range 32 E	County Lea	
Actual Footage Location of Well: 1980 feet from the South line and 1830 feet from the East line					
Ground Level Elev. 3988.0	Producing Formation Devonian Test		Pool Wildcat		Dedicated Acreage: 80 Acres

1. Is the Operator the only owner in the dedicated acreage outlined on the plat below? YES ☒ NO ☐ "Owner" means the person who has the right to drill into and to produce from any pool and to appropriate the production either for himself or for himself and another. (65-3-29 (e) NMSA 1933 (Comp.))
2. If the answer to question one is "no," have the interests of all the owners been consolidated by communitization agreement or otherwise? YES ☐ NO ☐ If answer is "yes," Type of Consolidation _____
3. If the answer to question two is "no," list all the owners and their respective interests below:

Owner	Land Description

RECEIVED
MAR 6 1959
U. S. GEOLOGICAL SURVEY
ARTESIA, NEW MEXICO

SECTION B

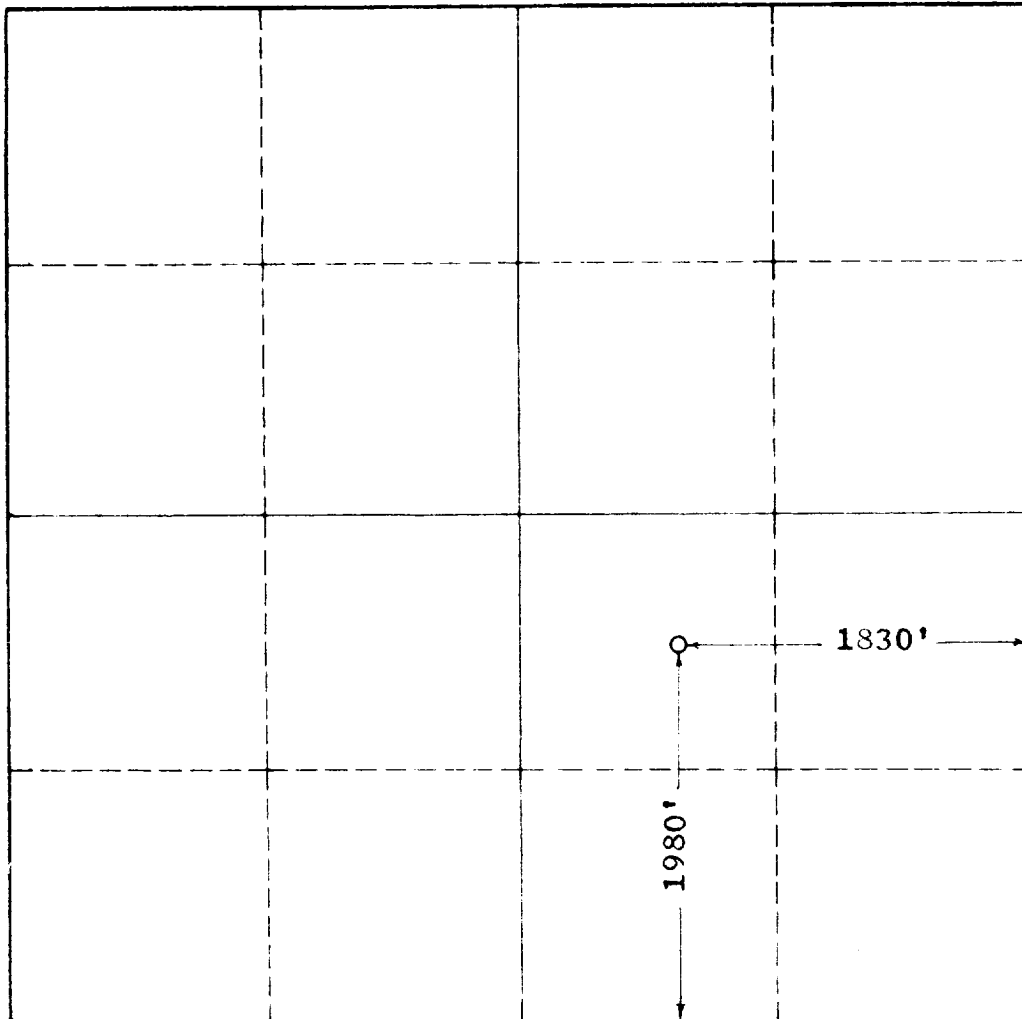

0 330 660 990 1320 1650 1980 2310 2640 2000 1500 1000 500 0

CERTIFICATION

I hereby certify that the information in SECTION A above is true and complete to the best of my knowledge and belief.

Name Wm. A. Mead
Position District Superintendent
Company Continental Oil Company
Date March 6, 1959

I hereby certify that the well location shown on the plat in SECTION B was plotted from field notes of actual surveys made by me or under my supervision, and that the same is true and correct to the best of my knowledge and belief.

Date Surveyed 1-13-59
Registered Professional Engineer and/or Land Surveyor, JOHN W WEST
Certificate No. N.M. P.E. & L.S. NO. 676