

NEW MEXICO
OIL CONSERVATION COMMISSION

Form C-128

Well Location and/or Gas Proration Plat

Date April 4, 1956

Operator Shell Oil Company Lease 1956 APR 10 10:33 AM

Well No. 6 Section 8 Township -16-S Range -35-E NMPM

Located 660 Feet From South Line, 2210 Feet From West Line,

Lea County, New Mexico. G. L. Elevation

Name of Producing Formation Wolfcamp Pool Townsend-Wolfcamp Dedicated Acreage 40

(Note: All distances must be from outer boundaries of Section)

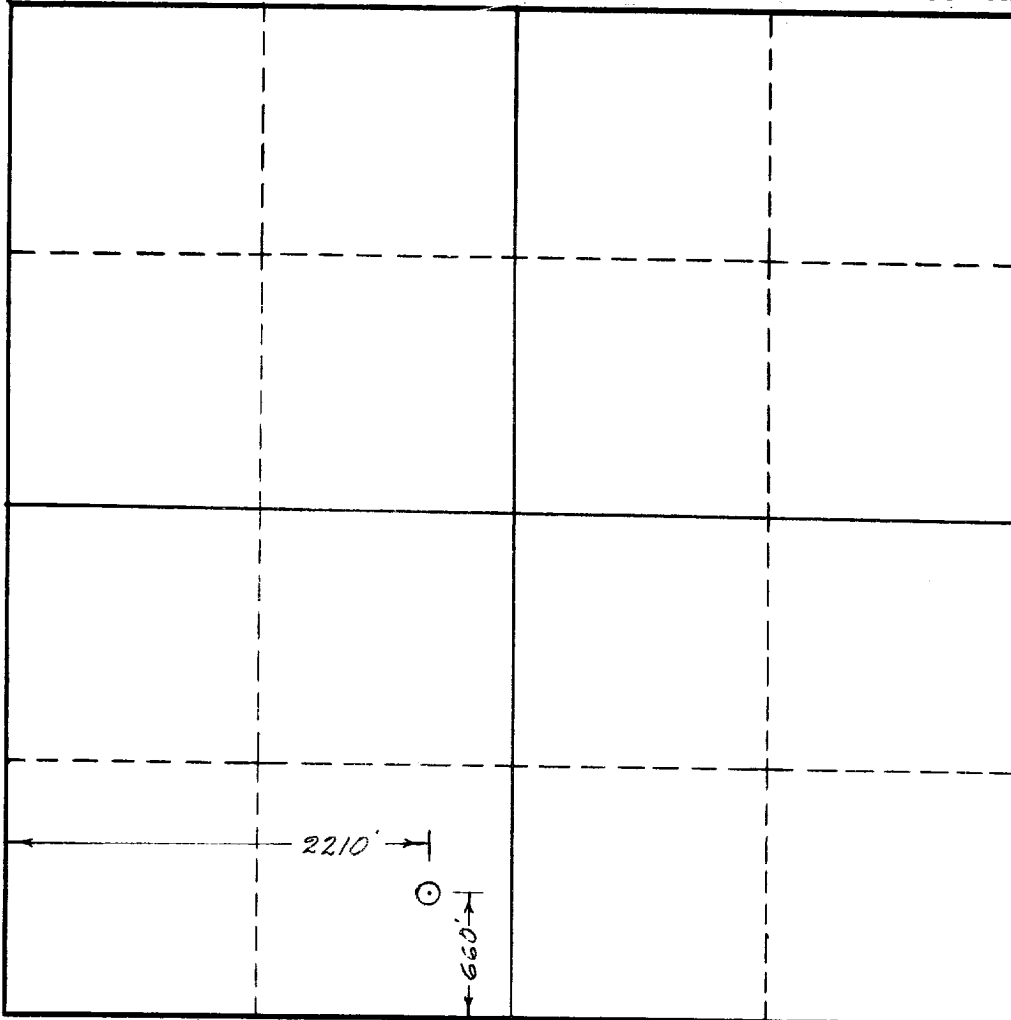

SCALE: 1"=1000'

1. Is this Well a Dual Comp. ? Yes No x
2. If the answer to Question 1 is yes, are there any other dually completed wells within the dedicated acreage? Yes No

This is to certify that the above plat was prepared from field notes of actual surveys made by me or under my supervision and that the same are true and correct to the best of my knowledge and belief.

Name B. Nevill Original signed by B. Nevill
Position Division Exploitation Engineer
Representing Shell Oil Company
Address Box 1957, Hobbs, New Mexico

Date Surveyed April 4, 1956
Neal D. Shepard N.M. Cert. #1467
Registered Professional Engineer and/or
Land Surveyor
Neal D. Shepard, N. M. Cert. No. 1467