

District I  
PO Box 1980, Hobbs, NM 88241-1980  
District II  
811 South First, Artesia, NM 88210  
District III  
1000 Rio Brazos Rd., Aztec, NM 87410  
District IV  
2040 South Pacheco, Santa Fe, NM 87505

State of New Mexico  
Energy, Minerals & Natural Resources Department

OIL CONSERVATION DIVISION  
2040 South Pacheco  
Santa Fe, NM 87505

Form C-101  
Revised October 18, 1994  
Instructions on back  
Submit to Appropriate District Office  
State Lease - 6 Copies  
Fee Lease - 5 Copies

☐ AMENDED REPORT

APPLICATION FOR PERMIT TO DRILL, RE-ENTER, DEEPEN, PLUGBACK, OR ADD A ZONE

<sup>1</sup> Operator Name and Address. <b>Yates Petroleum Corporation</b> 105 S. 4th Street Artesia, New Mexico 88210		<sup>2</sup> OGRID Number 025575
		<sup>3</sup> API Number 30-025-08578
<sup>4</sup> Property Code 23153	<sup>5</sup> Property Name Simmons Witt ASL	<sup>6</sup> Well No. 1

<sup>7</sup> Surface Location

UL or lot no.	Section	Township	Range	Lot Ida	Feet from the	North/South line	Feet from the	East/West line	County
J	11	16S	35E		2310'	South	2080'	East	Lea

<sup>8</sup> Proposed Bottom Hole Location If Different From Surface

UL or lot no.	Section	Township	Range	Lot Ida	Feet from the	North/South line	Feet from the	East/West line	County
<sup>9</sup> Proposed Pool 1 Townsend Morrow					<sup>10</sup> Proposed Pool 2				

<sup>11</sup> Work Type Code E & D	<sup>12</sup> Well Type Code G	<sup>13</sup> Cable/Rotary R	<sup>14</sup> Lease Type Code P	<sup>15</sup> Ground Level Elevation 3980'
<sup>16</sup> Multiple No	<sup>17</sup> Proposed Depth 12,500'	<sup>18</sup> Formation Morrow	<sup>19</sup> Contractor Undesignated	<sup>20</sup> Spud Date ASAP

<sup>21</sup> Proposed Casing and Cement Program

Hole Size	Casing Size	Casing weight/foot	Setting Depth	Sacks of Cement	Estimated TOC
17 1/2"	13 3/8"	48#	363' In Place	250 sacks	Circulate
11"	8 5/8"	32#	596'-4675' "	600 sacks	600'
11"	8 5/8"	32#	0-596'	1050 sacks	Circulate
7 7/8"	5 1/2"	15# & 17#	TD	1350 sacks	As Warranted

<sup>22</sup> Describe the proposed program. If this application is to DEEPEN or PLUG BACK give the data on the present productive zone and proposed new productive zone. Describe the blowout prevention program, if any. Use additional sheets if necessary.  
Yates Petroleum Corporation proposes to re-enter this well which was originally drilled by J.E. Simmons as the Witt #1. We will drill out the surface plug and plugs across the 13 3/8" and 8 5/8" casing. Dress the top off and patch in 8 5/8" casing. Clean out the plug at the bottom of the 8 5/8" casing. Clean out to the bottom of the original hole and deepen the well to a new TD of 12,500' to test the Morrow and the intermediate formations. If commercial, will run 5 1/2" casing to TD and cement with adequate cover, perforate and stimulate as needed to gain production.  
MUD PROGRAM: Native Mud 0-596'; Cut Brine/Starch 596'-10718'; 10818'-TD Salt Gel/starch.  
BOPE PROGRAM:: A 5000 PSI BOP system will be nipped up on the 8 5/8" casing.

<sup>23</sup> I hereby certify that the information given above is true and complete to the best of my knowledge and belief.

Signature: *Clifton R. May*

Printed name: CLIFTON R. MAY

Title: REGULATORY AGENT

Date: March 16, 1998

Phone: 505-748-4347

OIL CONSERVATION DIVISION

Approved by: *Chris Williams*  
DISTRICT SUPERVISOR

Title:

Approved Date: 3/13/1998

Expiration Date:

Conditions of Approval:  
Attached ☐

Permit Expires 1 Year From Approval  
Data Unless Indicated Otherwise  
Re-Entry

District I  
PO Box 1980, Hobbs, NM 88241-1980  
District II  
PO Drawer DD, Artesia, NM 88211-0719  
District III  
1000 Rio Brazos Rd., Aztec, NM 87410  
District IV  
PO Box 2088, Santa Fe, NM 87504-2088

State of New Mexico  
Energy, Minerals & Natural Resources Department

OIL CONSERVATION DIVISION  
PO Box 2088  
Santa Fe, NM 87504-2088

Form C-102  
Revised February 10, 1994  
Instructions on back  
Submit to Appropriate District Office  
State Lease - 4 Copies  
Fee Lease - 3 Copies

☐ AMENDED REPORT

WELL LOCATION AND ACREAGE DEDICATION PLAT

1 API Number 30-025-08528		2 Pool Code 86400		3 Pool Name Townsend Morrow	
4 Property Code 23153		5 Property Name Simmons Witt ASL			6 Well Number 1
7 OGRID No. 025575		8 Operator Name YATES PETROLEUM CORPORATION			9 Elevation 3980'

10 Surface Location

UL or lot no. J	Section 11	Township 16S	Range 35E	Lot Idn	Feet from the 2310'	North/South line South	Feet from the 2080'	East/West line East	County Lea
--------------------	---------------	-----------------	--------------	---------	------------------------	---------------------------	------------------------	------------------------	---------------

11 Bottom Hole Location If Different From Surface

UL or lot no.	Section	Township	Range	Lot Idn	Feet from the	North/South line	Feet from the	East/West line	County
12 Dedicated Acres 320		13 Joint or Infill		14 Consolidation Code		15 Order No.			

NO ALLOWABLE WILL BE ASSIGNED TO THIS COMPLETION UNTIL ALL INTERESTS HAVE BEEN CONSOLIDATED  
OR A NON-STANDARD UNIT HAS BEEN APPROVED BY THE DIVISION

16						17 OPERATOR CERTIFICATION	
						I hereby certify that the information contained herein is true and complete to the best of my knowledge and belief	
						Signature Clifton R. May	
						Printed Name Clifton R. May	
						Title Regulatory Agent	
						Date March 16, 1998	
						18 SURVEYOR CERTIFICATION	
						I hereby certify that the well location shown on this plat was plotted from field notes of actual surveys made by me or under my supervision, and that the same is true and correct to the best of my belief.	
						Date of Survey	
						Signature and Seal of Professional Surveyor:	
						REFER TO ORIGINAL PLAT	
						Certificate Number	

# WELL LOCATION SURVEY PLAT

OPERATOR J E SIMMONS

LEASE WITT

WELL NO. 1

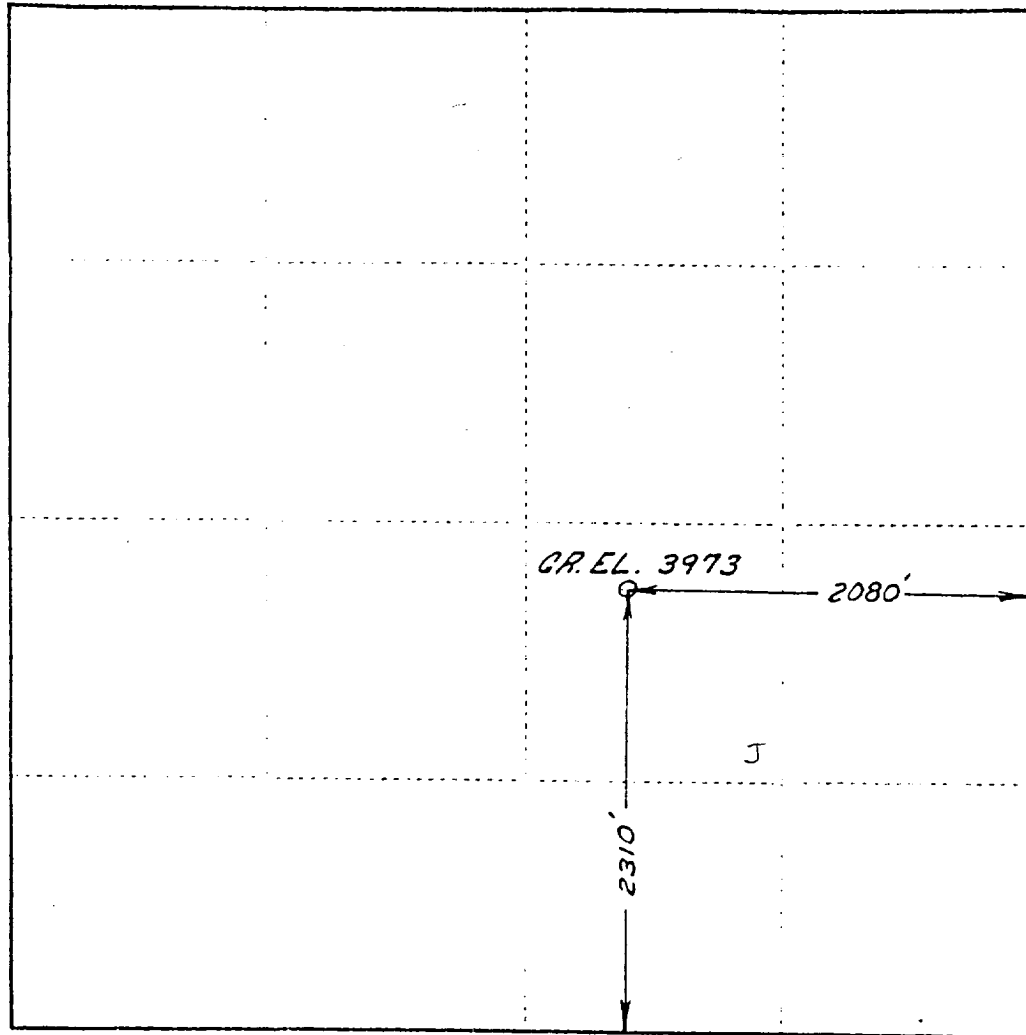

SEC. 11, TWP. 16 S., RGE. 35 E., N.M.P.M.

I HEREBY CERTIFY THAT THIS PLAT WAS MADE  
FROM NOTES TAKEN IN THE FIELD BY ME AND  
THAT THE SAME IS TRUE AND CORRECT TO THE  
BEST OF MY KNOWLEDGE AND BELIEF.

*John W. West*

# YATES PETROLEUM CORPORATION

## TYPICAL 5,000 p.s.i. BLOWOUT PREVENTER & CHOKE MANIFOLD SCHEMATIC

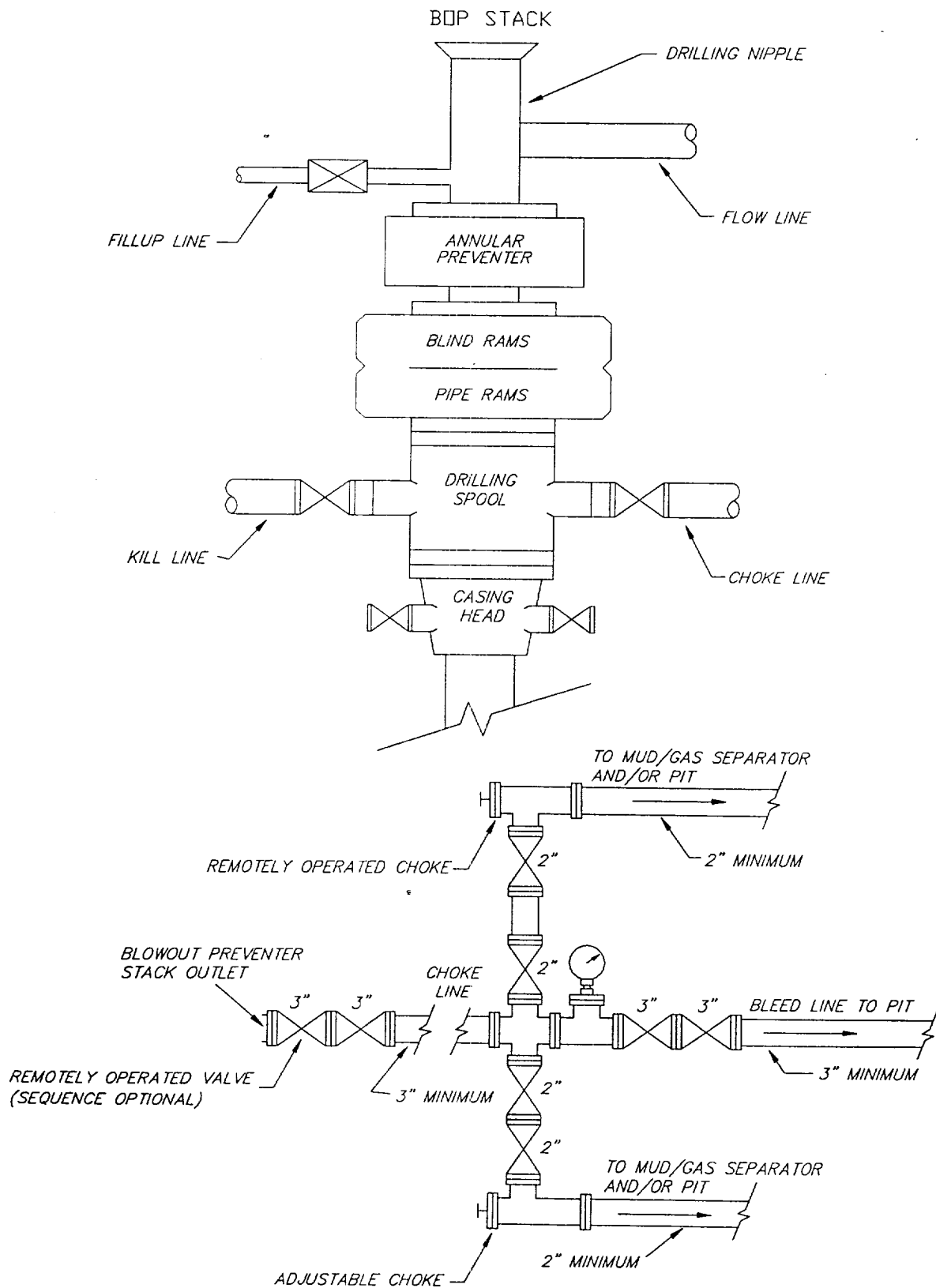

**NEW MEXICO ENERGY MINERALS AND NATURAL RESOURCES DEPT.  
OIL CONSERVATION DIVISION  
DISTRICT 1  
P.O. BOX 1980  
HOBBS, NM 88241  
(505)393-6161 FAX (505)393-0720**

April 13, 1998

Approval for re-entry and completion, but must have administrative approval for an unorthodox location before well can be produced.

Sincerely

A handwritten signature in cursive script that reads "Chris Williams".

Chris Williams  
District 1 Supervisor