

District I
PO Box 1980, Hobbs, NM 88241-1980
District II
PO Drawer DD, Artesia, NM 88211-0719
District III
1000 Rio Brazos Rd., Aztec, NM 87410
District IV
PO Box 2088, Santa Fe, NM 87504-2088

State of New Mexico
Energy, Minerals & Natural Resources Department

OIL CONSERVATION DIVISION
PO Box 2088
Santa Fe, NM 87504-2088

Form C-101
Revised February 10, 1994
Instructions on back
Submit to Appropriate District Office
State Lease - 6 Copies
Fee Lease - 5 Copies

☐ AMENDED REPORT

APPLICATION FOR PERMIT TO DRILL, RE-ENTER, DEEPEN, PLUGBACK, OR ADD A ZONE

¹ Operator Name and Address. YATES PETROLEUM CORPORATION 105 South Fourth Street Artesia, New Mexico 88210		¹ OGRID Number 025575
⁴ Property Code 19411	¹ Property Name Simmons Witt ANB Com.	¹ API Number 30 - 025575
		¹ Well No. #1

⁷ Surface Location									
UL or lot no.	Section	Township	Range	Lot Idn	Feet from the	North/South line	Feet from the	East/West line	County
J	11	16S	35E		2130	South	2080	East	Lea

⁸ Proposed Bottom Hole Location If Different From Surface									
UL or lot no.	Section	Township	Range	Lot Idn	Feet from the	North/South line	Feet from the	East/West line	County
⁹ Proposed Pool 1 Wildcat Morrow					¹⁰ Proposed Pool 2				

¹¹ Work Type Code E	¹² Well Type Code G	¹³ Cable/Rotary Rotary	¹⁴ Lease Type Code P	¹⁵ Ground Level Elevation 3973'
¹⁶ Multiple No	¹⁷ Proposed Depth 12500'	¹⁸ Formation Morrow	¹⁹ Contractor Undesignated	²⁰ Spud Date Sept. 1996

²¹ Proposed Casing and Cement Program					
Hole Size	Casing Size	Casing weight/foot	Setting Depth	Sacks of Cement	Estimated TOC
17 1/2"	13 3/8"	48#	363'-in place	250 sacks	Circulate
11"	8 5/8"	32#	596' to 4675' in place	600 sacks	600'
11"	8 5/8"	32#	0 - 596'	1050 sacks	Circulate
7 7/8"	5 1/2"	15.5# & 17#	TD	1350 sacks	As warranted

²² Describe the proposed program. If this application is to DEEPEN or PLUG BACK give the data on the present productive zone and proposed new productive zone. Describe the blowout prevention program, if any. Use additional sheets if necessary.
Yates Petroleum Corporation plans to re-enter this well that was drilled by J.E. Simmons as the Witt #1 by drilling out the surface plug. The plug across the 13 3/8" casing, and the plug across the top of the 8 5/8" casing. Dress the top off and patch in 8 5/8" casing. Clean out the plug at the bottom of the 8 5/8" casing. Clean out to the bottom of the original hole and then deepen the well to a new TD of 12,500' to test the Morrow and intermediate formations. If commercial, will run 5 1/2" casing to TD and cement with adequate cover, perforate and stimulate as needed to gain production.
MUD PROGRAM: Native from 0-596'; Cut Brine, Starch 596' to 10718'; and Salt Gel, Starch 10718' to TD
BOPE PROGRAM: A 5000 PSI system will be nipples up on 8 5/8" casing.

²³ I hereby certify that the information given above is true and complete to the best of my knowledge and belief.

Signature: *Clifton R. May*
Printed name: Clifton R. May
Title: Regulatory Agent
Date: 8-19-96
Phone: 505-748-1471

OIL CONSERVATION DIVISION	
Approved by: <i>[Signature]</i>	
Title: <i>[Signature]</i>	
Approval Date: <i>AUG 21 1996</i>	Expiration Date:
Conditions of Approval: Attached <input type="checkbox"/>	

Permit Expires 1 Year From Approval
Date of Issue: *[Signature]*

District I
PO Box 1980, Hobbs, NM 88241-1980
District II
PO Drawer DD, Artesia, NM 88211-0719
District III
1000 Rio Brazos Rd., Aztec, NM 87410
District IV
PO Box 2088, Santa Fe, NM 87504-2088

State of New Mexico
Energy, Minerals & Natural Resources Department

OIL CONSERVATION DIVISION
PO Box 2088
Santa Fe, NM 87504-2088

Form C-102
Revised February 10, 1994
Instructions on back
Submit to Appropriate District Office
State Lease - 4 Copies
Fee Lease - 3 Copies

☐ AMENDED REPORT

WELL LOCATION AND ACREAGE DEDICATION PLAT

1 API Number 8 025575		2 Pool Code 320		3 Pool Name Wildcat Morrow			
4 Property Code		5 Property Name Simmons Witt ANB Com.				6 Well Number #1	
7 OGRID No. 025575		8 Operator Name YATES PETROLEUM CORPORATION				9 Elevation 3973'	

10 Surface Location

UL or lot no.	Section	Township	Range	Lot Idn	Feet from the	North/South line	Feet from the	East/West line	County
J	11	16S	35E		2130' ^{230'}	South	2080'	East	Lea

11 Bottom Hole Location If Different From Surface

UL or lot no.	Section	Township	Range	Lot Idn	Feet from the	North/South line	Feet from the	East/West line	County

12 Dedicated Acres 320	13 Joint or Infill	14 Consolidation Code	15 Order No.
---------------------------	--------------------	-----------------------	--------------

NO ALLOWABLE WILL BE ASSIGNED TO THIS COMPLETION UNTIL ALL INTERESTS HAVE BEEN CONSOLIDATED
OR A NON-STANDARD UNIT HAS BEEN APPROVED BY THE DIVISION

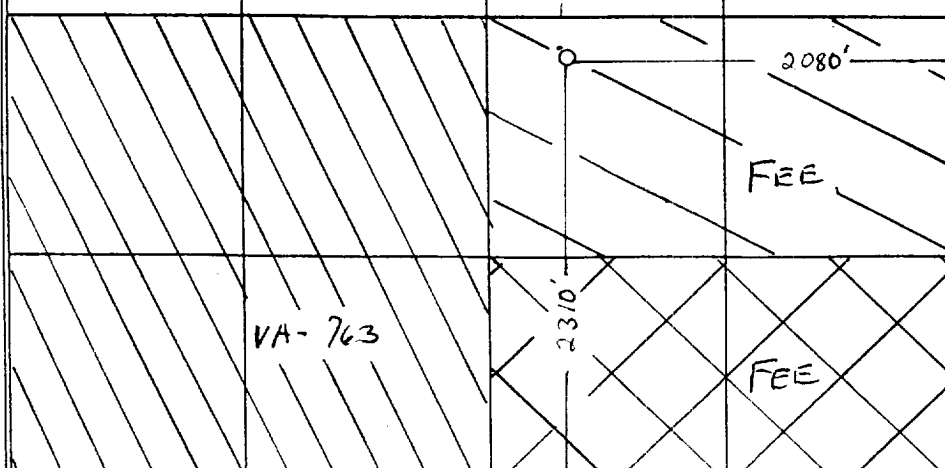
16					17 OPERATOR CERTIFICATION I hereby certify that the information contained herein is true and complete to the best of my knowledge and belief Signature Clifton R. May Printed Name Clifton R. May Title Regulatory Agent 8-19-95 Date
					18 SURVEYOR CERTIFICATION I hereby certify that the well location shown on this plat was plotted from field notes of actual surveys made by me or under my supervision, and that the same is true and correct to the best of my belief. Refer to Original Plat Date of Survey Signature and Seal of Professional Surveyer: Certificate Number

WELL LOCATION SURVEY PLAT

OPERATOR J E SIMMONS

LEASE WITT

WELL NO. 1

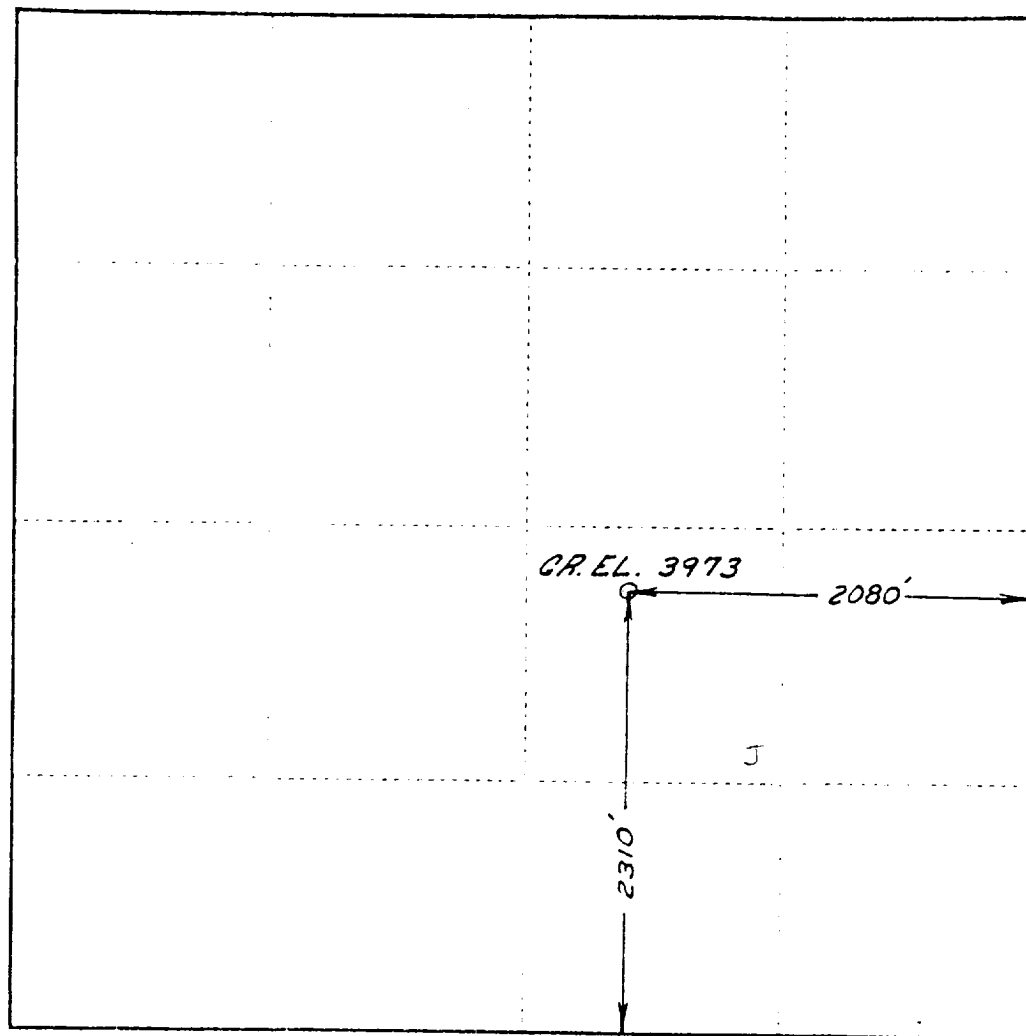

SEC. 11, TWP. 16 S., RGE. 35 E., N.M.P.M.

I HEREBY CERTIFY THAT THIS PLAT WAS MADE
FROM NOTES TAKEN IN THE FIELD BY ME AND
THAT THE SAME IS TRUE AND CORRECT TO THE
BEST OF MY KNOWLEDGE AND BELIEF.

John W. West

JOHN W. WEST, PE & LS NO. 676 DEC 6, 1955

YATES PETROLEUM CORPORATION

TYPICAL 5,000 p.s.i. BLOWOUT PREVENTER & CHOKE MANIFOLD SCHEMATIC

