

NEW MEXICO
OIL CONSERVATION COMMISSION

Form C-128

Well Location and/or Gas Proration Plat

Operator Shell Oil Company Lease State ETA Date July 18, 1956
Well No. 8 Section 8 Township 16-S Range 35-E NMPM
Located 1690 Feet From South Line, 1960 Feet From West Line,
Lea County, New Mexico. G. L. Elevation not available
Name of Producing Formation Wolfcamp Pool Townsend Dedicated Acreage 640

(Note: All distances must be from outer boundaries of Section)

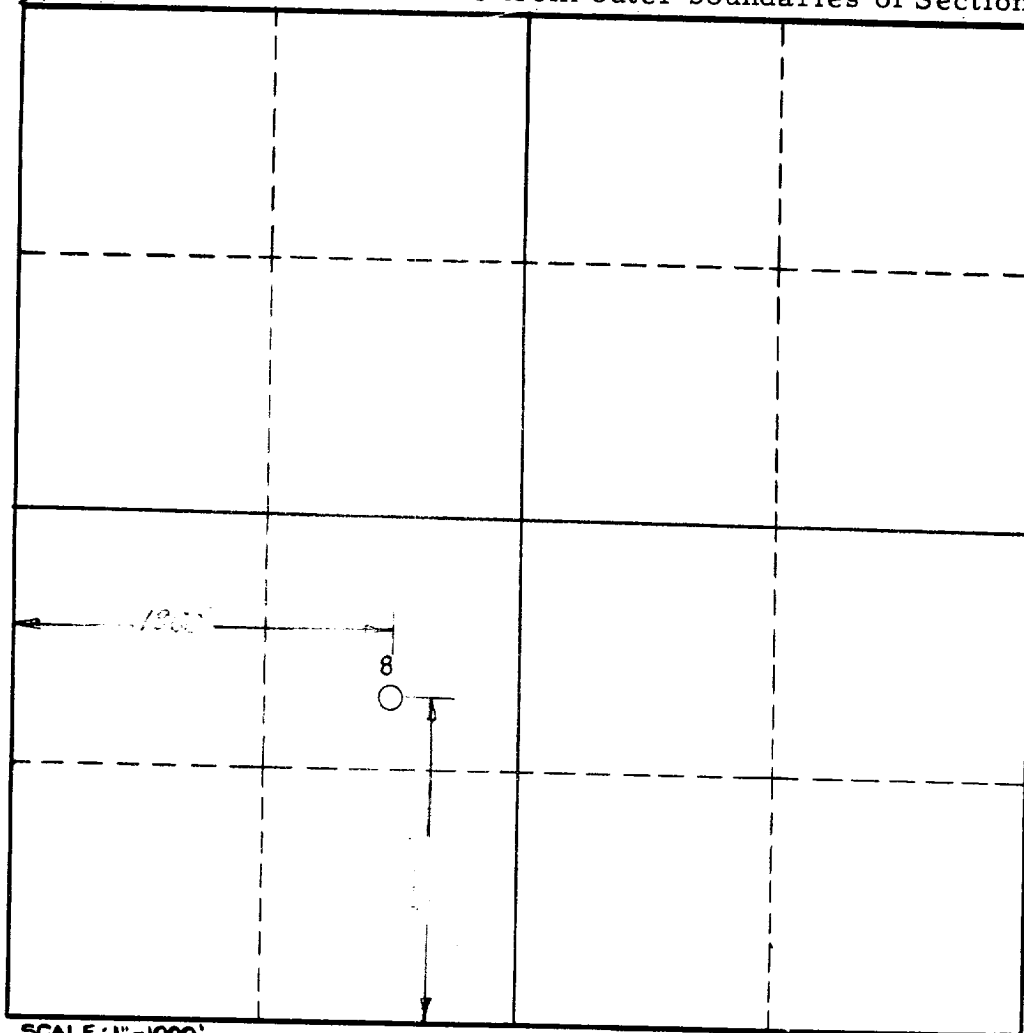

SCALE: 1"=1000'

1. Is this Well a Dual Comp.? Yes No X.
2. If the answer to Question 1 is yes, are there any other dually completed wells within the dedicated acreage? Yes No.

Name B. Nevill
Position Division Exploitation Engineer
Representing Shell Oil Company
Address Box 1957, Hobbs, New Mexico

This is to certify that the above plat was prepared from field notes of actual surveys made by me or under my supervision and that the same are true and correct to the best of my knowledge and belief.

Date Surveyed 7-18-56
Therrell Shepard Cert. # 1467
Registered Professional Engineer and/or Land Surveyor