

(SUBMIT IN TRIPLICATE)

UNITED STATES
DEPARTMENT OF THE INTERIOR
GEOLOGICAL SURVEYLand Office Las Cruces
Lease No. 029509 a
Unit Lease

SEP 26 1963

SUNDRY NOTICES AND REPORTS ON WELLS

HOBBS, NEW MEXICO

NOTICE OF INTENTION TO DRILL.....	<input checked="" type="checkbox"/>	SUBSEQUENT REPORT OF WATER SHUT-OFF.....	
NOTICE OF INTENTION TO CHANGE PLANS.....		SUBSEQUENT REPORT OF SHOOTING OR ACIDIZING.....	
NOTICE OF INTENTION TO TEST WATER SHUT-OFF.....		SUBSEQUENT REPORT OF ALTERING CASING.....	
NOTICE OF INTENTION TO RE-DRILL OR REPAIR WELL.....		SUBSEQUENT REPORT OF RE-DRILLING OR REPAIR.....	
NOTICE OF INTENTION TO SHOOT OR ACIDIZE.....		SUBSEQUENT REPORT OF ABANDONMENT.....	
NOTICE OF INTENTION TO PULL OR ALTER CASING.....		SUPPLEMENTARY WELL HISTORY.....	
NOTICE OF INTENTION TO ABANDON WELL.....			

(INDICATE ABOVE BY CHECK MARK NATURE OF REPORT, NOTICE, OR OTHER DATA)

Fresh Water September 24, 1963

Well No. 11 is located 330 ft. from [N] line and 2310 ft. from [E] line of sec. 21W 1/4 of NE 1/4 Sec. 21 17S 32E NORTH
(1/4 Sec. and Sec. No.) (Twp.) (Range) (Meridian)
Baish Lea New Mexico
(Field) (County or Subdivision) (State or Territory)The elevation of the derrick floor above sea level is NA ft.

DETAILS OF WORK

(State names of and expected depths to objective sands; show sizes, weights, and lengths of proposed casings; indicate mudding jobs, cementing points, and all other important proposed work)

It is our intention to drill a well at the above location to an approximate depth of 2,400' to complete as a water injection well in the Yates Formation. All casing joints will be cemented in accordance with approved methods of the U.S.G.S. and any special requirements will be complied with. It is planned to use the following casing pattern: 11" hole, 7 5/8" casing to be set at 250' and cemented with 130 sacks cement. Cement is to circulate. 5 1/2" hole, 4 7/8" tubing to be set at 2,400' and cemented with 360 sacks cement. Cement is to return to 2,150'.

This well is to be drilled for use as a water injection well in conjunction with the Baish-Yates Waterflood. Permission is requested to use this well as a water injection well upon completion.

I understand that this plan of work must receive approval in writing by the Geological Survey before operations may be commenced.

Company Continental Oil CompanyAddress Box 160Artes, New MexicoBy J. G. JonesTitle Asst. Dist. Superintendent

UPON-ROBEY (1) THOMAS-LOVELL (2) APS FILE

NEW MEXICO OIL CONSERVATION COMMISSION
WELL LOCATION AND ACREAGE DEDICATION PLAT

FORM C-120
Revised 9/1/57

SEE INSTRUCTIONS FOR COMPLETING THIS FORM ON REVERSE SIDE

SECTION A

Operator CONTINENTAL OIL COMPANY		Lease BAISH "A"		Well No. 11
Unit Letter B	Section 21	Township 17 SOUTH	Range 32 EAST	County LEA
Actual Footage Location of Well: 990 feet from the NORTH line and 2310 feet from the EAST line				
Ground Level Elev. 7400	Producing Formation Yates		Pool Baish	Dedicated Acreage: Acres

1. Is the Operator the only owner in the dedicated acreage outlined on the plat below? YES ☒ NO ☐ ("Owner" means the person who has the right to drill into and to produce from any pool and to appropriate the production either for himself or for himself and another. (65-3-29 (a) NMSA 1955 Comp.)
2. If the answer to question one is "no," have the interests of all the owners been consolidated by communitization agreement or otherwise? YES ☐ NO ☐ If answer is "yes," Type of Consolidation _____
3. If the answer to question two is "no," list all the owners and their respective interests below:

Owner	Land Description

SECTION B

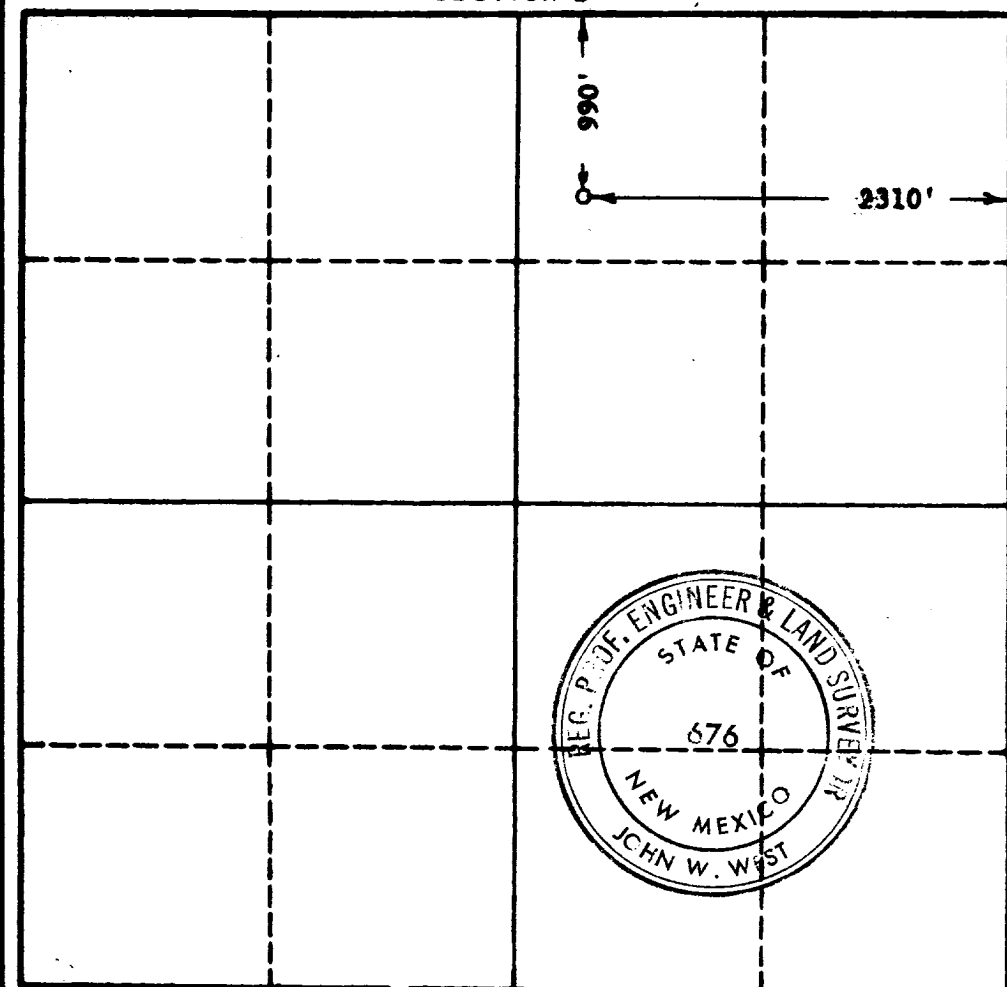

CERTIFICATION

I hereby certify that the information in SECTION A above is true and complete to the best of my knowledge and belief.

Name <i>John W. West</i>
Position Asst. Dist. Surg.
Company Continental Oil Co.
Date 9-24-63

I hereby certify that the well location shown on the plat in SECTION B was plotted from field notes of actual surveys made by me or under my supervision, and that the same is true and correct to the best of my knowledge and belief.

Date Surveyed SEPT 17, 1963
Registered Professional Engineer and/or Land Surveyor, JOHN W. WEST
Certificate No. N.M. - P.E. & L.S. NO. 676

0 330 660 990 1320 1650 1980 2310 2640 2000 1500 1000 500