

**APPROVED**

JUN 28 1962

RONNIE E. SHOOK  
ACTING DISTRICT ENGINEER

(SUBMIT IN TRIPLICATE)

UNITED STATES

DEPARTMENT OF THE INTERIOR

GEOLOGICAL SURVEY 15  
1962 JUL 2 AM 7 15Land Office **Las Cruces**Lease No. **029406(b)**Un **RECEIVED**

JUN 28 1962

**SUNDRY NOTICES AND REPORTS ON WELLS C.**

|   |                                     |   |  |
|---|-------------------------------------|---|--|
| NOTICE OF INTENTION TO DRILL.....                   | <input checked="" type="checkbox"/> | SUBSEQUENT REPORT OF WATER SHUT-OFF.....        |  |
| NOTICE OF INTENTION TO CHANGE PLANS.....            |                                     | SUBSEQUENT REPORT OF SHOOTING OR ACIDIZING..... |  |
| NOTICE OF INTENTION TO TEST WATER SHUT-OFF.....     |                                     | SUBSEQUENT REPORT OF ALTERING CASING.....       |  |
| NOTICE OF INTENTION TO RE-DRILL OR REPAIR WELL..... |                                     | SUBSEQUENT REPORT OF RE-DRILLING OR REPAIR..... |  |
| NOTICE OF INTENTION TO SHOOT OR ACIDIZE.....        |                                     | SUBSEQUENT REPORT OF ABANDONMENT.....           |  |
| NOTICE OF INTENTION TO PULL OR ALTER CASING.....    |                                     | SUPPLEMENTARY WELL HISTORY.....                 |  |
| NOTICE OF INTENTION TO ABANDON WELL.....            |                                     |   |  |

(INDICATE ABOVE BY CHECK MARK NATURE OF REPORT, NOTICE, OR OTHER DATA)

June 25, 1962

**Grace Mitchell "B"**Well No. **7** is located **1980** ft. from **(N)** line and **1980** ft. from **(E)** line of sec. **5**SW/4 of NE/4 Sec. 5 **17** **32** **NMPM**  
(1/4 Sec. and Sec. No.) (Twp.) (Range) (Meridian)**Maljamar**  
(Field)**Lea**  
(County or Subdivision)**New Mexico**  
(State or Territory)

The elevation of the derrick floor above sea level is \_\_\_\_\_ ft.

**DETAILS OF WORK**

(State names of and expected depths to objective sands; show sizes, weights, and lengths of proposed casings; indicate mudding jobs, cementing points, and all other important proposed work)

It is our intention to drill a well at the above location to an approximate depth of 4150' to attempt a completion in the Grayburg San Andres horizon. All casing points will be cemented in accordance with approved methods of the USGS, and any special requirements will be complied with.

It is planned to use the following casing pattern: 11" hole, 7 5/8" casing to be set at 950' and cemented with 475 sacks. Cement is to circulate. 6 3/4" hole, 4 1/2" casing to be set at 3900' and cemented with 225 sacks. Cement is to return to 1950'.

Permission is requested to produce the well upon completion.

I understand that this plan of work must receive approval in writing by the Geological Survey before operations may be commenced.

Company **Continental Oil Company**Address **Box 427****Hobbs, New Mexico**By **[Signature]**Title **District Superintendent**

USGS(3) NMOC(2) WAM FILE



# NEW MEXICO OIL CONSERVATION COMMISSION

## WELL LOCATION AND ACREAGE DEDICATION PLAT

FORM C-128  
Revised 5/1/57

**HOBBS OFFICE OCC**

SEE INSTRUCTIONS FOR COMPLETING THIS FORM ON THE REVERSE SIDE

### SECTION A

|  |   |                             |                                    |                      |                                       |
|--|---|-----------------------------|------------------------------------|----------------------|---------------------------------------|
| Operator<br><b>CONTINENTAL OIL COMPANY</b>   |   |                             | Lease<br><b>GRACE MITCHELL "B"</b> |                      | 2<br>15<br>7                          |
| Unit Letter<br><b>G</b>  | Section<br><b>5</b>                               | Township<br><b>17 SOUTH</b> | Range<br><b>32 EAST</b>            | County<br><b>LEA</b> |                                       |
| Actual Footage Location of Well:<br><b>1980</b> feet from the <b>NORTH</b> line and <b>1980</b> feet from the <b>EAST</b> line |   |                             |                                    |                      |                                       |
| Ground Level Elev.   | Producing Formation<br><b>Grayburg-San Andres</b> |                             | Pool<br><b>Maljamar</b>            |                      | Dedicated Acreage:<br><b>40</b> Acres |

1. Is the Operator the only owner in the dedicated acreage outlined on the plat below? YES ☒ NO ☐ ("Owner" means the person who has the right to drill into and to produce from any pool and to appropriate the production either for himself or for himself and another. (65-3-29 (e) NMSA 1935 Comp.)
2. If the answer to question one is "no," have the interests of all the owners been consolidated by communitization agreement or otherwise? YES ☐ NO ☐ If answer is "yes," Type of Consolidation \_\_\_\_\_
3. If the answer to question two is "no," list all the owners and their respective interests below:

| Owner | Land Description |
|-------|------------------|
|       |                  |

### SECTION B

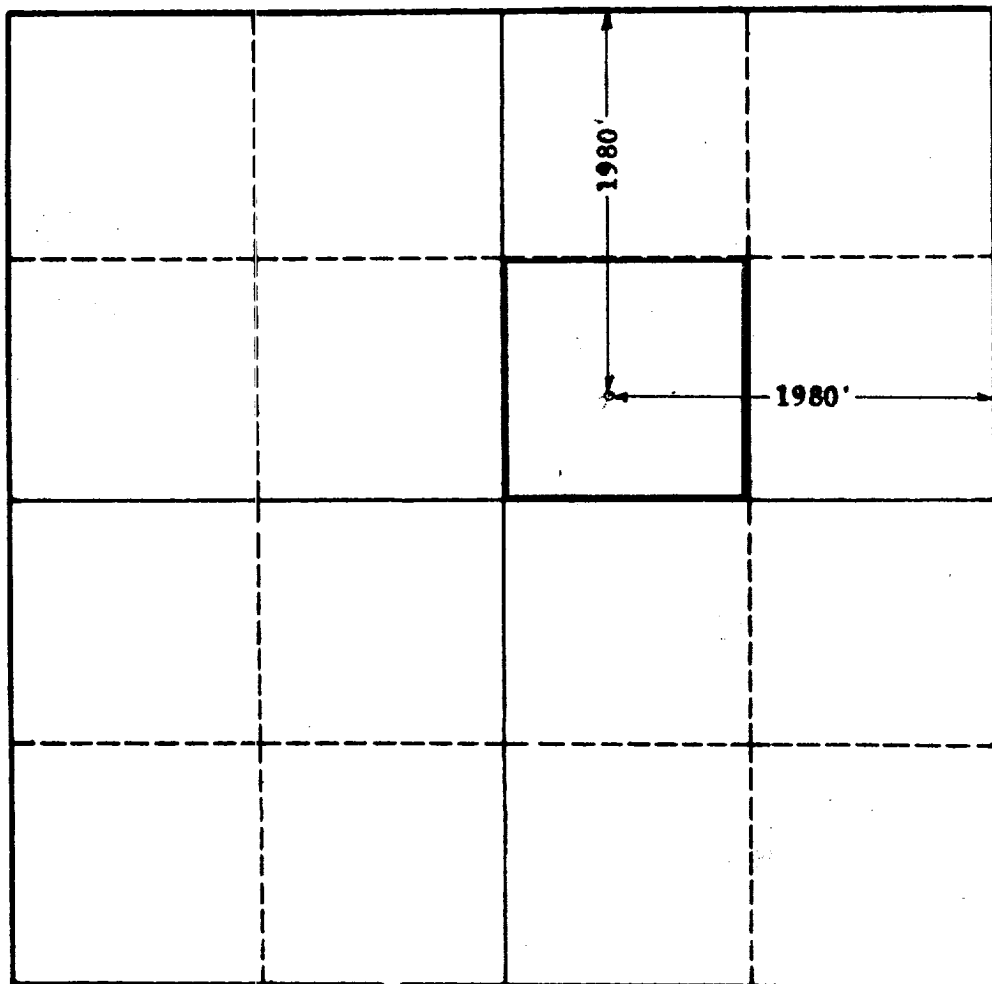

0 330 660 990 1320 1650 1980 2310 2640 2970 3300 3630 3960 4290 4620 4950 5280 5610 5940 6270 6600

### CERTIFICATION

I hereby certify that the information in SECTION A above is true and complete to the best of my knowledge and belief.

Name  
*E. M. Minter*  
 Position  
**District Superintendent**  
 Company  
**Continental Oil Company**  
 Date  
**June 25, 1962**

I hereby certify that the well location shown on the plat in SECTION B was placed from field notes of actual survey made by me or under my supervision, and that the same is true and correct to the best of my knowledge and belief.

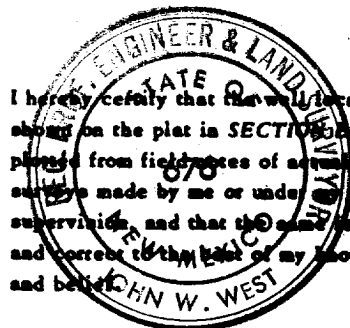

Date Surveyed  
**6-22-62**  
 Registered Professional Engineer and/or Land Surveyor, **JOHN W. WEST**  
*John W. West*  
 Certificate No.  
**N.M. - P.E. & L.S. NO. 676**