

| | |
|---------------------------|------------|
| NUMBER OF COPIES RECEIVED | |
| DISTRIBUTION | |
| SANTA FE | |
| FILE | |
| U.S.G.S. | |
| LAND OFFICE | |
| TRANSPORTER | OIL GAS |
| PRODUCTION OFFICE | |
| OPERATOR | |

NEW MEXICO OIL CONSERVATION COMMISSION
WELL LOCATION AND ACREAGE DEDICATION PLAT
 SEE INSTRUCTIONS FOR COMPLETING THIS FORM ON THE REVERSE SIDE

FORM C-128
Revised 5/1/57

HOBBS OFFICE
Nov 17 8 17 AM '63

SECTION A

| | | | | | |
|---|--------------------------------------|-----------------------------|-------------------------|----------------------|---------------------------------------|
| Operator Leonard Nichols | | Lease Aztec State | | Well No. 4 | |
| Unit Letter N | Section 8 | Township T-17-S | Range R-33-E | County Lee | |
| Actual Footage Location of Well: 990 feet from the South line and 2310 feet from the West line | | | | | |
| Ground Level Elev. 4201 | Producing Formation gravel | | Pool Maljanda | | Dedicated Acreage: 40 Acres |

1. Is the Operator the only owner in the dedicated acreage outlined on the plat below? YES ☒ NO ____ . ("Owner" means the person who has the right to drill into and to produce from any pool and to appropriate the production either for himself or for himself and another. (65-3-29 (e) NMSA 1935 Comp.)
2. If the answer to question one is "no," have the interests of all the owners been consolidated by communitization agreement or otherwise? YES ____ NO ____ . If answer is "yes," Type of Consolidation ____
3. If the answer to question two is "no," list all the owners and their respective interests below:

| Owner | Land Description |
|-------|------------------|
| | |

SECTION B

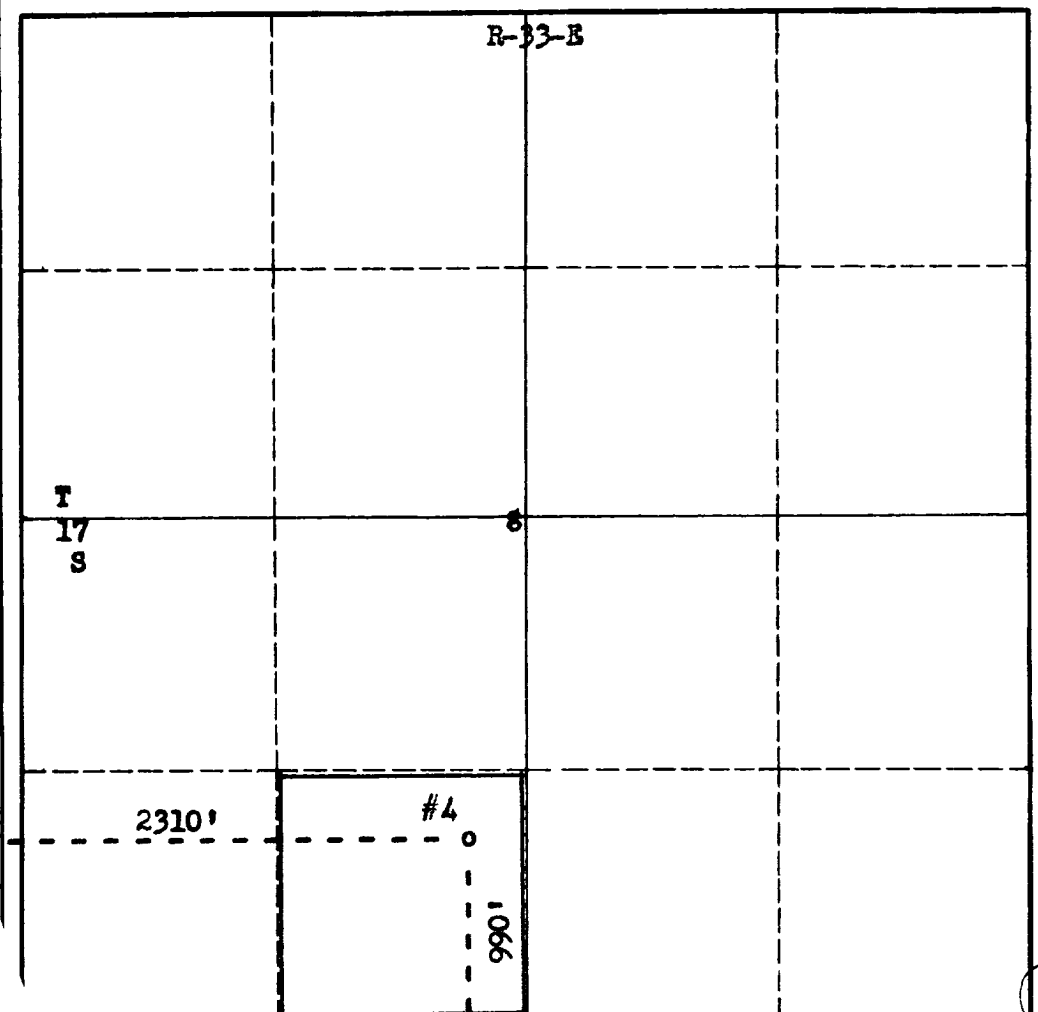

CERTIFICATION

I hereby certify that the information in SECTION A above is true and complete to the best of my knowledge and belief.

| |
|-----------------------------------|
| Name E. J. McCallister |
| Position Surveyor |
| Company Leonard Nichols |
| Date 11-9-1963 |

I hereby certify that the well location shown on the plat in SECTION B was plotted from field notes of actual surveys made by me or under my supervision, and that the same is true and correct to the best of my knowledge and belief.

| |
|--|
| Date Surveyed November 7, 1963 |
| Registered Professional Engineer and/or Land Surveyor James H. Brown |
| Certificate No. 542 |

INSTRUCTIONS FOR COMPLETION OF FORM C-128

1. Operator shall furnish and certify to the information called for in Section A.
2. Operator shall outline the dedicated acreage for *both* oil and gas wells on the plat in Section B.
3. A registered professional engineer or land surveyor registered in the State of New Mexico or approved by the Commission shall show on the plat the location of the well and certify this information in the space provided.
4. All distances shown on the plat must be from the outer boundaries of the Section.
5. If additional space is needed for listing owners and their respective interests as required in question 3 of Section A, please use space below.