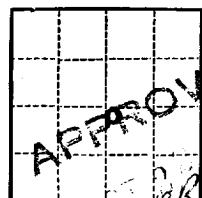

(SUBMIT IN TRIPLICATE)

Land Office **Santa Fe, N.M.**Lease No. **LC 029410 (b)**Unit **"J"**UNITED STATES
DEPARTMENT OF THE INTERIOR
GEOLOGICAL SURVEY

SUNDRY NOTICES AND REPORTS ON WELLS

NOTICE OF INTENTION TO DRILL.....	<input checked="" type="checkbox"/>	SUBSEQUENT REPORT OF WATER SHUT-OFF.....	
NOTICE OF INTENTION TO CHANGE PLANS.....		SUBSEQUENT REPORT OF SHOOTING OR ACIDIZING.....	
NOTICE OF INTENTION TO TEST WATER SHUT-OFF.....		SUBSEQUENT REPORT OF ALTERING CASING.....	
NOTICE OF INTENTION TO RE-DRILL OR REPAIR WELL.....		SUBSEQUENT REPORT OF RE-DRILLING OR REPAIR.....	
NOTICE OF INTENTION TO SHOOT OR ACIDIZE.....		SUBSEQUENT REPORT OF ABANDONMENT.....	
NOTICE OF INTENTION TO PULL OR ALTER CASING.....		SUPPLEMENTARY WELL HISTORY.....	
NOTICE OF INTENTION TO ABANDON WELL.....			

(INDICATE ABOVE BY CHECK MARK NATURE OF REPORT, NOTICE, OR OTHER DATA)

October 19, 1962

Well No. 1 is located 2310 ft. from ☒S line and 2310 ft. from ☒W line of sec. 30SE 1/4 Sec. 30

(1/4 Sec. and Sec. No.)

Wildcat

(Field)

17S

(Twp.)

32 E

(Range)

Lea

(County or Subdivision)

NMPM

(Meridian)

New Mexico

(State or Territory)

The elevation of the derrick floor above sea level is _____ ft.

DETAILS OF WORK

(State names of and expected depths to objective sands; show sizes, weights, and lengths of proposed casings; indicate mudding jobs, cementing points, and all other important proposed work)

Propose to drill from surface to total depth with Rotary tools.
Drill with water to 7000'; sample mud thereafter to total depth
of approximately 9500 feet.
Electric logs from surface to total depth.

Proposed Casing Program13 3/8" set at 700 feet with 500 sacks cement.8 5/8" set at 4200 feet with 1600 sacks cement.5 1/2" set at 9500 feet with 1000 sacks cement.

(Additional information on reverse side.)

I understand that this plan of work must receive approval in writing by the Geological Survey before operations may be commenced.

Company Forest Oil CorporationAddress P. O. Box 4486Midland, TexasBy J. R. Creech
J. R. Creech
Division Landman

Title _____

**Expected Depths to Formation Tops,
Cores and Tests**

<u>Formation</u>	<u>Depth, feet</u>	<u>Core</u>	<u>Test</u>
Anhydrite	650	-	-
Salt	800	-	-
Yates	2100	-	-
Queen	3050	-	-
Grayburg	3500	-	-
San Andres	3820	-	-
Yeso	5400	-	1
Bone Springs	6300	-	1
Upper Abo Reef	7400	100 feet	2
Middle Abo Reef	8000	100 feet	2
Lower Abo Reef	9000	100 feet	2

NUMBER OF COPIES RECEIVED	
DISTRIBUTION	
SANTA FE	
FILE	
U.S.G.S.	
LAND OFFICE	
TRANSPORTER	OIL GAS
PRORATOR OFFICE	
OPERATOR	

NEW MEXICO OIL CONSERVATION COMMISSION
WELL LOCATION AND ACREAGE DEDICATION PLAT
 SEE INSTRUCTIONS FOR COMPLETING THIS FORM ON THE REVERSE SIDE

FORM C-128
Revised 5/1/57

SECTION A			
Operator Forest Oil Corporation		Lease Federal-Chaparral (LC 029410 b)	Well No. 1
Unit Letter J	Section 30	Township 17 South	Range 32 East
		County Lea	
Actual Footage Location of Well: 2310 feet from the South line and 2310 feet from the East line			
Ground Level Elev.	Producing Formation Abo Reef	Pool Wildcat	Dedicated Acreage: 40 Acres

1. Is the Operator the only owner in the dedicated acreage outlined on the plat below? YES ☒ NO ____ . ("Owner" means the person who has the right to drill into and to produce from any pool and to appropriate the production either for himself or for himself and another. (65-3-29 (e) NMSA 1935 Comp.)
2. If the answer to question one is "no," have the interests of all the owners been consolidated by communitization agreement or otherwise? YES ____ NO ____ . If answer is "yes," Type of Consolidation ____
3. If the answer to question two is "no," list all the owners and their respective interests below:

Owner	Land Description

SECTION B

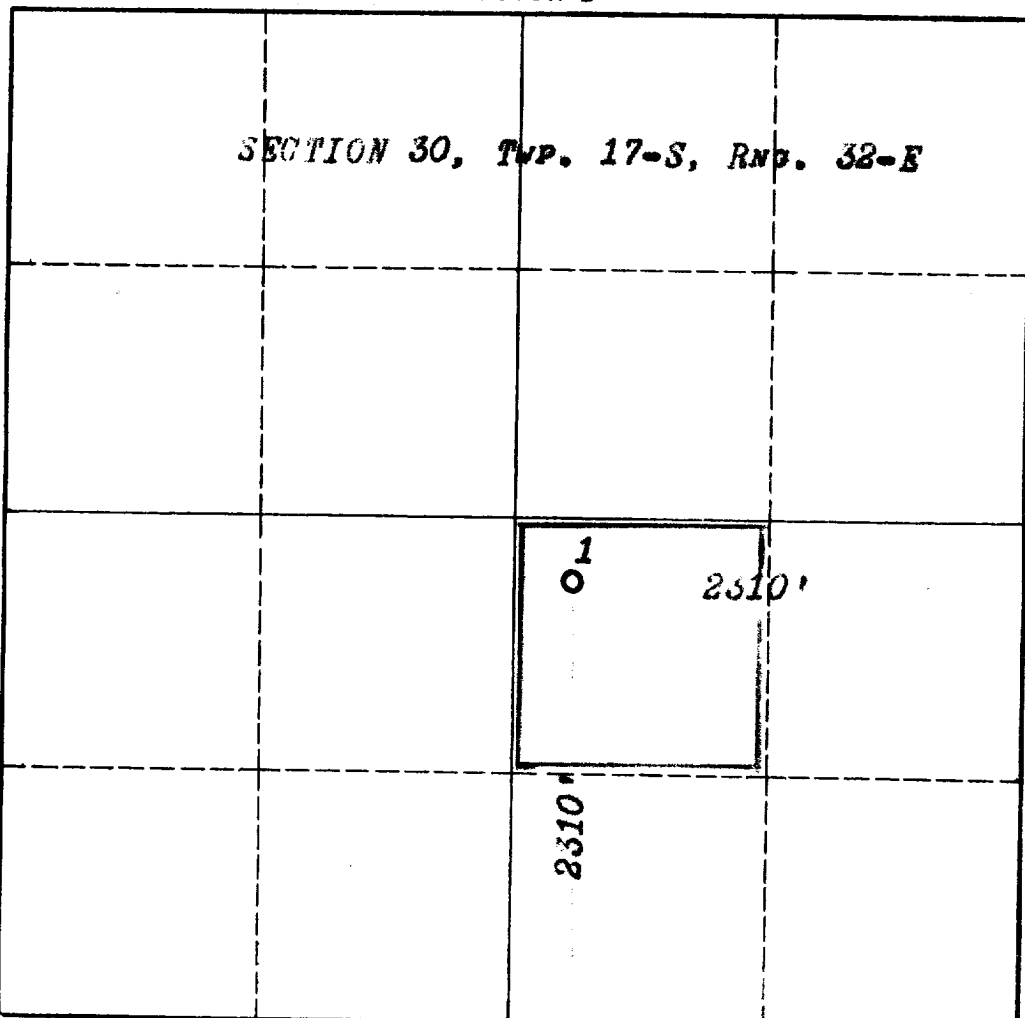

CERTIFICATE

I hereby certify that the information in SECTION A above is true and complete to the best of my knowledge and belief.

J. R. Creech
 Name
J. R. Creech
 Position
Division Landman
 Company
Forest Oil Corp.
 Date
October 19, 1962

I hereby certify that the well location shown on the plat in SECTION B was plotted from field notes of actual surveys made by me or under my supervision, and that the same is true and correct to the best of my knowledge and belief.

Date Surveyed
Oct. 18, 1962
 Registered Professional Engineer
 and/or Land Surveyor
[Signature]

Certificate No. **754**

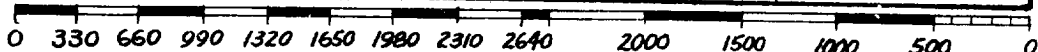

INSTRUCTIONS FOR COMPLETION OF FORM C-128

1. Operator shall furnish and certify to the information called for in Section A.
2. Operator shall outline the dedicated acreage for *both* oil and gas wells on the plat in Section B.
3. A registered professional engineer or land surveyor registered in the State of New Mexico or approved by the Commission shall show on the plat the location of the well and certify this information in the space provided.
4. All distances shown on the plat must be from the outer boundaries of the Section.
5. If additional space is needed for listing owners and their respective interests as required in question 3 of Section A, please use space below.