

PARTY'S USE	
FILE	
U.S.G.S.	
LAND OFFICE	
TRANSPORTER	OIL GAS
PRODUCTION OFFICE	
OPERATOR	

**NEW MEXICO OIL CONSERVATION COMMISSION**  
**Santa Fe, New Mexico**

Form C-101  
Revised (12/1/55)

## NOTICE OF INTENTION TO DRILL

Notice must be given to the District Office of the Oil Conservation Commission and approval obtained before drilling or recompletion begins. If changes in the proposed plan are considered advisable, a copy of this notice showing such changes will be returned to the sender. Submit this notice in **QUINTUPPLICATE**. One copy will be returned following approval. See additional instructions in Rules and Regulations of the Commission.

If State Land submit 6 Copies Attach Form C-128 in triplicate to first 3 copies of form C-101

**Hobbs, New Mexico**

**May 24, 1963**

(Place)

(Date)

**OIL CONSERVATION COMMISSION**  
**SANTA FE, NEW MEXICO**

Gentlemen:

You are hereby notified that it is our intention to commence the Drilling of a well to be known as  
**Pan American Petroleum Corporation**

(Company or Operator)

**Sinclair State**

(Lease)

Well No. **1**

**1**

in **1930** (Unit)

The well is

located **660** feet from the **North**

**East**

line and **36-7** feet from the

**188**

line of Section **11**

**15-S**

**188**

, NMPM.

(GIVE LOCATION FROM SECTION LINE)

**wildcat**

Pool, **2-9647**

County

If State Land the Oil and Gas Lease is No.

If patented land the owner is

Address

We propose to drill well with drilling equipment as follows:

**O-TD with rotary tool**

The status of plugging bond is

**Blanket bond on file with Commission**

Drilling Contractor

**To be furnished**

We intend to complete this well in the

**Silurian Devonian**

formation at an approximate depth of

**14,300**

feet.

### CASING PROGRAM

We propose to use the following strings of Casing and to cement them as indicated:

Size of Hole	Size of Casing	Weight per Foot	New or Second Hand	Depth	Seals Cement
<b>17-1/2"</b>	<b>13-3/8"</b>	<b>35.6#</b>	<b>New</b>	<b>400</b>	<b>Circulate</b>
<b>12-1/4"</b>	<b>9-5/8"</b>	<b>32.3 - 36#</b>	<b>New</b>	<b>5000</b>	<b>"</b>
<b>8-3/4"</b>	<b>5-1/2" - 7"</b>	<b>14# - 23#</b>	<b>New</b>	<b>14,100</b>	<b>**</b>

If changes in the above plans become advisable we will notify you immediately.

ADDITIONAL INFORMATION (If recompletion give full details of proposed plan of work.)

**\*Sufficient to fill to top of salt.**  
**\*\* 600' above indicated pays.**

Approved....., 19.....  
Except as follows:

Sincerely yours,

**Pan American Petroleum Corporation**

Original Signed by: (Company or Operator)

By **V. E. STALEY**

**Area superintendent**

Position

Send Communications regarding well to

Name

**Box 65 - Hobbs, New Mexico**

Address

**OIL CONSERVATION COMMISSION**

By *[Signature]*

NEW MEXICO OIL CONSERVATION COMMISSION  
WELL LOCATION AND ACREAGE DEDICATION PLAT

FORM C-128  
Revised 5/1/57

SEE INSTRUCTIONS FOR COMPLETING THIS FORM ON THE REVERSE SIDE

SECTION A

Operator <b>PAN AMERICAN OIL CORPORATION</b>		Lease <b>SINCLAIR STATE</b>		Well No. <b>1</b>
Unit Letter <b>B</b>	Section <b>11</b>	Township <b>15 SOUTH</b>	Range <b>36 EAST</b>	County <b>LEA</b>
Actual Footage Location of Well: <b>660</b> feet from the <b>NORTH</b> line and <b>1980</b> feet from the <b>EAST</b> line				
Ground Level Elev. <b>NXA</b>	Producing Formation <b>Silurian</b>	Pool <b>Wildest</b>	Dedicated Acreage: <b>40</b> Acres	

1. Is the Operator the only owner in the dedicated acreage outlined on the plat below? YES ☒ NO ☐ ("Owner" means the person who has the right to drill into and to produce from any pool and to appropriate the production either for himself or for himself and another. (65-3-29 (e) NMSA 1935 Comp.)
2. If the answer to question one is "no," have the interests of all the owners been consolidated by communization agreement or otherwise? YES ☐ NO ☐ If answer is "yes," Type of Consolidation \_\_\_\_\_
3. If the answer to question two is "no," list all the owners and their respective interests below:

Owner	Land Description

SECTION B

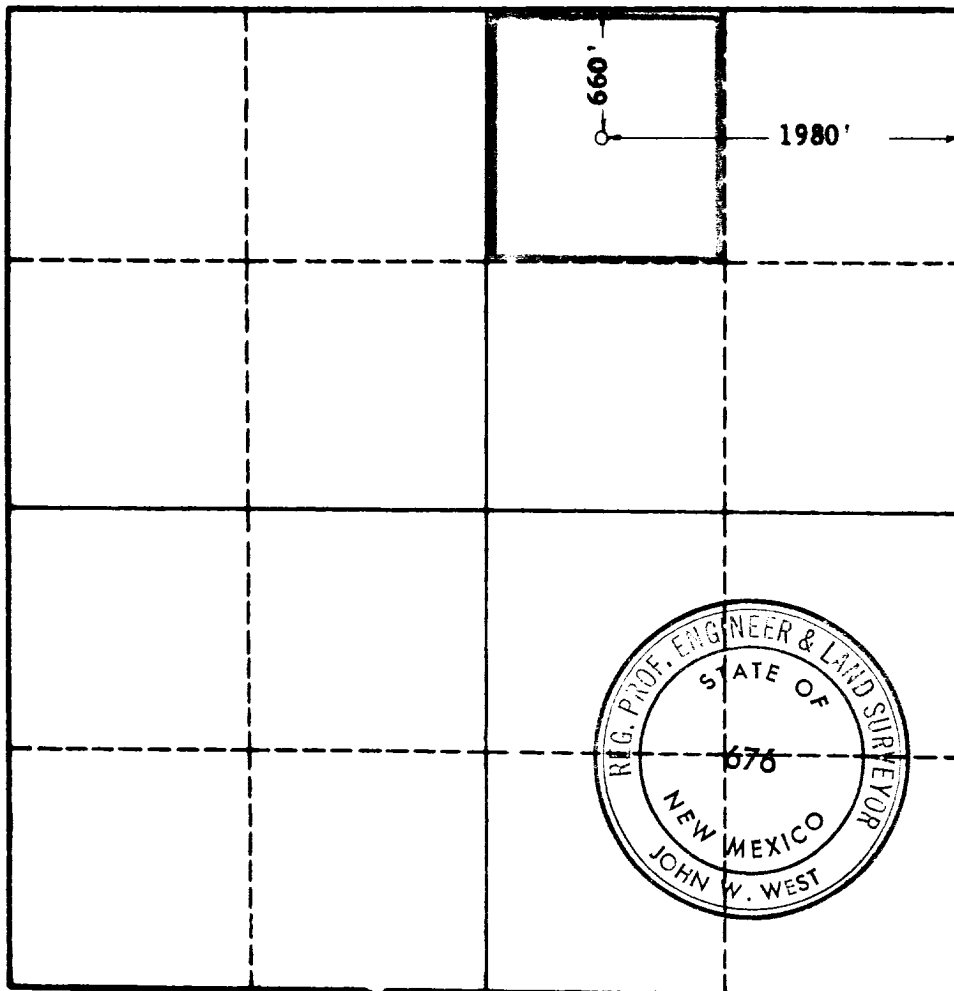

CERTIFICATION

I hereby certify that the information in SECTION A above is true and complete to the best of my knowledge and belief.

Name                     

Position  
**Area Superintendent**

Company  
**Pan American Petroleum Corp.**

Date  
**May 24, 1963**

I hereby certify that the well location shown on the plat in SECTION B was plotted from field notes of actual surveys made by me or under my supervision, and that the same is true and correct to the best of my knowledge and belief.

Date Surveyed  
**5-21-63**

Registered Professional Engineer  
and/or Land Surveyor, **JOHN W. WEST**

*John W. West*

Certificate No.  
**N.M. - P.E. & L.S. NO. 676**

0 330 660 990 1320 1650 1980 2310 2640 2000 1600 1200 800 400 0