

COPY

**NEW MEXICO OIL CONSERVATION COMMISSION**  
**WELL LOCATION AND ACREAGE DEDICATION PLAT**

FORM C-128  
 Revised 5/1/57

SEE INSTRUCTIONS FOR COMPLETING THIS FORM ON THE REVERSE SIDE

## SECTION A

Operator <b>AZTEC OIL &amp; GAS COMPANY</b>			Lease <b>NORTHEAST MALJAMAR UNIT</b>		Well No. <b>3</b>
Unit Letter <b>O</b>	Section <b>31</b>	Township <b>16 SOUTH</b>	Range <b>33 EAST</b>	County <b>LEA</b>	
Actual Footage Location of Well: <b>660</b> feet from the <b>SOUTH</b> line and <b>1980</b> feet from the <b>EAST</b> line					
Ground Level Elev. <b>4240.9</b>	Producing Formation <b>Kennitz W/S</b>		Pool <b>Undesignated</b>		Dedicated Acreage: <b>40 80</b> Acres

1. Is the Operator the only owner in the dedicated acreage outlined on the plat below? YES ☒ NO \_\_\_\_ . ("Owner" means the person who has the right to drill into and to produce from any pool and to appropriate the production either for himself or for himself and another. (65-3-29 (a) NMSA 1935 Comp.)
2. If the answer to question one is "no," have the interests of all the owners been consolidated by communitization agreement or otherwise? YES \_\_\_\_ NO \_\_\_\_ . If answer is "yes," Type of Consolidation Unit
3. If the answer to question two is "no," list all the owners and their respective interests below:

Owner	Land Description

## SECTION B

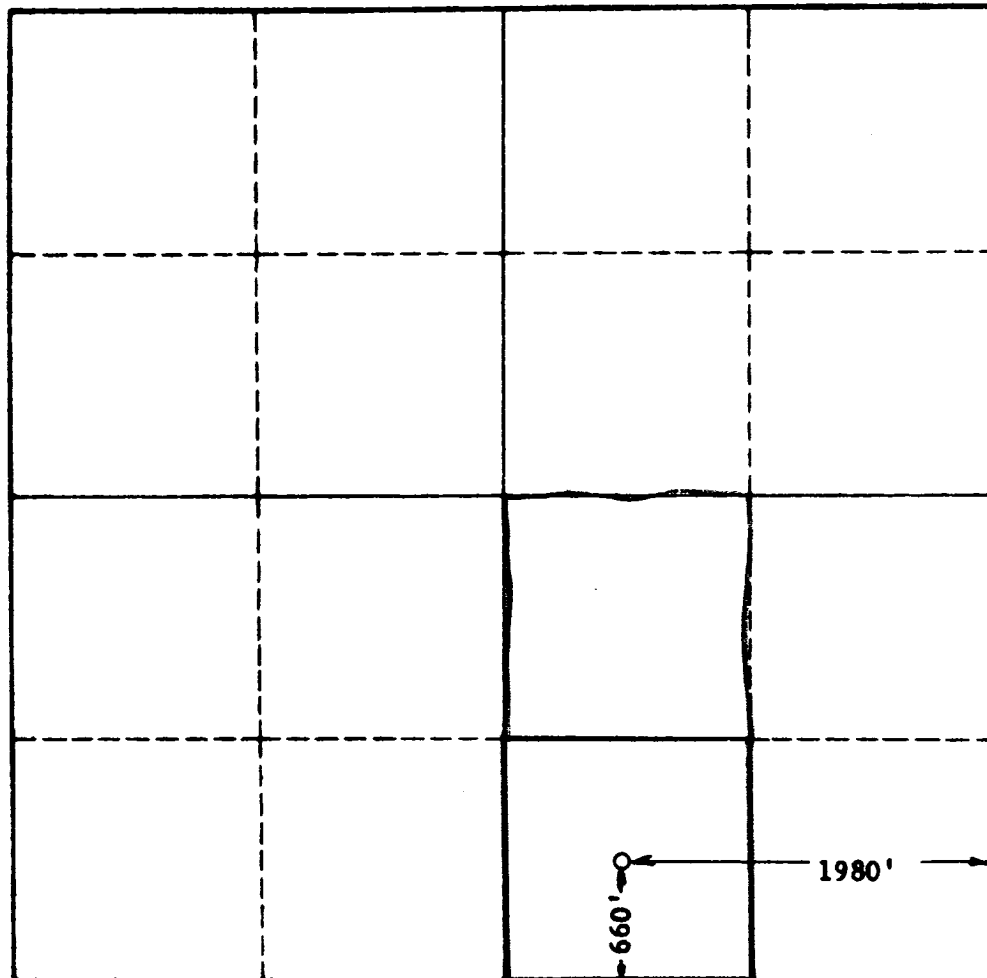

## CERTIFICATION

I hereby certify that the information in SECTION A above is true and complete to the best of my knowledge and belief. original signed by  
**LESTER L. DUKE**

Name <b>Lester L. Duke</b>
Position <b>District Superintendent</b>
Company <b>Aztec Oil &amp; Gas Co.</b>
Date <b>August 7, 1964</b>

I hereby certify that the well location shown on the plat in SECTION B was plotted from field notes of actual surveys made by me or under my supervision, and that the same is true and correct to the best of my knowledge and belief.

Date Surveyed <b>AUGUST 6, 1964</b>
Registered Professional Engineer and/or Land Surveyor, <b>JOHN W. WEST</b>
Certificate No. <b>John W. West</b>
N. M. - P. E. & L. S. NO. 676

0 330 660 990 1320 1650 1980 2310 2640 2000 1500 1000 500 0

413