

NUMBER OF COPIES RECEIVED	
DISTRIBUTION	
SANTA FE	
FILE	
U.S.G.S	
LAND OFFICE	
TRANSPORTER	OIL
	GAS
PRODUCTION OFFICE	
OPERATOR	

NEW MEXICO OIL CONSERVATION COMMISSION
Santa Fe, New Mexico

Form C-101
Revised (12/1/55)

NOTICE OF INTENTION TO DRILL

Notice must be given to the District Office of the Oil Conservation Commission and approval obtained before drilling or recompletion begins. If changes in the proposed plan are considered advisable, a copy of this notice showing such changes will be returned to the sender. Submit this notice in QUINTUPLICATE. One copy will be returned following approval. See additional instructions in Rules and Regulations of the Commission. If State Land submit 6 Copies Attach Form C-128 in triplicate to first 3 copies of form C-101

_____ (Place) _____ (Date)

OIL CONSERVATION COMMISSION
SANTA FE, NEW MEXICO

Gentlemen:

You are hereby notified that it is our intention to commence the Drilling of a well to be known as

_____ (Company or Operator)
_____, Well No. _____, in _____ (Unit)
The well is located _____ feet from the _____ line and _____ feet from the _____ line of Section _____, T. _____, R. _____, NMPM.

(GIVE LOCATION FROM SECTION LINE) _____ Pool, _____ County

If State Land the Oil and Gas Lease is No. _____

If patented land the owner is _____

Address _____

We propose to drill well with drilling equipment as follows: _____

The status of plugging bond is _____

Drilling Contractor _____

We intend to complete this well in the _____ formation at an approximate depth of _____ feet.

CASING PROGRAM

We propose to use the following strings of Casing and to cement them as indicated:

Size of Hole	Size of Casing	Weight per Foot	New or Second Hand	Depth	Sacks Cement
8 1/2"	7 7/8"	12.5	NEW	100	400
7 1/2"	7"	10.5	NEW	100	400
6 1/2"	6"	8.5	NEW	100	400

If changes in the above plans become advisable we will notify you immediately.

ADDITIONAL INFORMATION (If recompletion give full details of proposed plan of work.)

Approved _____, 19_____
Except as follows:

OIL CONSERVATION COMMISSION

By _____

Sincerely yours,

(Company or Operator)

By _____

Position _____

Send Communications regarding well to

Name _____

Address _____

NUMBER OF COPIES RECEIVED	
DISTRIBUTION	
SANTA FE	
FILE	
U.S.G.S.	
LAND OFFICE	
TRANSPORTER	OIL GAS
PRODUCTION OFFICE	
OPERATOR	

NEW MEXICO OIL CONSERVATION COMMISSION
WELL LOCATION AND ACREAGE DEDICATION PLAT
 SEE INSTRUCTIONS FOR COMPLETING THIS FORM ON THE REVERSE SIDE

FORM C-128
 Revised 5/1/57

SECTION A

Operator Sam Boren and Major & Giebel Oils		Lease Humble State D		Well No. 3	
Unit Letter K	Section 22	Township 16	Range 34E	County Lea	
Actual Footage Location of Well: 1980 feet from the south line and 1980 feet from the west line					
Ground Level Elev. 4086	Producing Formation Wolfcamp		Pool Kemnitz Wolfcamp	Dedicated Acreage: 80 Acres	

1. Is the Operator the only owner in the dedicated acreage outlined on the plat below? YES ☒ NO ☐ . ("Owner" means the person who has the right to drill into and to produce from any pool and to appropriate the production either for himself or for himself and another. (65-3-29 (e) NMSA 1935 Comp.)
2. If the answer to question one is "no," have the interests of all the owners been consolidated by communitization agreement or otherwise? YES ☐ NO ☐ . If answer is "yes," Type of Consolidation _____
3. If the answer to question two is "no," list all the owners and their respective interests below:

Owner	Land Description

SECTION B

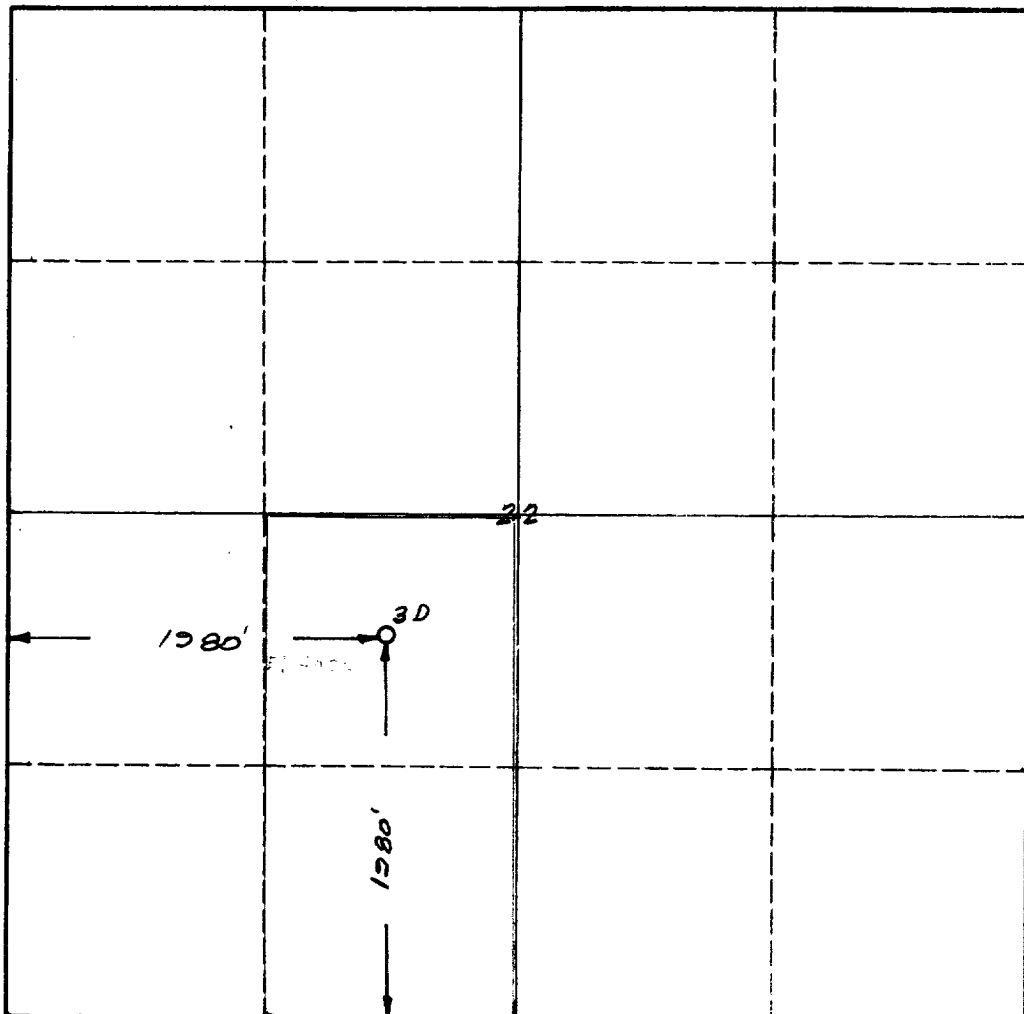

CERTIFICATION

I hereby certify that the information in SECTION A above is true and complete to the best of my knowledge and belief.

Name _____
 Position _____
 Agent _____
 Company _____
 Sam Boren and Major & Giebel Oils
 Date February 11, 1965

I hereby certify that the well location shown on the plat in SECTION B was plotted from field notes of actual surveys made by me or under my supervision, and that the same is true and correct to the best of my knowledge and belief.

Date Surveyed Feb. 9, 1965
 Registered Professional Engineer
 and/or Land Surveyor

Wm E. Shaw
 Certificate No. 2189

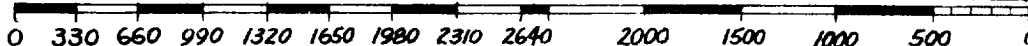

INSTRUCTIONS FOR COMPLETION OF FORM C-128

1. Operator shall furnish and certify to the information called for in Section A.
2. Operator shall outline the dedicated acreage for *both* oil and gas wells on the plat in Section B.
3. A registered professional engineer or land surveyor registered in the State of New Mexico or approved by the Commission shall show on the plat the location of the well and certify this information in the space provided.
4. All distances shown on the plat must be from the outer boundaries of the Section.
5. If additional space is needed for listing owners and their respective interests as required in question 3 of Section A, please use space below.