

NEW MEXICO OIL CONSERVATION COMMISSION
WELL LOCATION AND ACREAGE DEDICATION PLAT

FORM C-128
Revised 5/1/57

SEE INSTRUCTIONS FOR COMPLETING THIS FORM ON THE REVERSE SIDE

SECTION A

Operator UNION OIL CO. OF CALIFORNIA		Lease STANSELL 7		Well No. 1
Unit Letter B	Section 7	Township 15 SOUTH	Range 35 EAST	County LEA
Actual Footage Location of Well: 660' feet from the NORTH line and 1980' feet from the EAST line				
Ground Level Elev.	Producing Formation LOWER WOLFCAMP	Pool MORTON (WOLFCAMP)	Dedicated Acreage: 80 (N $\frac{1}{2}$ NE $\frac{1}{4}$) Acres	

1. Is the Operator the only owner in the dedicated acreage outlined on the plat below? YES X NO ____ . ("Owner" means the person who has the right to drill into and to produce from any pool and to appropriate the production either for himself or for himself and another. (65-3-29 (e) NMSA 1935 Comp.)
2. If the answer to question one is "no," have the interests of all the owners been consolidated by communization agreement or otherwise? YES ____ NO ____ . If answer is "yes," Type of Consolidation ____
3. If the answer to question two is "no," list all the owners and their respective interests below:

Owner	Land Description

SECTION B

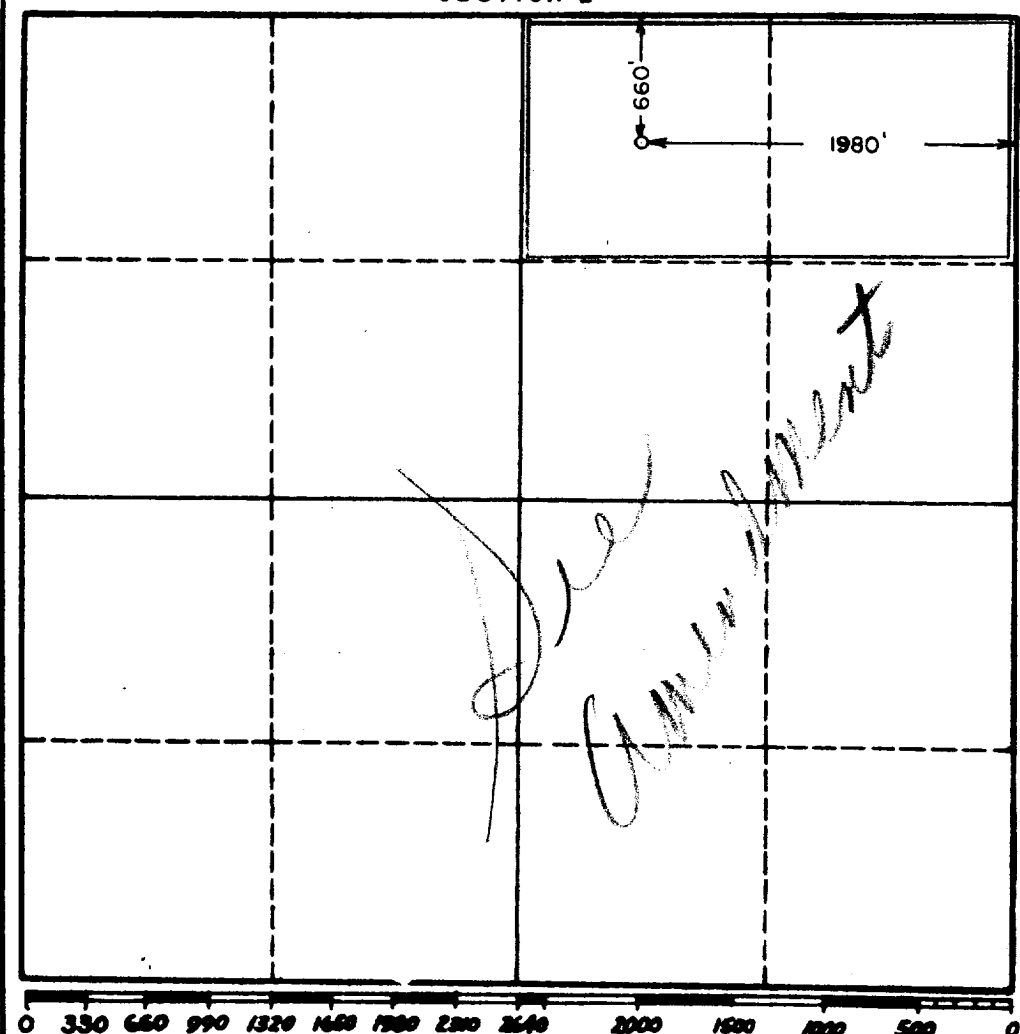

CERTIFICATION

I hereby certify that the information in SECTION A above is true and complete to the best of my knowledge and belief.

Name John W. West
JOHN W. WEST
Position AGENT
Company UNION OIL COMPANY OF CALIF.
Date 5-20-65

I hereby certify that the well location shown on the plat in SECTION B was plotted from field notes of actual surveys made by me or under my supervision, and that the same is true and correct to the best of my knowledge and belief.

Date Surveyed 5-20-65
Registered Professional Engineer and/or Land Surveyor, JOHN W. WEST
John W. West
Certificate No. N. M. - P. E. & L. S. NO. 676