

Submit 3 Copies To Appropriate District
Office
District I
1625 N. French Dr., Hobbs, NM 88240
District II
1301 W. Grand Ave., Artesia, NM 88210
District III
1000 Rio Brazos Rd., Aztec, NM 87410
District IV
1220 S. St. Francis Dr., Santa Fe, NM
87505

State of New Mexico
Energy, Minerals and Natural Resources

Form C-103
Revised March 25, 1999

OIL CONSERVATION DIVISION
1220 South St. Francis Dr.
Santa Fe, NM 87505

WELL API NO. 30-025-31621
5. Indicate Type of Lease STATE <input checked="" type="checkbox"/> FEE <input type="checkbox"/>
6. State Oil & Gas Lease No. V-3836

SUNDRY NOTICES AND REPORTS ON WELLS
(DO NOT USE THIS FORM FOR PROPOSALS TO DRILL OR TO DEEPEN OR PLUG BACK TO A
DIFFERENT RESERVOIR. USE "APPLICATION FOR PERMIT" (FORM C-101) FOR SUCH
PROPOSALS.)

1. Type of Well:
Oil Well ☐ Gas Well ☒ Other

2. Name of Operator
BTA Oil Producers

3. Address of Operator
104 S. Pecos, Midland, TX 79701

4. Well Location

Unit Letter L : 1980 feet from the south line and 660 feet from the west line

Section 31 Township 16S Range 35E NMPM Lea County

10. Elevation (Show whether DR, RKB, RT, GR, etc.)
4025' GR 4042' RKB

11. Check Appropriate Box to Indicate Nature of Notice, Report or Other Data	
NOTICE OF INTENTION TO:	SUBSEQUENT REPORT OF:
PERFORM REMEDIAL WORK <input type="checkbox"/> PLUG AND ABANDON <input type="checkbox"/>	REMEDIAL WORK <input type="checkbox"/> ALTERING CASING <input type="checkbox"/>
TEMPORARILY ABANDON <input type="checkbox"/> CHANGE PLANS <input type="checkbox"/>	COMMENCE DRILLING OPNS. <input type="checkbox"/> PLUG AND ABANDONMENT <input type="checkbox"/>
PULL OR ALTER CASING <input type="checkbox"/> MULTIPLE COMPLETION <input type="checkbox"/>	CASING TEST AND CEMENT JOB <input type="checkbox"/>
OTHER: <input type="checkbox"/>	OTHER: Plugback <input checked="" type="checkbox"/>

12. Describe proposed or completed operations. (Clearly state all pertinent details, and give pertinent dates, including estimated date of starting any proposed work). SEE RULE 1103. For Multiple Completions: Attach wellbore diagram of proposed completion or recompilation.

BTA Oil Producers performed the following procedure to Plugback and Test the ABO zone in this well:

1. MI & RU PU.
2. ND WH. NU BOP. POH w/prod tbg.
3. Set CIBP at 12,300', cap w/40' cmt. 11-18-02
4. TIH w/tbg to 8922'. Load hole w/2% KCL wtr. Spot 200 gal 10% acetic acid at 8922'. POH with tbg.
5. Perf 8870-74'; 8907-12'; 8918-20' w/2 JSPF. 11-19-02
6. RIH with tbg and pkr. Set pkr at 8665'.
7. Breakdown perfs. Swab back load to evaluate.
8. Acidize with 1000 gallons 20% NeFe w/ball sealers.
9. Swab back load.
10. Acid frac with 10000 gallons 20% NeFe.
11. Swab back load.
12. Rel pkr. POH w/tbg and pkr.
13. Run prod equip and put well on prod. 11-30-02

JUN 2003
Hobbs
OCD

I hereby certify that the information above is true and complete to the best of my knowledge and belief.

SIGNATURE Pam Inskeep TITLE Regulatory Administrator DATE 1/16/2003

Type or print name Pam Inskeep Telephone No. (915) 682-3753

(This space for State use)

ORIGINAL SIGNED BY
GARY W. WINK

JAN 22 2003

APPROVED BY OC FIELD REPRESENTATIVE II/STAFF MANAGER DATE 1/22/2003

Conditions of approval, if any:

→ A N Vacuum Atoka Morrow

OIL CONSERVATION DIVISION

DISTRICT I

P.O. Box 1980, Hobbs, NM 88240

DISTRICT II

P.O. Drawer DD, Artesia, NM 88210

DISTRICT III

1000 Rio Brazos Rd., Aztec, NM 87410

P.O. Box 2088

Santa Fe, New Mexico 87504-2088

WELL LOCATION AND ACREAGE DEDICATION PLAT

All Distances must be from the outer boundaries of the section

Operator BTA OIL PRODUCERS			Lease VACUUM, 9205 JV-P.Com		Well No. 1
Unit Letter L	Section 31	Township 16 SOUTH	Range 35 EAST	County LEA	
Actual Footage Location of Well: 1980 feet from the SOUTH line and 660 feet from the WEST line					
Ground Level Elev. 4024.9'	Producing Formation Abo		Pool Vacuum, North (Abo)		Dedicated Acreage: 80 Acres

- Outline the acreage dedicated to the subject well by colored pencil or hatchure marks on the plat below.
- If more than one lease is dedicated to the well, outline each and identify the ownership thereof (both as to working interest and royalty).
- If more than one lease of different ownership is dedicated to the well, have the interest of all owners been consolidated by communitization, unitization, force-pooling, etc?
☒ Yes ☐ No If answer is "yes" type of consolidation Communitization

If answer is "no" list of owners and tract descriptions which have actually been consolidated. (Use reverse side of this form necessary.)

No allowable will be assigned to the well unit all interests have been consolidated (by communitization, unitization, forced-pooling, otherwise) or until a non-standard unit, eliminating such interest, has been approved by the Division.

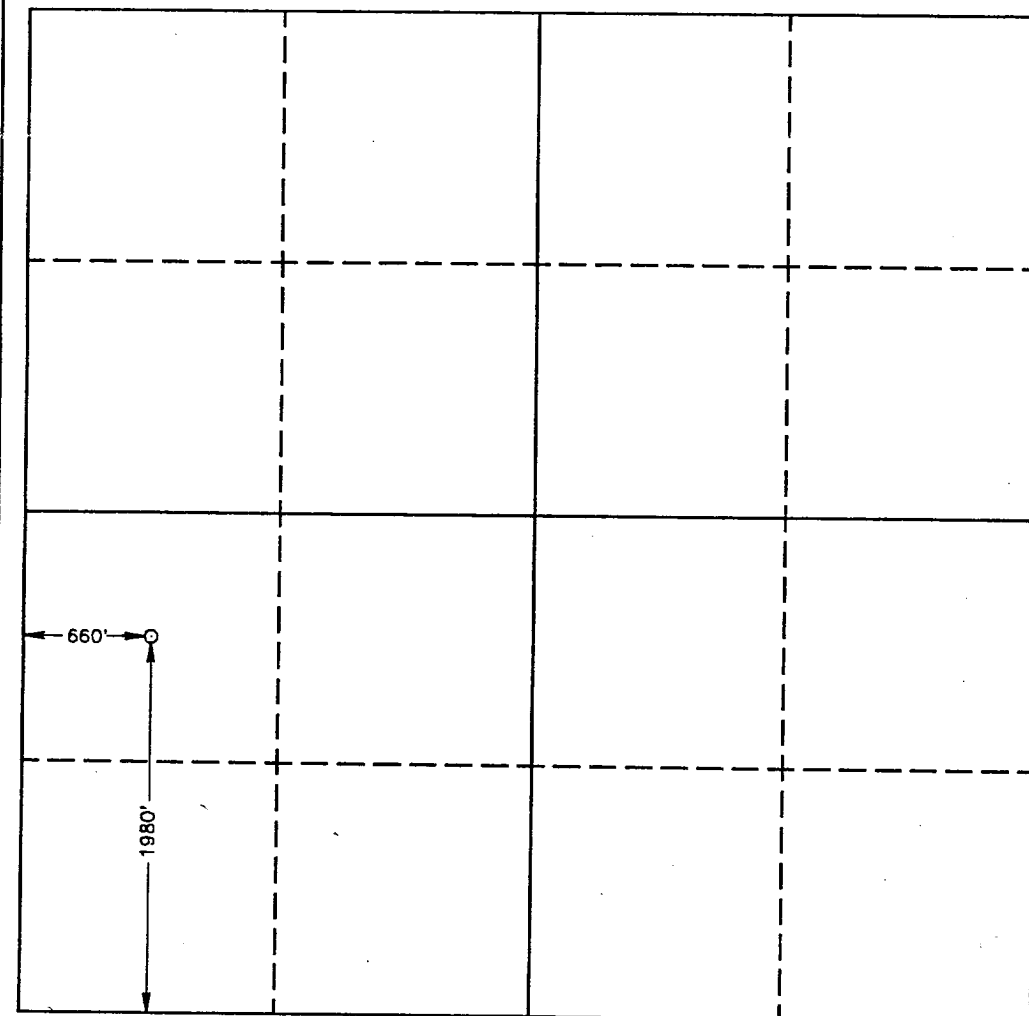

OPERATOR CERTIFICATION

I hereby certify the the information contained herein is true and complete to the best of my knowledge and belief.

Signature *Pam Inskeep*

Printed Name **Pam Inskeep**

Position **Regulatory Administrator**

Company **BTA Oil Producers**

Date **01/16/2003**

SURVEYOR CERTIFICATION

I hereby certify that the well location shown on this plat was plotted from field notes of actual surveys made by me or under my supervision, and that the same is true and correct to the best of my knowledge and belief.

Date Surveyed **June 29, 1992**

Signature & Seal of Professional Surveyor

Ronald J. Eidson
Certificate No. **JOHN W. WEST, 676**
RONALD J. EIDSON, 3239
GARRETT JONES, 7977

00 02-11-0912