

AMENDED LOCATION

Submit to Appropriate
District Office
State Lease - 6 copies
Fee Lease - 5 copies

State of New Mexico
Energy, Minerals and Natural Resources Department

Form C-101
Revised 1-1-89

OIL CONSERVATION DIVISION

DISTRICT I
P.O. Box 1980, Hobbs, NM 88240

P.O. Box 2088

Santa Fe, New Mexico 87504-2088

DISTRICT II
P.O. Drawer DD, Artesia, NM 88210

DISTRICT III
1000 Rio Brazos Rd., Aztec, NM 87410

Amended Location

API NO. (assigned by OCD on New Wells)

30-025-31621

5. Indicate Type of Lease

STATE ☒ FEE ☐

6. State Oil & Gas Lease No.

B1507-13836

APPLICATION FOR PERMIT TO DRILL, DEEPEN, OR PLUG BACK

1a. Type of Work:

DRILL ☒ RE-ENTER ☐ DEEPEN ☐ PLUG BACK ☐

b. Type of Well:

OIL WELL ☐ GAS WELL ☒ OTHER ☐ SINGLE ZONE ☒ MULTIPLE ZONE ☐

7. Lease Name or Unit Agreement Name

Vacuum, 9205 JV-P *Com*

2. Name of Operator

BTA Oil Producers

8. Well No.

1

3. Address of Operator

104 S. Pecos, Midland, TX 79701

9. Pool name or Wildcat

Vacuum, North *Atoka-Morrow*

4. Well Location

Unit Letter L : 1980 Feet From The South Line and 660 Feet From The West Line

Section 31 Township 16S Range 35E NMPM Lea County

10. Proposed Depth

12,500

11. Formation

Atoka-Morrow

12. Rotary or C.T.

Rotary

13. Elevations (Show whether DF, RT, GR, etc.)

4025' GR 4042 KB

14. Kind & Status Plug. Bond

Blanket

15. Drilling Contractor

Hondo Drlg Co. #10

16. Approx. Date Work will start

7-1-92

17.

PROPOSED CASING AND CEMENT PROGRAM

SIZE OF HOLE	SIZE OF CASING	WEIGHT PER FOOT	SETTING DEPTH	SACKS OF CEMENT	EST. TOP
17-1/2	13-3/8	54.5	400	450 sx	Surface
11	8-5/8	32.0	4800	1800 sx	Surface
7-7/8	5-1/2	17&20	12500	2000 sx	+ 4000'

BOP - 3000 psi - Attached Schematic

There are no producing wells in this quarter-quarter -- see attached county map

IN ABOVE SPACE DESCRIBE PROPOSED PROGRAM: IF PROPOSAL IS TO DEEPEN OR PLUG BACK, GIVE DATA ON PRESENT PRODUCTIVE ZONE AND PROPOSED NEW PRODUCTIVE ZONE. GIVE BLOWOUT PREVENTER PROGRAM, IF ANY.

I hereby certify that the information above is true and complete to the best of my knowledge and belief.

SIGNATURE *Dorothy Houghton* TITLE Regulatory Administrator DATE 6-30-92

TYPE OR PRINT NAME Dorothy Houghton TELEPHONE NO. 915-682-3753

(This space for State Use)

ORIGINAL SIGNED BY JERRY SEXTON
DISTRICT I SUPERVISOR

JUL 02 '92

APPROVED BY _____ TITLE _____ DATE _____

CONDITIONS OF APPROVAL, IF ANY:

OIL CONSERVATION DIVISION

P.O. Box 2088

Santa Fe, New Mexico 87504-2088

DISTRICT I

P.O. Box 1980, Hobbs, NM 88240

DISTRICT II

P.O. Drawer DD, Artesia, NM 88210

DISTRICT III

1000 Rio Brazos Rd., Artesia, NM 87410

WELL LOCATION AND ACREAGE DEDICATION PLAT

All Distances must be from the outer boundaries of the section

Operator BTA OIL PRODUCERS		Lease 9205 JV-P VACUUM Com		Well No. 1
Unit Letter L	Section 31	Township 16 SOUTH	Range 35 EAST	County LEA

Actual Footage Location of Well:

1980 feet from the SOUTH line and		660 feet from the WEST line	
Ground Level Elev. 4024.9'	Producing Formation Atoka-Morrow	Pool Vacuum, North	Dedicated Acreage: 313.56 320 Acres

1. Outline the acreage dedicated to the subject well by colored pencil or hatchure marks on the plat below.

2. If more than one lease is dedicated to the well, outline each and identify the ownership thereof (both as to working interest and royalty).

3. If more than one lease of different ownership is dedicated to the well, have the interest of all owners been consolidated by communitization, unitization, force-pooling, etc.?

☒ Yes ☐ No If answer is "yes" type of consolidation Communitization

If answer is "no" list of owners and tract descriptions which have actually been consolidated. (Use reverse side of this form necessary.)

No allowable will be assigned to the well unit all interests have been consolidated (by communitization, unitization, force-pooling, otherwise) or until a non-standard unit, eliminating such interest, has been approved by the Division.

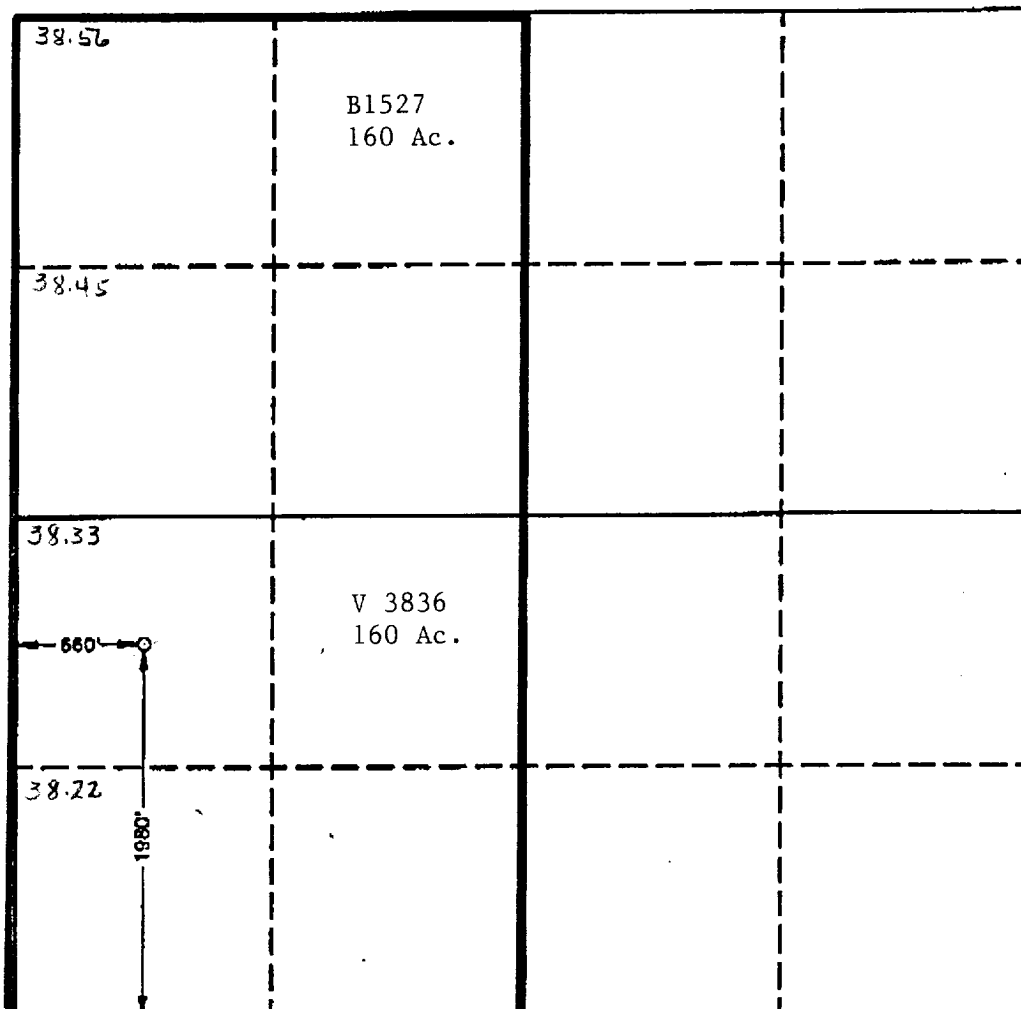

OPERATOR CERTIFICATION

I hereby certify the the information contained herein is true and complete to the best of my knowledge and belief.

Signature

Printed Name

Dorothy Houghton

Position

Regulatory Administrator

Company

BTA Oil Producers

Date

6-30-92

SURVEYOR CERTIFICATION

I hereby certify that the well location shown on this plat was plotted from field notes of actual surveys made by me or under my supervision, and that the same is true and correct to the best of my knowledge and belief.

Date Surveyed

June 29, 1992

Signature & Seal of
Professional Surveyor

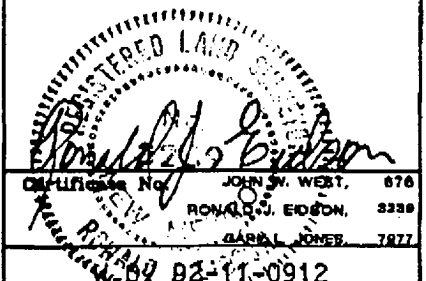

B T A O I L P R O D U C E R S

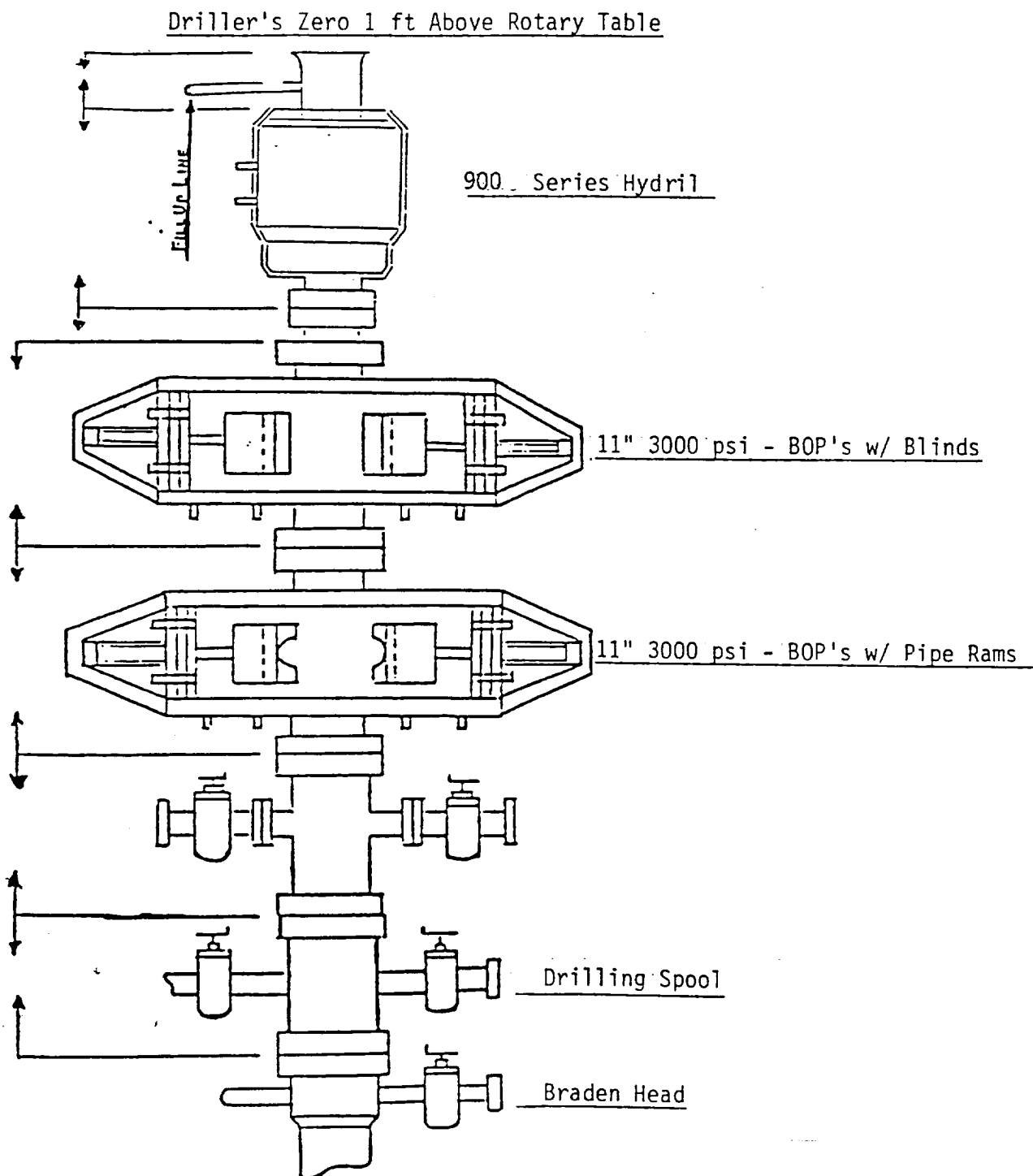

BTA Oil Producers
9205 JV-P Vacuum
Well #1
1,980' **FSL** & 660' FWL
Section 31, T-16-S, R-35-E
Lea County, New Mexico
Vacuum North (Atoka Morrow) Field