

Santa Fe, New Mexico

ROBERT L. PIERCE, O. C. C.

## NOTICE OF INTENTION TO DRILL

Form G-101  
Revised (12/1/55)

JUN 7 8 AM '66

Notice must be given to the District Office of the Oil Conservation Commission and approval obtained before drilling or recompletion begins. If changes in the proposed plan are considered advisable, a copy of this notice showing such changes will be returned to the sender. Submit this notice in QUINTUPPLICATE. One copy will be returned following approval. See additional instructions in Rules and Regulations of the Commission. If State Land submit 6 Copies Attach Form G-128 in triplicate to first 3 copies of form G-101

Midland, Texas

(Place)

June 3, 1966

(Date)

OIL CONSERVATION COMMISSION  
SANTA FE, NEW MEXICO

Gentlemen:

You are hereby notified that it is our intention to commence the drilling of a well to be known as

Greathouse, Pierce &amp; Davis

(Company or Operator)

Esther McClure Barnes

(Lease)

Well No. 1, in A The well is

(Unit)

located 660 feet from the North line and 660 feet from the

East

Line of Section 34, T. 14-S, R. 32-E, NMPM.

(GIVE LOCATION FROM SECTION LINE) Wildcat Pool, Lea County

If State Land the Oil and Gas Lease is No.

If patented land the owner is Esther McClure Barnes

Address Crossroads, New Mexico

We propose to drill well with drilling equipment as follows: Rotary

The status of plugging bond is in effect

Drilling Contractor

We intend to complete this well in the Devonian

formation at an approximate depth of 13,000 feet.

## CASING PROGRAM

We propose to use the following strings of Casing and to cement them as indicated:

Size of Hole	Size of Casing	Weight per Foot	New or Second Hand	Depth	Sacks Cement
17"	13-3/8		Used	385'	385
11"	8-5/8	28 & 32#	New	4850'	300
	4 1/2		New	13,000	Cover Pipe

If changes in the above plans become advisable we will notify you immediately.

ADDITIONAL INFORMATION (If recompletion give full details of proposed plan of work.)

Approved: \_\_\_\_\_, 19\_\_\_\_

Except as follows:

Sincerely yours,

Greathouse, Pierce &amp; Davis

(Company or Operator)

By: J. L. Davis

Position: Partner

Send Communications regarding well to

Name: Greathouse, Pierce &amp; Davis

Address: 609 Midland National Bank Bldg.

OIL CONSERVATION COMMISSION

By: Joe R. Kimey

Valid after Sept 10, 1966

NEW MEXICO OIL CONSERVATION COMMISSION  
WELL LOCATION AND ACREAGE DEDICATION PLAT

Form C-102  
Supersedes C-128  
Effective 1-1-65

HOBBS OFFICE O. C. C.

All distances must be from the outer boundaries of the Section.

Operator <b>GREATHOUSE, PIERCE &amp; DAVIS</b>		Lease <b>JUN 3 11 29 AM '66</b>		Well No. <b>1</b>
Unit Letter <b>A</b>	Section <b>34</b>	Township <b>14 SOUTH</b>	Range <b>38 EAST</b>	County <b>LEA</b>
Actual Footage Location of Well: <b>660</b> feet from the <b>NORTH</b> line and <b>660</b> feet from the <b>EAST</b> line				
Ground Level Elev. <b>3752.3</b>	Producing Formation <b>Dev.</b>	Pool <b>Wildcat</b>	Dedicated Acreage: <b>40</b> Acres	

1. Outline the acreage dedicated to the subject well by colored pencil or hatchure marks on the plat below.
2. If more than one lease is dedicated to the well, outline each and identify the ownership thereof (both as to working interest and royalty).
3. If more than one lease of different ownership is dedicated to the well, have the interests of all owners been consolidated by communitization, unitization, force-pooling, etc?

☐ Yes ☐ No If answer is "yes," type of consolidation \_\_\_\_\_

If answer is "no," list the owners and tract descriptions which have actually been consolidated. (Use reverse side of this form if necessary.) \_\_\_\_\_

No allowable will be assigned to the well until all interests have been consolidated (by communitization, unitization, forced-pooling, or otherwise) or until a non-standard unit, eliminating such interests, has been approved by the Commission.

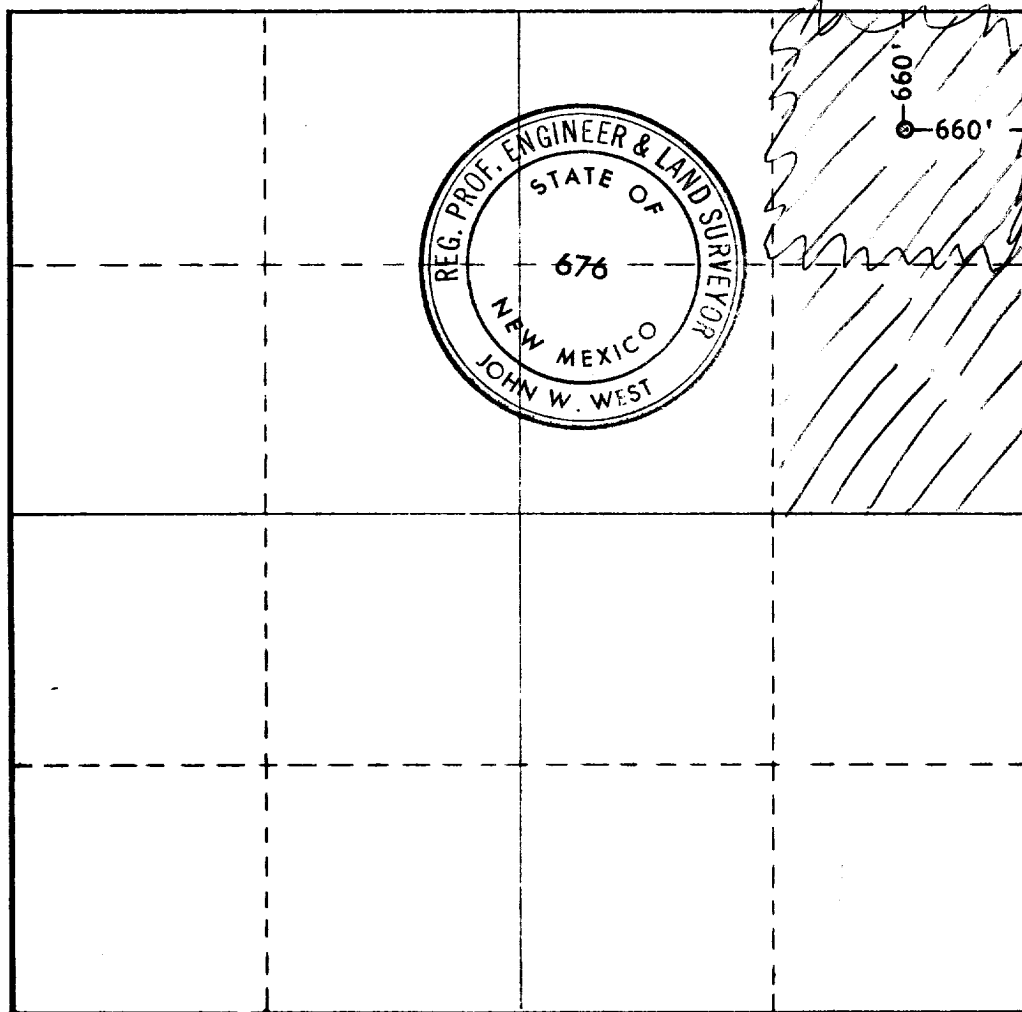

CERTIFICATION

I hereby certify that the information contained herein is true and complete to the best of my knowledge and belief.

Name **J. L. Pierce**  
**Partner**

Position  
**Greathouse, Pierce & Davis**

Company  
**June 3, 1966**

Date

I hereby certify that the well location shown on this plat was plotted from field notes of actual surveys made by me or under my supervision, and that the same is true and correct to the best of my knowledge and belief.

Date Surveyed  
**JUNE 2, 1966**

Registered Professional Engineer and/or Land Surveyor

Certificate No. **676**

