

**NEW MEXICO OIL CONSERVATION COMMISSION
WELL LOCATION AND ACREAGE DEDICATION PLAT**

Form C-102
Supersedes C-128
Effective 1-4-65

All distances must be from the outer boundaries of the Section.

Operator DELAWARE APACHE CORP.		Lease JUL 20 11 44 AM '66 STOKES		Well No. 1
Unit Letter 23	Section 16 SOUTH	Township 35 EAST	County LEA	
Actual Footage Location of Well: 660 feet from the SOUTH line and 1980 feet from the EAST line				
Ground Level Elev. 3964.2	Producing Formation Pennsylvanian	Pool Shoe Bar	Dedicated Acreage: Forty Acres	

1. Outline the acreage dedicated to the subject well by colored pencil or hachure marks on the plat below.
2. If more than one lease is dedicated to the well, outline each and identify the ownership thereof (both as to working interest and royalty).
3. If more than one lease of different ownership is dedicated to the well, have the interests of all owners been consolidated by communitization, unitization, force-pooling, etc?

☐ Yes ☐ No If answer is "yes," type of consolidation _____

If answer is "no," list the owners and tract descriptions which have actually been consolidated. (Use reverse side of this form if necessary.) _____

No allowable will be assigned to the well until all interests have been consolidated (by communitization, unitization, forced-pooling, or otherwise) or until a non-standard unit, eliminating such interests, has been approved by the Commission.

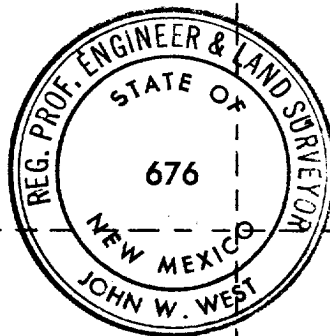

CERTIFICATION

I hereby certify that the information contained herein is true and complete to the best of my knowledge and belief.

Name _____
 Position **Area Engineer**
 Company **Delaware Apache Corporation**
 Date **July 12, 1966**

I hereby certify that the well location shown on this plat was plotted from field notes of actual surveys made by me or under my supervision, and that the same is true and correct to the best of my knowledge and belief.

Date Surveyed **JULY 9, 1966**
 Registered Professional Engineer and/or Land Surveyor

 Certificate No. **NM PE & LS No. 676**

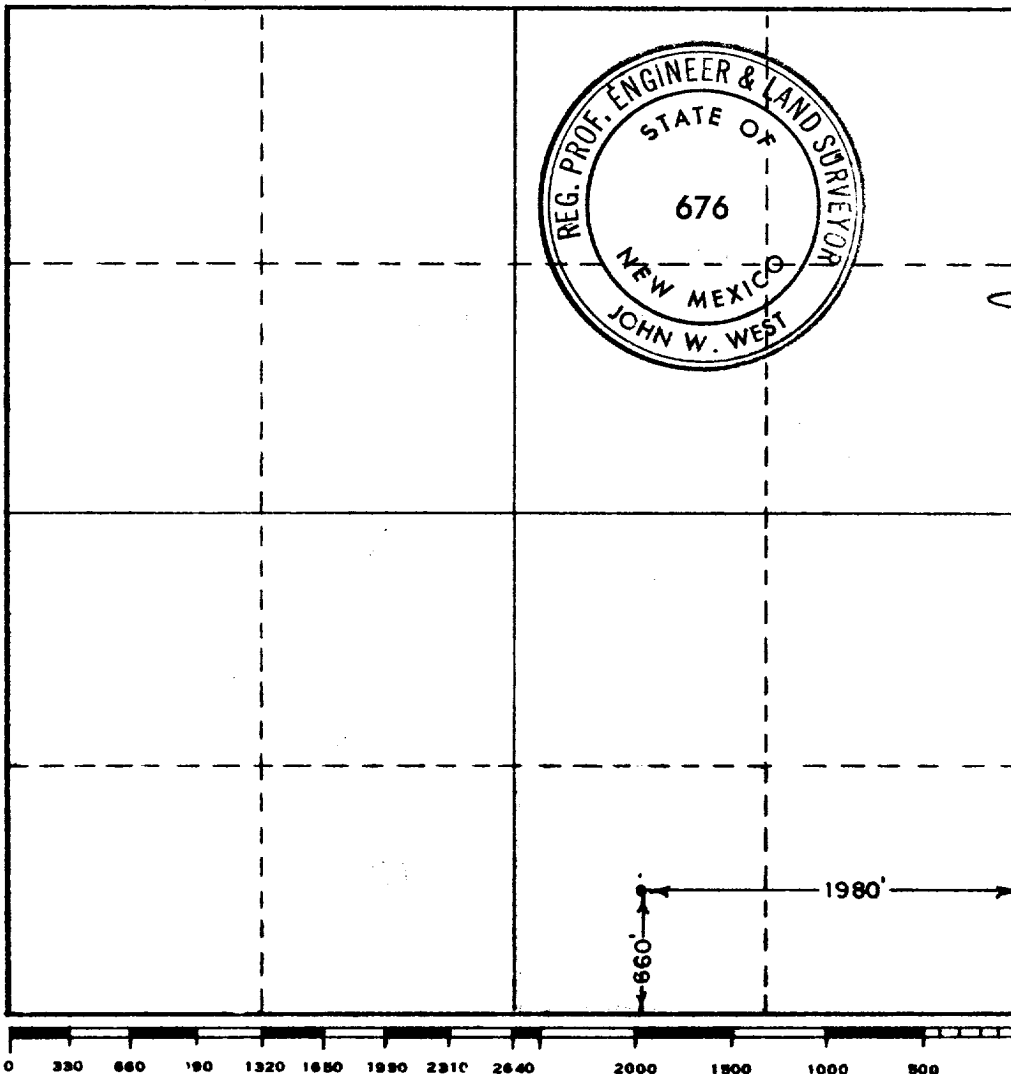

COUNTY	LEA	FIELD	Shoe Bar-Penn.	STATE	NM
OPR	DELAWARE APACHE CORPORATION				MAP
1 Stokes					
Sec. 23, T-16-S, R-35-E					
660' FSL, 1980' FEL of Sec.				CO-ORD	MN 2182
Spd 7-26-66					
Cmp 9-1-66		CLASS		EL	
		FORMATION	DATUM	FORMATION	DATUM
CSG & SX - TUBING					
11 3/4" 414' 400					
8 5/8" 4800' 400					
LOGS EL GR RA IND HC A					
		TD 10630'			
PLUGGED & ABANDONED					

Distribution limited and publication prohibited by subscribers' agreement.
Reproduction rights reserved by Williams & Lee Scouting Service, Inc.

CONT. Moran Drilg. Co. PROP DEPTH 10700' TYPE
DATE

F.R. 7-28-66
PD 10,700' - Pennsylvanian
Contractor - Moran Drilg. Co.
8-1-66 Drilg. 4423' anhy.
8-8-66 Drilg. 5910' 1m.
8-15-66 Drilg. 7936' 1m.
8-22-66 Drilg. 10047' 1m.
8-29-66 TD 10630', prep to log.
DST 10227-318', open 1 hr 45 mins,
Rec 30' DM, 180' Salt Wtr CM + 210'
Salt Wtr,
30 min ISIP 3646#, FP 92-232#.
30 min FSIP 3004#, FP 4611#.
9-6-66 TD 10630', PLUGGED & ABANDONED.
SP DST 6010-6103', open 1 hr,
Rec 92' Salt Wtr CM + 560' Muddy Salt Wtr,
30 min ISIP 2253#, FP 153-243#,
1 hr FSIP 2099#.

LEA Shoe Bar-Penn. NM
DELAWARE APACHE CORP., #1 Stokes

Sec. 23-16S-35E
Page #2

9-6-66

Continued

LOG TOPS: Abc 8198', Wolfcamp Lime
9599', Wolfcamp Porosity 10344', Bough
"E" 10596'.

COUNTY	LEA	FIELD	Shoe Bar-Penn.	STATE	NM
OPR	DELAWARE APACHE CORPORATION				MAP
1 Stokes					
Sec. 23, T-16-S, R-35-E					
660' FSL, 1980' FEL of Sec.				CO-ORD	
Spd 7-26-66				MN 2182	
Cmp 9-1-66		CLASS		EL	
		FORMATION	DATUM	FORMATION	DATUM
CSG & SX - TUBING					
11 3/4" 414' 400					
8 5/8" 4800' 400					
LOGS EL GR RA IND HC A					
		TD 10630'			
PLUGGED & ABANDONED					

Distribution limited and publication prohibited by subscribers' agreement.
Reproduction rights reserved by Williams & Lee Scouting Service, Inc.

CONT. Moran Drlg. Co. PROP DEPTH 10700' TYPE
DATE

F.R. 7-28-66
PD 10,700' - Pennsylvanian
Contractor - Moran Drlg. Co.
8-1-66 Drlg. 4423' anhy.
8-8-66 Drlg. 5910' 1m.
8-15-66 Drlg. 7936' 1m.
8-22-66 Drlg. 10047' 1m.
8-29-66 TD 10630', prep to log.
DST 10227-318', open 1 hr 45 mins.
Rec 30' DM, 180' Salt Wtr CM + 270'
Salt Wtr,
30 min ISIP 3646#, FP 92-232#,
30 min FSIP 3004#, HP 4611#.
9-6-66 TD 10630', PLUGGED & ABANDONED.
SP DST 6010-6103', open 1 hr.
Rec 92' Salt Wtr CM + 560' Muddy Salt Wtr,
30 min ISIP 2253#, FP 153-243#,
1 hr FSIP 2099#.

LEA Shoe Bar-Penn. RM
DELAWARE APACHE CORP., #1 Stokes

Sec. 23-16S-35E
Page #2

9-6-66

Continued

LOG TOPS: Abo 8198', Wolfcamp Lime
9599', Wolfcamp Porosity 10344', Bough
"B" 10596'.