

NEW MEXICO OIL CONSERVATION COMMISSION
WELL LOCATION AND ACREAGE DEDICATION PLAT
HOBBS OFFICE O. C. C.

Form C-122
Supersedes C-128
Effective 12-65

All distances must be from the outer boundaries of the Section

BURLESON & HUFF			Dec 19 7 43 AM '66		Sheet 1
Section C	Section 2	Township 16 SOUTH	Range 32 EAST	County LEA	
Depth of Well: 990 feet from the NORTH line and 2310 feet from the WEST line					
Surface Elevation 4310.1	Producing Formation Wolfcamp	No. No. Anderson Ranch		Estimated Acreage 50 30	

1. Outline the acreage dedicated to the subject well by colored pencil or hachure marks on the plat below.
2. If more than one lease is dedicated to the well, outline each and identify the ownership thereof (both as to working interest and royalty).
3. If more than one lease of different ownership is dedicated to the well, have the interests of all owners been consolidated by communitization, unitization, force-pooling, etc?

☐ Yes ☒ No If answer is "yes," type of consolidation _____

If answer is "no," list the owners and tract descriptions which have actually been consolidated (use reverse side of this form if necessary.) _____

No allowable will be assigned to the well until all interests have been consolidated (by communitization, unitization, forced-pooling, or otherwise) or until a non-standard unit, eliminating such interests, has been approved by the Commission.

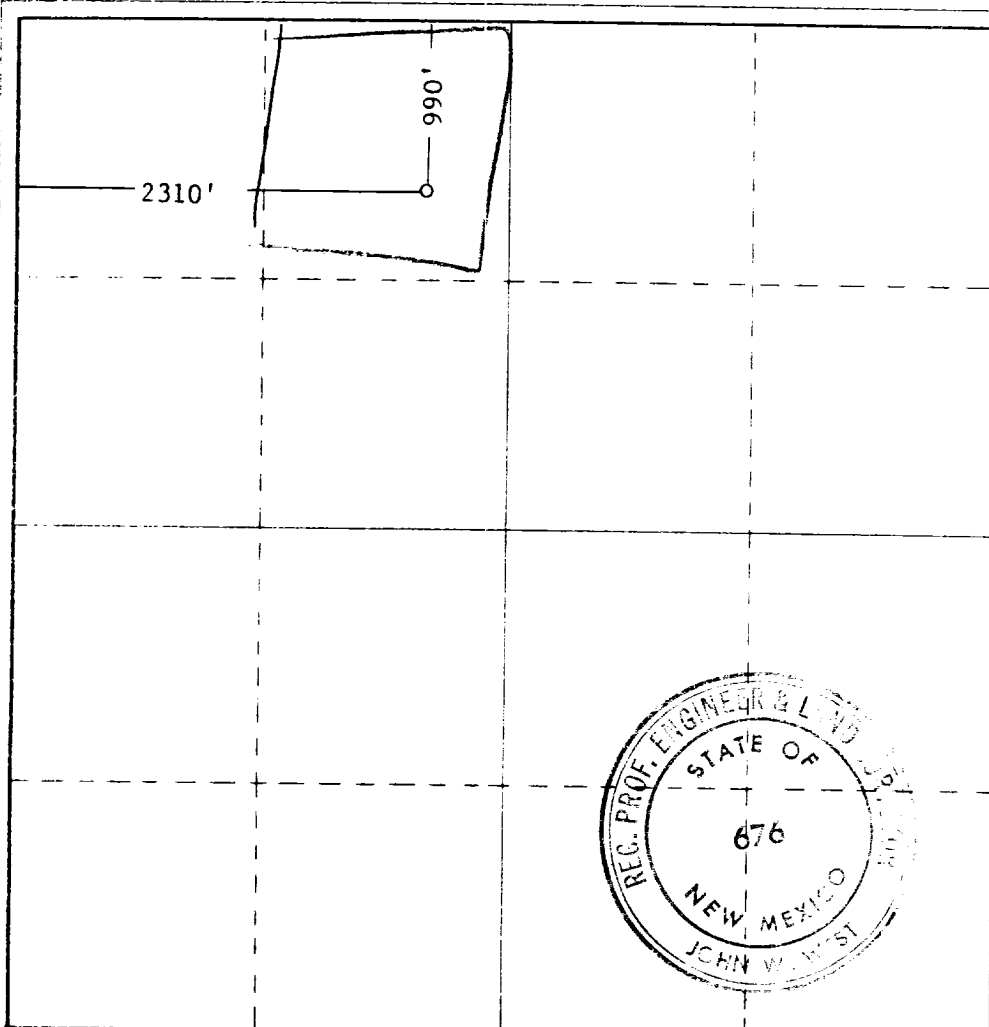

CERTIFICATION

I hereby certify that the information contained herein is true and complete to the best of my knowledge and belief.

K. D. McShane
Agent

Burleson & Huff

12-15-66

I hereby certify that the well location shown on this plat was plotted from field notes of actual surveys made by me or under my supervision and that the same is true and correct to the best of my knowledge and belief.

Date Surveyed
DECEMBER 10, 1966

Registered Professional Engineer and Land Surveyor

John W. West
Certificate No. **676**

