

COUNTY	LEA	FIELD	Morton, W.	STATE	NM
OPR	UNION OIL CO. OF CALIF.				MAP
	1 Reed				
	Sec. 12, T-15-S, R-34-E				
	766' FSL, 2086' FWL on Sec.				CO-ORD
					30-025-22162
	Spd 6-30-67				
	Cmp 8-16-67				
			CLASS	EL [REDACTED]	
			FORMATION	DATUM	
CSG & SX - TUBING			FORMATION	DATUM	
11 3/4" 354' 250					
8 5/8" 4605' 400					
5 1/2" 10499' 350					
LOGS EL GR RA IND HC A					
			TD 10500', FBD 10445'		
IP Lower Wolfcamp Perfs 10423-428' Flwd 392 EOPD. Pot. Based on 24 hr test thru 15/64" chk., TP 1050#, gravity 46.7.					

Distribution limited and publication prohibited by subscribers' agreement.
 Reproduction rights reserved by Williams & Lee Scouting Service, Inc.

CONT. DATE PROP DEPTH 10,600' TYPE RT

F.R. 6-22-67
 PD 10,600' - Wolfcamp
 7-3-67 Drlg. 1500'.
 7-10-67 Drlg. 4545' anhy.
 7-17-67 Drlg. 6690'.
 7-24-67 Drlg. 8400'.
 7-31-67 Drlg. 10091'.
 8-7-67 TD 10404', prep core.
 Cored 10370-404', ran 34' being:
 2' xlyn lm., w/PPP & show;
 11 1/2' lm., w/some vuggy pore & show;
 2 1/2' lm., w/NS;
 12' limy sh., w/NS;
 6' lm., w/Good vuggy pore & show.
 SAMPLE: SA 4545', Ato 8010'.

8-14-67 TD 10500', prep perf.
Cored 10404-451', rec 46' being:
11½' lm., w/good vuggy pore;
3½' lm., w/NS;
4½' lm., w/good vuggy pore & stain;
3' lm., w/NS;
23½' lm., w/good pore & fluor.
8-21-67 TD 10500', PBD 10445', COMPLETE
Perf @ 10459' W/4 SPF
Acid (10459') 500 gals.
Flwd 160 BO + 360 BW in 20 hrs thru
1" chk., TP 75-125#.
Set BP @ 10445'
Perf 10423-428' W/2 SPF
Acid (10423-428') 500 gals.

LOG TOPS: Yates 2943', Queen 3780', Glorieta
6200', Abc 8085', Wolfcamp 9540'.

COUNTY LEA FIELD Morton STATE NM 30-025-22162 OWWO
 OPR UNION OIL CO. OF CALIFORNIA MAP
1 Reed
Sec 12, T-15-S, R-34-E CO-ORD
766' FSL, 2086' FWL of Sec.

Re-Cmp 8-21-68		CLASS		EL
CSG & SX - TUBING	FORMATION	DATUM	FORMATION	DATUM
11 3/4" at 354' w/250 sx				
8 5/8" at 4605' w/400 sx				
5 1/2" at 10,499' w/350 sx				
LOGS EL GR RA IND HC A				
	TD 10,500'			

(Lower Wolfcamp) Perf 10,322-405' NO NEW POTENTIAL

Distribution limited and publication prohibited by subscribers' agreement.
 Reproduction rights reserved by Williams & Lee Scouting Service, Inc.

CONT. DATE PROP DEPTH 10,405' TYPE WO

12-9-68 F.R.C. 12-12-68
 PD 10,405' WO
 (Orig. completed 8-16-67 thru perfs
 10,423-428', OTD 10,500', OPB 10,445')
 TD 10,500'; COMPLETE
 Sqzd perfs 10,423-428' w/100 sx
 Perf 10,398-405'
 Acid (10,398-405') 2000 gals (15%)
 Perf 10,322-334'
 Acid (10,322-334') 1500 gals (15%)
 Perf 10,362-374'
 Acid (10,362-374') 2500 gals (15%)
 12-12-68 COMPLETION REPORTED

NEW MEXICO OIL CONSERVATION COMMISSION
WELL LOCATION AND ACREAGE DEDICATION PLAT

Form C-162
Supersedes C-128
Effective 1-1-65

All distances must be from the outer boundaries of the Section.

Operator Union Oil Company of California			Lease Reed		Well No. 1
Unit Letter N	Section 12	Township 15-S	Range 34-E	County Lea	
Actual Footage Location of Well: 766 feet from the South line and 2086 feet from the West line					
Ground Level Elev. 4059.8'	Producing Formation Wolfcamp		Pool Morton Wolfcamp		Dedicated Acreage: 80 Acres

1. Outline the acreage dedicated to the subject well by colored pencil or hachure marks on the plat below.
2. If more than one lease is dedicated to the well, outline each and identify the ownership thereof (both as to working interest and royalty).
3. If more than one lease of different ownership is dedicated to the well, have the interests of all owners been consolidated by communitization, unitization, force-pooling, etc?

☐ Yes ☐ No If answer is "yes," type of consolidation _____

If answer is "no," list the owners and tract descriptions which have actually been consolidated. (Use reverse side of this form if necessary.) _____

No allowable will be assigned to the well until all interests have been consolidated (by communitization, unitization, forced-pooling, or otherwise) or until a non-standard unit, eliminating such interests, has been approved by the Commission.

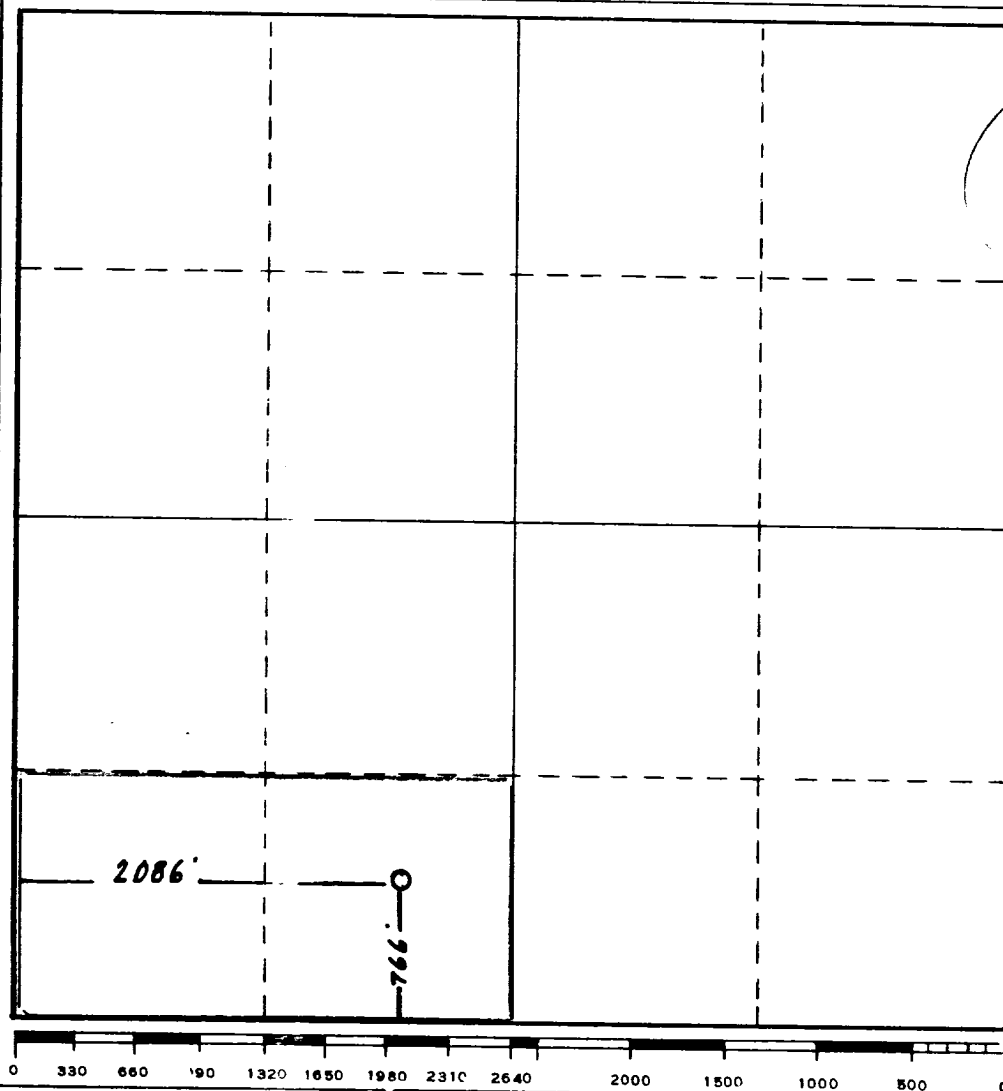

CERTIFICATION

I hereby certify that the information contained herein is true and complete to the best of my knowledge and belief.

Name

J.R. Hughes

Position

District Drilling Supt.

Company

Union Oil Co. of Calif.

Date

Sept. 23, 1985

I hereby certify that the well location shown on this plat was plotted from field notes of actual surveys made by me or under my supervision, and that the same is true and correct to the best of my knowledge and belief.

Date Surveyed

Registered Professional Engineer and/or Land Surveyor

Certificate No.