

NO. OF COPIES RECEIVED	
DISTRIBUTION	
SANTA FE	
FILE	
U.S.G.S.	
LAND OFFICE	
OPERATOR	

NEW MEXICO OIL CONSERVATION COMMISSION

Form C-101
Revised 1-1-65

5A. Indicate Type of Lease	
STATE <input checked="" type="checkbox"/>	FEE <input type="checkbox"/>
5. State Oil & Gas Lease No.	
E-9538	

APPLICATION FOR PERMIT TO DRILL, DEEPEN, OR PLUG BACK

1a. Type of Work				7. Unit Agreement Name	
b. Type of Well OIL WELL <input checked="" type="checkbox"/> GAS WELL <input type="checkbox"/> OTHER <input type="checkbox"/>				8. Farm or Lease Name	
2. Name of Operator				9. Well No.	
Forest Oil Corporation				3	
3. Address of Operator				10. Field and Pool, or Wildcat	
Post Office Box 4486 Midland, Texas 79701				Wildcat	
4. Location of Well				12. County	
UNIT LETTER K LOCATED 1650 FEET FROM THE South LINE				Lea	
AND 2310 FEET FROM THE West LINE OF SEC. 26 TWP. 16-S RGE. 33-E NMPM					
19. Proposed Depth				19A. Formation	
11,600				Pennsylvanian	
20. Rotary or C.T.				Rotary	
21. Elevations (Show whether DF, RT, etc.)		21A. Kind & Status Plug. Bond		21B. Drilling Contractor	
4170 Ground Level		\$10,000 Blanket		Loffland Brothers	
22. Approx. Date Work will start		11-16-67			

BOND PROPOSED CASING AND CEMENT PROGRAM

SIZE OF HOLE	SIZE OF CASING	WEIGHT PER FOOT	SETTING DEPTH	SACKS OF CEMENT	EST. TOP
17 1/2"	13 3/8"	48 lb.	345'	325	Surface
12 1/4"	8 5/8"	24 lb.	2550'		
		32 lb.	2550-4500'	2500	Surface
7 5/8"	5 1/2"	17 lb.	10,500'		
		20 lb.	10,500-11,600'	400	Surface

Drill from surface to total depth with rotary tools. Drill with brine water to 4500' and set intermediate casing to be set below top of San Andres. Low solid fresh water mud to total depth. Test any potentially productive shows. Run Gamma Ray-Sonic, Laterolog from surface to total depth. Microlaterolog thru potential pay zones. Anticipated formation tops: Anhydrite 1500', Yates 2790', San Andres 4462', Abo 7970', Wolfcamp 9910', Kemnitz 10,670', Penn. 11,170', Seaman 11,440'.

THE COMMISSION MUST BE NOTIFIED
24 HOURS PRIOR TO RUNNING
CASING.

IN ABOVE SPACE DESCRIBE PROPOSED PROGRAM: IF PROPOSAL IS TO DEEPEN OR PLUG BACK, GIVE DATA ON PRESENT PRODUCTIVE ZONE AND PROPOSED NEW PRODUCTIVE ZONE. GIVE BLOWOUT PREVENTER PROGRAM, IF ANY.

I hereby certify that the information above is true and complete to the best of my knowledge and belief.

Signed [Signature] Title Assistant Sec. Conservation Date 11/15/67

(This space for State Use)

APPROVED BY [Signature] TITLE [Signature] DATE [Signature]

CONDITIONS OF APPROVAL, IF ANY:

NEW MEXICO OIL CONSERVATION COMMISSION
WELL LOCATION AND ACREAGE DEDICATION PLAT

Form C-102
Supersedes C-128
Effective 1-1-65

All distances must be from the outer boundaries of the Section.

Operator Forest Oil Corporation		Lease State "A"		Well No. 3
Unit Letter K	Section 26	Township 16-South	Range 33-East	County Lea
Actual Footage Location of Well: 1650 feet from the South line and 2310 feet from the West line				
Ground Level Elev. 4170	Producing Formation Kennitz-Seaman		Pool Wildcat	Dedicated Acreage: 80 Acres

1. Outline the acreage dedicated to the subject well by colored pencil or hachure marks on the plat below.
2. If more than one lease is dedicated to the well, outline each and identify the ownership thereof (both as to working interest and royalty).
3. If more than one lease of different ownership is dedicated to the well, have the interests of all owners been consolidated by communitization, unitization, force-pooling, etc?

☐ Yes ☐ No If answer is "yes," type of consolidation _____

If answer is "no," list the owners and tract descriptions which have actually been consolidated. (Use reverse side of this form if necessary.) _____

No allowable will be assigned to the well until all interests have been consolidated (by communitization, unitization, forced-pooling, or otherwise) or until a non-standard unit, eliminating such interests, has been approved by the Commission.

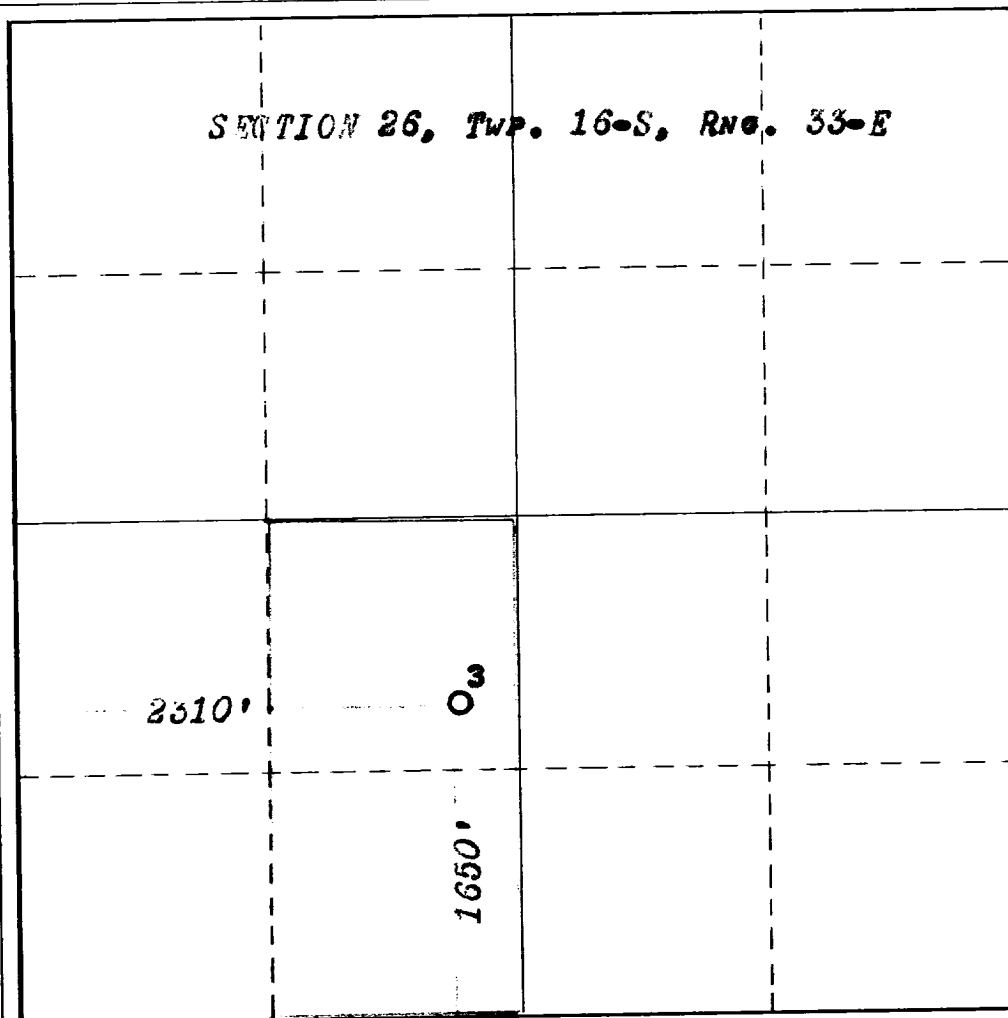

CERTIFICATION

I hereby certify that the information contained herein is true and complete to the best of my knowledge and belief.

Name
Calvin G. Campbell
Position
Assistant Div. Landman
Company
Forest Oil Corporation
Date
November 13, 1967

I hereby certify that the well location shown on this plat was plotted from field notes of actual surveys made by me or under my supervision, and that the same is true and correct to the best of my knowledge and belief.

Date Surveyed
Nov. 11, 1967
Registered Professional Engineer
and/or Land Surveyor

Certificate No.
754

0 330 660 990 1320 1650 1980 2310 2640 2000 1500 1000 500