

NO. OF COPIES RECEIVED	
DISTRIBUTION	
SANTA FE	
FILE	
U.S.G.S.	
LAND OFFICE	
OPERATOR	

NEW MEXICO OIL CONSERVATION COMMISSION

Form C-101
Revised 1-1-65

5A. Indicate Type of Lease	
STATE <input checked="" type="checkbox"/>	FEE <input type="checkbox"/>
5. State Oil & Gas Lease No. K-3030	

APPLICATION FOR PERMIT TO DRILL, DEEPEN, OR PLUG BACK

1a. Type of Work DRILL <input checked="" type="checkbox"/> DEEPEN <input type="checkbox"/> PLUG BACK <input type="checkbox"/>		7. Unit Agreement Name	
b. Type of Well OIL WELL <input checked="" type="checkbox"/> GAS WELL <input type="checkbox"/> OTHER <input type="checkbox"/>		8. Farm or Lease Name Montieth State	
2. Name of Operator SOUTHWEST PRODUCTION CORPORATION		9. Well No. 2	
3. Address of Operator P. O. Box 936, Roswell, New Mexico 88201		10. Field and Pool, or Wildcat Lovington Penn, East	
4. Location of Well UNIT LETTER K LOCATED 1980' FEET FROM THE South LINE AND 1995 FEET FROM THE West LINE OF SEC. 19 TWP. 16S RGE. 37E NMPM		12. County Lea	
19. Proposed Depth 11,400'		19A. Formation Penn	
20. Rotary or C.T. Rotary		21. Elevations (Show whether DF, RT, etc.) 3842 GR	
21A. Kind & Status Plug. Bond \$10,000 Blanket		21B. Drilling Contractor	
22. Approx. Date Work will start February 15, 1968			

23.

PROPOSED CASING AND CEMENT PROGRAM

SIZE OF HOLE	SIZE OF CASING	WEIGHT PER FOOT	SETTING DEPTH	SACKS OF CEMENT	EST. TOP
17"	11-3/4"	23#	350'	250	circ
11"	8-5/8"	24 & 32#	4700'	350	2500'
7-7/8"	5-1/2"	20#	11,400'	600	10,000'

Blowout preventer will be used after intermediate casing is set.

APPROVED AND

5-19-68

11 3/4

IN ABOVE SPACE DESCRIBE PROPOSED PROGRAM: IF PROPOSAL IS TO DEEPEN OR PLUG BACK, GIVE DATA ON PRESENT PRODUCTIVE ZONE AND PROPOSED NEW PRODUCTIVE ZONE. GIVE BLOWOUT PREVENTER PROGRAM, IF ANY.

I hereby certify that the information above is true and complete to the best of my knowledge and belief.

Signed *W. E. Harward* Title Exploration Manager Date 2-12-68

(This space for State Use)

APPROVED BY *J. E. Roney* TITLE DATE

CONDITIONS OF APPROVAL, IF ANY:

**NEW MEXICO OIL CONSERVATION COMMISSION
WELL LOCATION AND ACREAGE DEDICATION PLAT**

Form C-102
Supersedes C-128
Effective 1-1-65

All distances must be from the outer boundaries of the Section.

Operator SOUTHWEST PRODUCTION CORP.			Lease MONTIETH STATE		Well No. 2
Unit Letter K	Section 19	Township 16 SOUTH	Range 37 EAST	County LEA	
Actual Footage Location of Well: 1980 feet from the SOUTH line and 1995.1 feet from the WEST line					
Ground Level Elev. 3842	Producing Formation Penn	Pool East Lovington Penn		Dedicated Acreage: 40 Acres	

1. Outline the acreage dedicated to the subject well by colored pencil or hatchure marks on the plat below.
2. If more than one lease is dedicated to the well, outline each and identify the ownership thereof (both as to working interest and royalty).
3. If more than one lease of different ownership is dedicated to the well, have the interests of all owners been consolidated by communitization, unitization, force-pooling, etc?

☐ Yes ☐ No If answer is "yes," type of consolidation _____

If answer is "no," list the owners and tract descriptions which have actually been consolidated. (Use reverse side of this form if necessary.) _____

No allowable will be assigned to the well until all interests have been consolidated (by communitization, unitization, forced-pooling, or otherwise) or until a non-standard unit, eliminating such interests, has been approved by the Commission.

**NOTE: GROUND ELEVATION AT LOCATION
IS 2.9 FEET HIGHER THAN TENNECO
OIL CO. STATE "Q" IN NE ¼ SW ¼
SEC. 30, T 16 S, R 37 E**

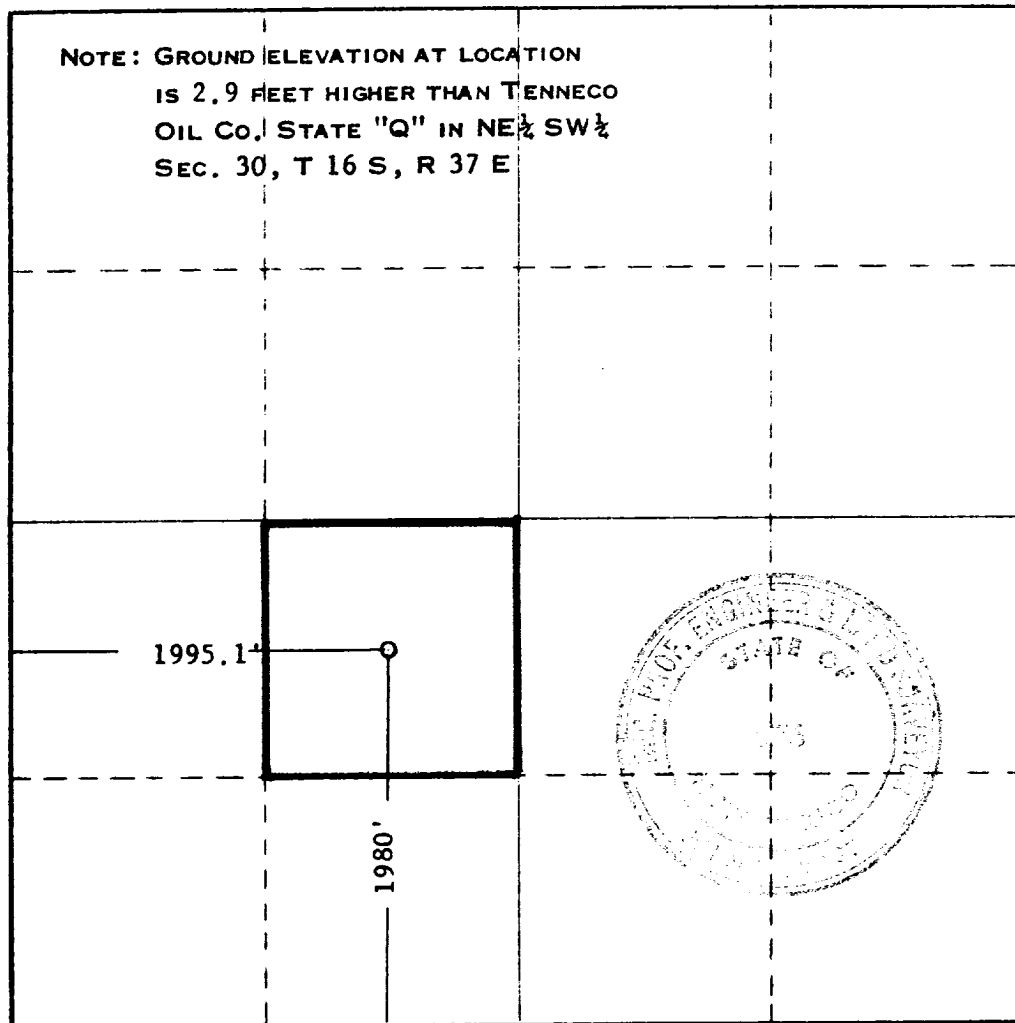

CERTIFICATION

I hereby certify that the information contained herein is true and complete to the best of my knowledge and belief.

Name *Al Lee Harward*

Position
Exploration Manager

Company
Southwest Prod. Corp.

Date
February 12, 1968

I hereby certify that the well location shown on this plat was plotted from field notes of actual surveys made by me or under my supervision, and that the same is true and correct to the best of my knowledge and belief.

Date Surveyed
JANUARY 25, 1968

Registered Professional Engineer
and/or Land Surveyor

John W. West
Certificate No. **676**



477