

NO. OF COPIES RECEIVED	
DISTRIBUTION	
SANTA FE	
FILE	
U.S.G.S.	
LAND OFFICE	
OPERATOR	

NEW MEXICO OIL CONSERVATION COMMISSION

Amended—2

Form C-101
Revised 1-1-65

5A. Indicate Type of Lease	STATE <input checked="" type="checkbox"/> FEE <input type="checkbox"/>
5. State Oil & Gas Lease No.	B 2148

APPLICATION FOR PERMIT TO DRILL, DEEPEN, OR PLUG BACK

1a. Type of Work	DRILL <input checked="" type="checkbox"/> DEEPEN <input type="checkbox"/> PLUG BACK <input type="checkbox"/>	7. Unit Agreement Name	Lease
b. Type of Well	OIL WELL <input checked="" type="checkbox"/> GAS WELL <input type="checkbox"/> OTHER <input type="checkbox"/> SINGLE ZONE <input checked="" type="checkbox"/> MULTIPLE ZONE <input type="checkbox"/>	8. Farm or Lease Name	15
2. Name of Operator	Phillips Petroleum Company	9. Well No.	Undesignated
3. Address of Operator	Room B-2, Phillips Bldg., Odessa, Texas	10. Field and Pool, or Wildcat	
4. Location of Well	UNIT LETTER H LOCATED 1980 FEET FROM THE north LINE AND 760 FEET FROM THE east LINE OF SEC. 16 TWP. 17-S RGE. 33-E NMPM	12. County	Lea
19. Proposed Depth	4600	19A. Formation	Grayburg/San Andres
20. Rotary or C.T.			Rotary
21. Elevations (Show whether DF, RT, etc.)	Later	21A. Kind & Status Plug. Bond	Blanket
21B. Drilling Contractor	Later	22. Approx. Date Work will start	Upon approval

23.

PROPOSED CASING AND CEMENT PROGRAM

SIZE OF HOLE	SIZE OF CASING	WEIGHT PER FOOT	SETTING DEPTH	SACKS OF CEMENT	EST. TOP
12-1/4"	8-5/8"	24#	350'	250	Circulate
7-7/8"	4-1/2"	11.6#	4600'	275	Sufficient to cover all productive zones

Series 900 hydraulically operated BOP equipment.
Use mud additives as required for control.
Moved location from Section 21 to Section 16.

EXPIRES 11-29-69

IN ABOVE SPACE DESCRIBE PROPOSED PROGRAM: IF PROPOSAL IS TO DEEPEN OR PLUG BACK, GIVE DATA ON PRESENT PRODUCTIVE ZONE AND PROPOSED NEW PRODUCTIVE ZONE. GIVE BLOWOUT PREVENTER PROGRAM, IF ANY.

I hereby certify that the information above is true and complete to the best of my knowledge and belief.

Signed W. J. Mueller Title Associate Reservoir Engineer Date 8-26-69

(This space for State Use)

APPROVED BY [Signature] TITLE SUPERVISOR DISTRICT DATE AUG 29 1969

CONDITIONS OF APPROVAL, IF ANY:

NEW MEXICO OIL CONSERVATION COMMISSION
WELL LOCATION AND ACREAGE DEDICATION PLAT

Form C-102
Supersedes C-128
Effective 1-1-65

AMENDED - 2

All distances must be from the outer boundaries of the Section.

Operator Phillips Petroleum Company			Lease Leamex		Well No. 15
Unit Letter H	Section 16	Township 17-S	Range 33-E	County Lea	
Actual Footage Location of Well: 1980 feet from the north line and 760 feet from the east line					
Ground Level Elev. later	Producing Formation Grayburg-San Andres		Pool Undesignated		Dedicated Acreage; 40 Acres

1. Outline the acreage dedicated to the subject well by colored pencil or hachure marks on the plat below.
2. If more than one lease is dedicated to the well, outline each and identify the ownership thereof (both as to working interest and royalty).
3. If more than one lease of different ownership is dedicated to the well, have the interests of all owners been consolidated by communitization, unitization, force-pooling, etc?

☐ Yes ☐ No If answer is "yes," type of consolidation _____

If answer is "no," list the owners and tract descriptions which have actually been consolidated. (Use reverse side of this form if necessary.) _____

No allowable will be assigned to the well until all interests have been consolidated (by communitization, unitization, forced-pooling, or otherwise) or until a non-standard unit, eliminating such interests, has been approved by the Commission.

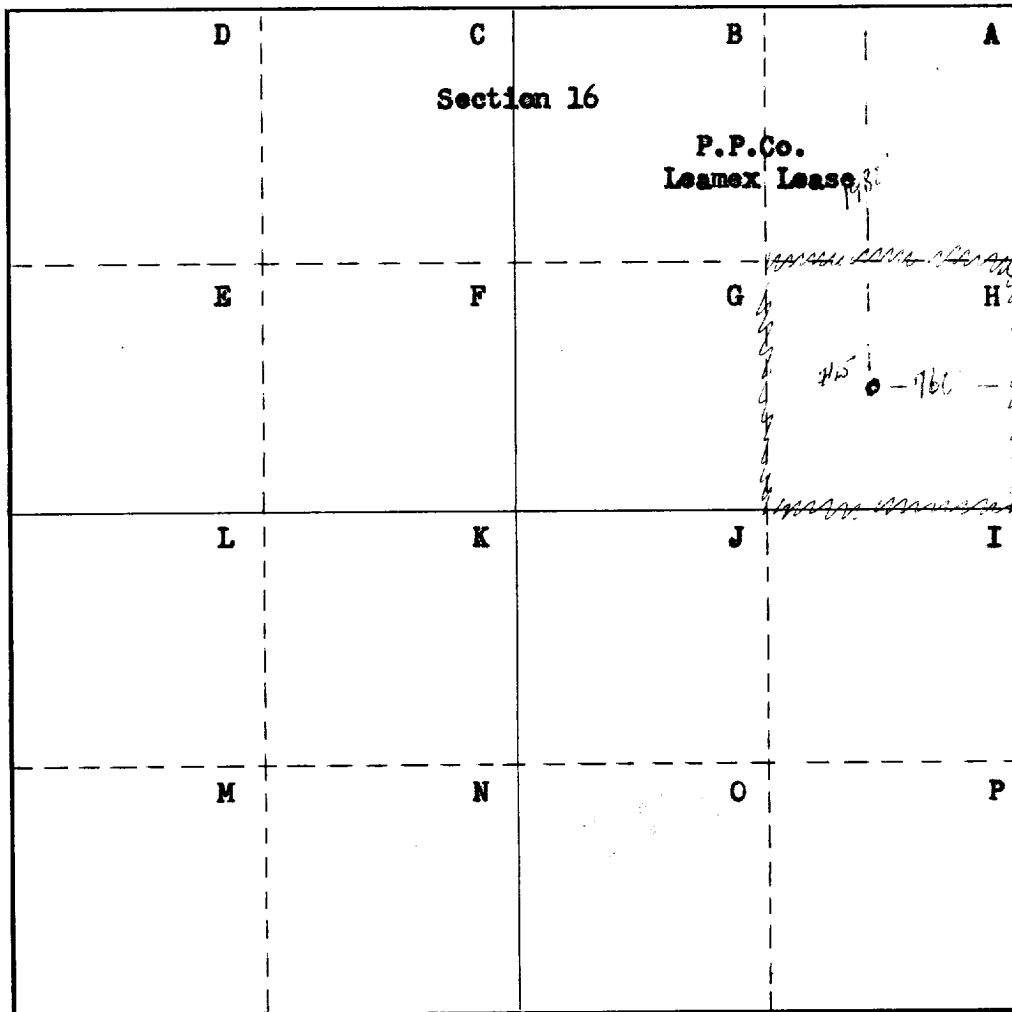

CERTIFICATION

I hereby certify that the information contained herein is true and complete to the best of my knowledge and belief.

H.J. Mueller
Name

Associate Reservoir Engineer
Position

Phillips Petroleum Company
Company

August 25, 1969
Date

I hereby certify that the well location shown on this plat was plotted from field notes of actual surveys made by me or under my supervision, and that the same is true and correct to the best of my knowledge and belief.

Date Surveyed

August 12, 1969

Registered Professional Engineer
and/or Land Surveyor

Roger L. Leffler
Roger L. Leffler

Certificate No.

4357

0 330 660 990 1320 1650 1980 2310 2640 2000 1500 1000 500 0