

UNITED STATES
DEPARTMENT OF THE INTERIOR
GEOLOGICAL SURVEY

APPLICATION FOR PERMIT TO DRILL, DEEPEN, OR PLUG BACK

1a. TYPE OF WORK

DRILL ☒DEEPEN ☐PLUG BACK ☐

b. TYPE OF WELL

OIL
WELL ☒GAS
WELL ☐OTHER ☐SINGLE
ZONE ☐MULTIPLE
ZONE ☐

2. NAME OF OPERATOR

3. ADDRESS OF OPERATOR

4. LOCATION OF WELL (Report location clearly and in accordance with any State requirements.)

At surface

1416 FSL & 1224 FWL of Sec. 20, T-17S, R-32E,

Lea Co. N.M.

At proposed prod. zone

Unorthodox location approved on order

Same

#NSL-481.

14. DISTANCE IN MILES AND DIRECTION FROM NEAREST TOWN OR POST OFFICE*

15. DISTANCE FROM PROPOSED*

LOCATION TO NEAREST

PROPERTY OR LEASE LINE, FT.

(Also to nearest drilg. unit line, if any)

18. DISTANCE FROM PROPOSED LOCATION*

TO NEAREST WELL, DRILLING, COMPLETED,

OR APPLIED FOR, ON THIS LEASE, FT.

16. NO. OF ACRES IN LEASE

7853

19. PROPOSED DEPTH

4100'

17. NO. OF ACRES ASSIGNED

TO THIS WELL

40 Acres with MCA Unit

20. ROTARY OR CABLE TOOLS

Rotary

21. ELEVATIONS (Show whether DE, RT, GR, etc.)

Elev 3965 GL

23.

PROPOSED CASING AND CEMENTING PROGRAM

SIZE OF HOLE	SIZE OF CASING	WEIGHT PER FOOT	SETTING DEPTH	QUANTITY OF CEMENT
12 1/4"	8 5/8"	20#	700"	325 of Class "C" Cement
7 7/8"	5 1/2"	14#	4100"	250 of Class "C" Cement

It is proposed to drill a straight hole to TD and complete this well as a Dragbuck-San Andres producing oil well.

NSL 481

IN ABOVE SPACE DESCRIBE PROPOSED PROGRAM: If proposal is to deepen or plug back, give data on present productive zone and proposed new productive zone. If proposal is to drill or deepen directionally, give pertinent data on subsurface locations and measured and true vertical depths. Give blowout preventer program, if any.

24.

SIGNED

M.E. Yeakley

TITLE

Administrative Asst. DATE 1-22-71

(This space for Federal or State office use)

PERMIT NO.

APPROVAL DATE

APPROVED BY

TITLE

CONDITIONS OF APPROVAL, IF ANY:

H565 (5) MCA (3)

2 file

APPROVED

JAN 25 1971

ARTHUR R. BROWN
DISTRICT ENGINEER

*See Instructions On Reverse Side

RECEIVED

JAN 20 1971

OIL CONSERVATION COMM.
HOBBES, N. H.

NEW MEXICO OIL CONSERVATION COMMISSION
WELL LOCATION AND ACREAGE DEDICATION PL.

Form C-102
Supersedes C-108
Effective 1-1-65

All distances must be from the outer boundaries of the Section

Operator CONTINENTAL OIL COMPANY			Lease MCA UNIT		Well No. 265
Unit Letter L	Section 20	Township 17 SOUTH	Range 32 EAST	County LEA	
Actual Footage Location of Well: 1416 feet from the SOUTH line and 1224 feet from the WEST line					
Ground Level Elev.	Producing Formation	Pool	Dedicated Acreage: Acres		

1. Outline the acreage dedicated to the subject well by colored pencil or hachure marks on the plat below.
2. If more than one lease is dedicated to the well, outline each and identify the ownership thereof (both as to working interest and royalty).
3. If more than one lease of different ownership is dedicated to the well, have the interests of all owners been consolidated by communitization, unitization, force-pooling, etc?

☐ Yes ☐ No If answer is "yes," type of consolidation _____

If answer is "no," list the owners and tract descriptions which have actually been consolidated. (Use reverse side of this form if necessary.) _____

No allowable will be assigned to the well until all interests have been consolidated (by communitization, unitization, forced-pooling, or otherwise) or until a non-standard unit, eliminating such interests, has been approved by the Commission.

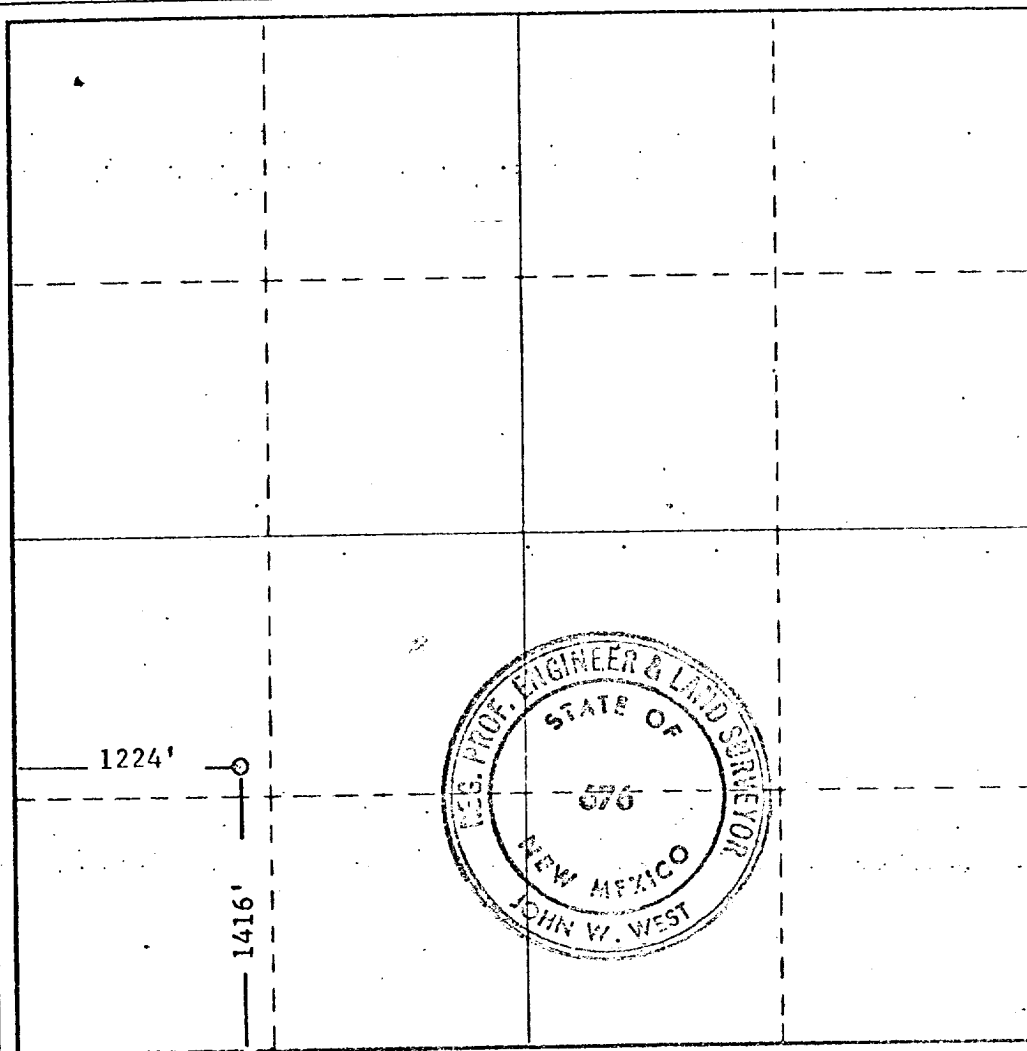

CERTIFICATION

I hereby certify that the information contained herein is true and complete to the best of my knowledge and belief.

Name M.E. Yeakley
Position Administrative Assistant
Company Continental Oil Company
Date 1-22-71

I hereby certify that the well location shown on this plat was plotted from field notes of actual surveys made by me or under my supervision, and that the same is true and correct to the best of my knowledge and belief.

Date Surveyed
1-14-1971

Registered Professional Engineer and/or Land Surveyor

John W. West
Certificate No. **676**

0 330 660 990 1320 1650 1980 2310 2640 2970 3300 3630 3960 4290 4620 4950 5280 5610 5940 6270 6600

173

RECEIVED

JAN 20 1971

OIL CONSERVATION COMM.
HOBBS, N. M.