

UNITED STATES
DEPARTMENT OF THE INTERIOR
GEOLOGICAL SURVEY

APPLICATION FOR PERMIT TO DRILL, DEEPEN, OR PLUG BACK

1a. TYPE OF WORK
DRILL ☒ DEEPEN ☐ PLUG BACK ☐

b. TYPE OF WELL
OIL WELL ☒ GAS WELL ☐ OTHER ☐ SINGLE ZONE ☐ MULTIPLE ZONE ☐

2. NAME OF OPERATOR
Continental Oil Company

3. ADDRESS OF OPERATOR
Box 462 Hobbs, N. Mex.

4. LOCATION OF WELL (Report location clearly and in accordance with any State requirements.)*
At surface *1345' - 51' + 1345' F.W.L. of Sec 29*
At proposed prod. zone *Same*

14. DISTANCE IN MILES AND DIRECTION FROM NEAREST TOWN OR POST OFFICE*

5. LEASE DESIGNATION AND SERIAL NO.
LC-029410 (7)

6. IF INDIAN, ALLOTTEE OR TRIBE NAME

7. UNIT AGREEMENT NAME
MCA

8. FARM OR LEASE NAME
MCA Unit 642

9. WELL NO.
293

10. FIELD AND POOL, OR WILDCAT
MCA 6-57 Repr.

11. SEC., T., R., M., OR BLK AND SURVEY OR AREA
Sec 29, T-17S, R-31E

12. COUNTY OR PARISH
Lea

13. STATE
N. Mex.

15. DISTANCE FROM PROPOSED* LOCATION TO NEAREST PROPERTY OR LEASE LINE, FT. (Also to nearest drlg. unit line, if any)

16. NO. OF ACRES IN LEASE
7853

17. NO. OF ACRES ASSIGNED TO THIS WELL
Acres 2/170 - 40

18. DISTANCE FROM PROPOSED LOCATION* TO NEAREST WELL, DRILLING, COMPLETED, OR APPLIED FOR, ON THIS LEASE, FT.

19. PROPOSED DEPTH
4185

20. ROTARY OR CABLE TOOLS
Rotary

21. ELEVATIONS (Show whether DF, RT, GR, etc.)
NA

22. APPROX. DATE WORK WILL START*
5-9-71

PROPOSED CASING AND CEMENTING PROGRAM				
SIZE OF HOLE	SIZE OF CASING	WEIGHT PER FOOT	SETTING DEPTH	QUANTITY OF CEMENT
<i>12 1/4</i>	<i>8 7/8</i>	<i>20 #</i>	<i>825</i>	<i>400.0 Circulate</i>
<i>7 7/8</i>	<i>5 1/2</i>	<i>14 #</i>	<i>4185</i>	<i>300.0</i>

It is proposed to drill a straight hole to TD & complete as a Grayburg San Andres oil well.

This unorthodox location was approved by Administrative Order # NSL-498

IN ABOVE SPACE DESCRIBE PROPOSED PROGRAM: If proposal is to deepen or plug back, give data on present productive zone and proposed new productive zone. If proposal is to drill or deepen directionally, give pertinent data on subsurface locations and measured and true vertical depths. Give blowout preventer program, if any.

24. SIGNED *[Signature]* TITLE *Adm. Supervisor* DATE *5-5-71*

(This space for Federal or State office use)

PERMIT NO.

APPROVAL DATA

APPROVED BY

TITLE

CONDITIONS OF APPROVAL, IF ANY:

APPROVED

MAY 6 1971

ARTHUR R. BROWN

RECEIVED

MAY 11 1971

**OIL CONSERVATION COMM.
HOBBS, N. M.**

NEW MEXICO OIL CONSERVATION COMMISSION
WELL LOCATION AND ACREAGE DEDICATION PLAT

Form C-102
Supersedes C-128
Effective 1-1-65

All distances must be from the outer boundaries of the Section.

Operator CONTINENTAL OIL CO.			Lease M C A UNIT		Well No. 293
Unit Letter K	Section 29	Township 17 SOUTH	Range 32 EAST	County LEA	
Actual Footage Location of Well: 1345 feet from the SOUTH line and 1345 feet from the WEST line					
Ground Level Elev.	Producing Formation Malj G-SA Rgn		Pool G-SA	Dedicated Acreage: 40 joint 4/170 Acres	

1. Outline the acreage dedicated to the subject well by colored pencil or hachure marks on the plat below.
2. If more than one lease is dedicated to the well, outline each and identify the ownership thereof (both as to working interest and royalty).
3. If more than one lease of different ownership is dedicated to the well, have the interests of all owners been consolidated by communitization, unitization, force-pooling, etc?

☐ Yes ☐ No If answer is "yes," type of consolidation _____

If answer is "no," list the owners and tract descriptions which have actually been consolidated. (Use reverse side of this form if necessary.) _____

No allowable will be assigned to the well until all interests have been consolidated (by communitization, unitization, forced-pooling, or otherwise) or until a non-standard unit, eliminating such interests, has been approved by the Commission.

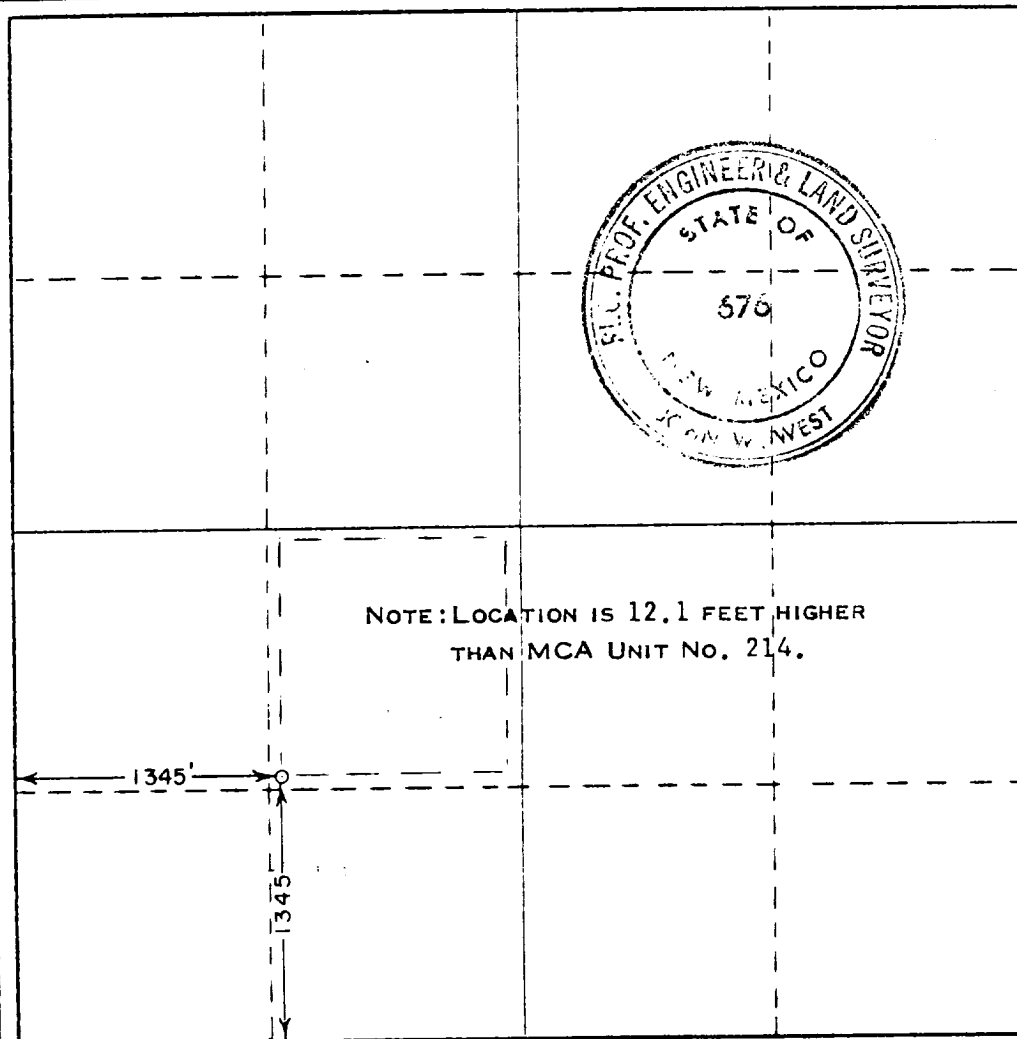

CERTIFICATION

I hereby certify that the information contained herein is true and complete to the best of my knowledge and belief.

Signature: *[Handwritten Signature]*
Position: *Adm. Supervisor*
Company: *Continental Oil Co.*
Date: *5-5-71*

I hereby certify that the well location shown on this plat was plotted from field notes of actual surveys made by me or under my supervision, and that the same is true and correct to the best of my knowledge and belief.

Date Surveyed: **APRIL 17, 1971**
Registered Professional Engineer and/or Land Surveyor

Signature: *John W. West*
Certificate No. **676**

0 330 660 990 1320 1650 1980 2310 2640 2000 1800 1000 500

RECEIVED

MAY 11 1971

OIL CONSERVATION COMM.
HOBBS, N. M.