

UNITED STATES
DEPARTMENT OF THE INTERIOR
GEOLOGICAL SURVEY

APPLICATION FOR PERMIT TO DRILL, DEEPEN, OR PLUG BACK

1a. TYPE OF WORK DRILL <input checked="" type="checkbox"/> DEEPEN <input type="checkbox"/> PLUG BACK <input type="checkbox"/>		5. LEASE DESIGNATION AND SERIAL NO. LC-029410 (b)
b. TYPE OF WELL OIL WELL <input checked="" type="checkbox"/> GAS WELL <input type="checkbox"/> OTHER <input type="checkbox"/>		6. IF INDIAN, ALLOTTEE OR TRIBE NAME
2. NAME OF OPERATOR Continental Oil Company		7. UNIT AGREEMENT NAME MCA
3. ADDRESS OF OPERATOR Box 460, Hobbs, N. Mex. 88240		8. FARM OR LEASE NAME MCA Unit Bty 1
4. LOCATION OF WELL (Report location clearly and in accordance with any State requirements.) At surface 1165' FNL + 1345' FEL of Sec 30		9. WELL NO. 289
At proposed prod. zone Same		10. FIELD AND POOL, OR WILDCAT Malj. G-SA Repr.
14. DISTANCE IN MILES AND DIRECTION FROM NEAREST TOWN OR POST OFFICE*		11. SEC., T., R., M., OR BLK. AND SURVEY OR AREA Sec 30, T-17S, R-32E
15. DISTANCE FROM PROPOSED* LOCATION TO NEAREST PROPERTY OR LEASE LINE, FT. (Also to nearest drlg. unit line, if any)	16. NO. OF ACRES IN LEASE 7853	12. COUNTY OR PARISH Lea
18. DISTANCE FROM PROPOSED LOCATION* TO NEAREST WELL, DRILLING, COMPLETED, OR APPLIED FOR, ON THIS LEASE, FT.	19. PROPOSED DEPTH 4025	13. STATE N. Mex.
21. ELEVATIONS (Show whether DF, RT, GR, etc.) Est 3921' DF	17. NO. OF ACRES ASSIGNED TO THIS WELL 40 Quarterly w/ # 107	20. ROTARY OR CABLE TOOLS
22. APPROX. DATE WORK WILL START* 5-21-71		

23. PROPOSED CASING AND CEMENTING PROGRAM

SIZE OF HOLE	SIZE OF CASING	WEIGHT PER FOOT	SETTING DEPTH	QUANTITY OF CEMENT
12 1/4	8 1/2	20	700'	400 sx Circulated
7 7/8	5 1/2	14	4025	300 sx.

It is proposed to drill a straight hole to 4025'
& complete as a Grayburg - San Andres oil producer.

Request for approval to drill this unorthodox location
was mailed May 17, 1971.

VS65-5 MCA 3 216

IN ABOVE SPACE DESCRIBE PROPOSED PROGRAM: If proposal is to deepen or plug back, give data on present productive zone and proposed new productive zone. If proposal is to drill or deepen directionally, give pertinent data on subsurface locations and measured and true vertical depths. Give blowout preventer program, if any.

24. SIGNED [Signature] TITLE Adm. Supervisor DATE 5-19-71
(This space for Federal or State office use)

PERMIT NO. _____

APPROVAL DATE

APPROVED BY _____

TITLE _____

CONDITIONS OF APPROVAL, IF ANY:

APPROVED

MAY 21 1971

ARTHUR R. BROWN
DISTRICT ENGINEER

*See Instructions On Reverse Side

RECEIVED

MAY 28 1971

**OIL CONSERVATION COMM.
HOBBS, N. M.**

NEW MEXICO OIL CONSERVATION COMMISSION
WELL LOCATION AND ACREAGE DEDICATION PLAT

Form C-122
Supersedes C-128
Effective 1-1-65

All distances must be from the outer boundaries of the Section.

Operator CONTINENTAL OIL CO.			Lease M C A UNIT		Well No. 289
Unit Letter B	Section 30	Township 17 SOUTH	Range 32 EAST	County LEA	

Actual Postage Location of Well:

1165	feet from the	NORTH	line and	1345	feet from the	EAST	line
Ground Level Elev.	Producing Formation <i>Grayburg - San Andres</i>		Pool <i>McA-5A Perm.</i>		Dedicates Acreage <i>40 - jointly 4/107</i>		

1. Outline the acreage dedicated to the subject well by colored pencil or hatchure marks on the plat below.
2. If more than one lease is dedicated to the well, outline each and identify the ownership thereof (both as to working interest and royalty).
3. If more than one lease of different ownership is dedicated to the well, have the interests of all owners been consolidated by communitization, unitization, force-pooling, etc?

☐ Yes ☐ No If answer is "yes," type of consolidation _____

If answer is "no," list the owners and tract descriptions which have actually been consolidated. (Use reverse side of this form if necessary.) _____

No allowable will be assigned to the well until all interests have been consolidated (by communitization, unitization, forced-pooling, or otherwise) or until a non-standard unit, eliminating such interests, has been approved by the Commission.

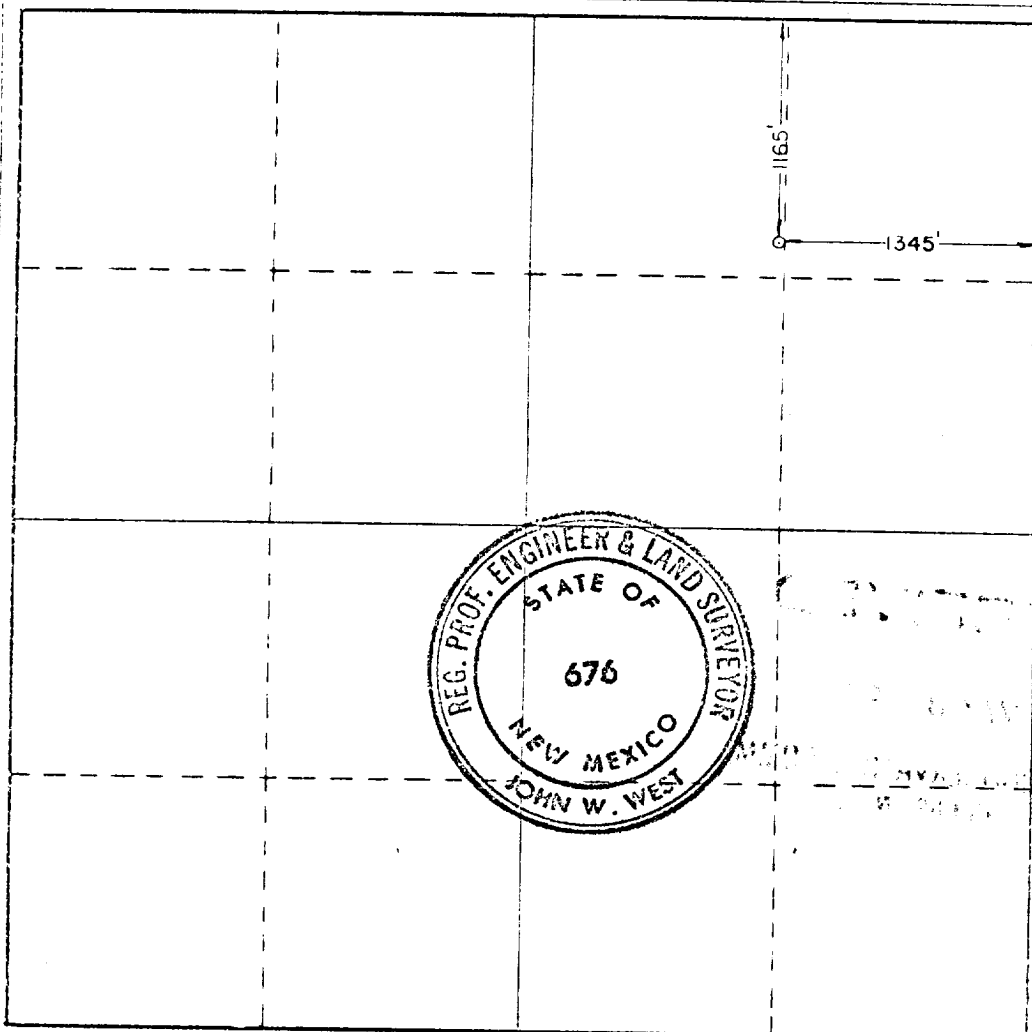

CERTIFICATION

I hereby certify that the information contained herein is true and complete to the best of my knowledge and belief.

John W. West
Surveyor

Asst. Supervisor

Continental Oil Co.

5-19-71

I hereby certify that the well location shown on this plat was plotted from field notes of actual surveys made by me or under my supervision, and that the same is true and correct to the best of my knowledge and belief.

Date Surveyed

APRIL 15, 1971

Registered Professional Engineer
and/or Land Surveyor

John W. West
Certificate No. **676**

0 330 660 990 1320 1650 1980 2310 2640 2970 3300 3630 3960 4290 4620 4950 5280 5610 5940 6270 6600 6930 7260 7590 7920 8250 8580 8910 9240 9570 9900

RECEIVED

MAY 25 1971

**OIL CONSERVATION COMM.
HOBBS, N. M.**

171