

UNITED STATES
DEPARTMENT OF THE INTERIOR
GEOLOGICAL SURVEY

SUBMIT IN TRIPLICATE*
(Other instruction.
reverse side)

Form approved.
Budget Bureau No. 42-R1425.

APPLICATION FOR PERMIT TO DRILL, DEEPEN, OR PLUG BACK

1a. TYPE OF WORK DRILL <input checked="" type="checkbox"/> DEEPEN <input type="checkbox"/> PLUG BACK <input type="checkbox"/>		5. LEASE DESIGNATION AND SERIAL NO. LC 029410 b	
b. TYPE OF WELL OIL WELL <input checked="" type="checkbox"/> GAS WELL <input type="checkbox"/> OTHER <input type="checkbox"/>		6. IF INDIAN, ALLOTTEE OR TRIBE NAME	
2. NAME OF OPERATOR Continental Oil Company		7. UNIT AGREEMENT NAME MCA	
3. ADDRESS OF OPERATOR Box 460 Hobbs, New Mexico		8. FARM OR LEASE NAME MCA Unit	
4. LOCATION OF WELL (Report location clearly and in accordance with any State requirements.) At surface 1345' FSL and 1295' FEL of Sec 30		9. WELL NO. 304	
At proposed prod. zone Same		10. FIELD AND POOL, OR WILDCAT Mall G-SA Repress	
14. DISTANCE IN MILES AND DIRECTION FROM NEAREST TOWN OR POST OFFICE*		11. SEC., T., R., M., OR BLK. AND SURVEY OR AREA Sec 30, T-17S, R-32E	
15. DISTANCE FROM PROPOSED* LOCATION TO NEAREST PROPERTY OR LEASE LINE, FT. (Also to nearest drlg. unit line, if any)		12. COUNTY OR PARISH 13. STATE Lea N. Mex	
16. NO. OF ACRES IN LEASE 7853		17. NO. OF ACRES ASSIGNED TO THIS WELL 40	
18. DISTANCE FROM PROPOSED LOCATION* TO NEAREST WELL, DRILLING, COMPLETED, OR APPLIED FOR, ON THIS LEASE, FT. 4175'		20. ROTARY OR CABLE TOOLS Rotary	
21. ELEVATIONS (Show whether DF, RT, GR, etc.) 3900' est gr		22. APPROX. DATE WORK WILL START* 12-31-71	

PROPOSED CASING AND CEMENTING PROGRAM

SIZE OF HOLE	SIZE OF CASING	WEIGHT PER FOOT	SETTING DEPTH	QUANTITY OF CEMENT
12 1/4"	8 5/8"	20 #	900'	Circ - 450 sacks
7 1/8"	5 1/2"	14 #	4175'	275 sacks

It is proposed to drill a straight hole to a TD of 4175' and complete as a Grayburg San Andres producing oil well.

NSL-533

IN ABOVE SPACE DESCRIBE PROPOSED PROGRAM: If proposal is to deepen or plug back, give data on present productive zone and proposed new productive zone. If proposal is to drill or deepen directionally, give pertinent data on subsurface locations and measured and true vertical depths. Give blowout preventer program, if any.

24. SIGNED [Signature] TITLE Administrative Supervisor DATE 12-29-71

(This space for Federal or State office use)

PERMIT NO. _____ APPROVAL DATE _____

APPROVED BY _____ TITLE _____

CONDITIONS OF APPROVAL, IF ANY:

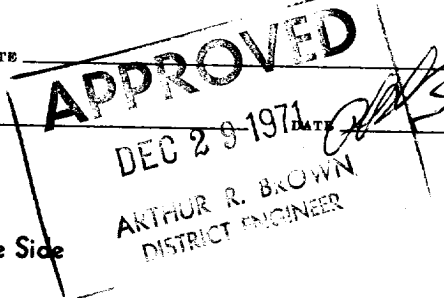

USGS-(5) MCA(3) File *See Instructions On Reverse Side

NEW MEXICO OIL CONSERVATION COMMISSION
WELL LOCATION AND ACREAGE DEDICATION PLAT

Form C-102
Supersedes C-128
Effective 1-1-65

All distances must be from the outer boundaries of the Section.

Operator CONTINENTAL OIL COMPANY			Lease M C A UNIT		Well No. 304
Unit Letter I	Section 30	Township 17 SOUTH	Range 32 EAST	County LEA	
Actual Footage Location of Well: 1345 feet from the SOUTH line and 1295 feet from the EAST line					
Ground Level Elev.	Producing Formation Hayburg Sonando		Pool Maly G-SA Repress	Dedicated Acreage: 40	

1. Outline the acreage dedicated to the subject well by colored pencil or hachure marks on the plat below.
2. If more than one lease is dedicated to the well, outline each and identify the ownership thereof (both as to working interest and royalty).
3. If more than one lease of different ownership is dedicated to the well, have the interests of all owners been consolidated by communitization, unitization, force-pooling, etc?

☐ Yes ☐ No If answer is "yes," type of consolidation _____

If answer is "no," list the owners and tract descriptions which have actually been consolidated. (Use reverse side of this form if necessary.) _____

No allowable will be assigned to the well until all interests have been consolidated (by communitization, unitization, forced-pooling, or otherwise) or until a non-standard unit, eliminating such interests, has been approved by the Commission.

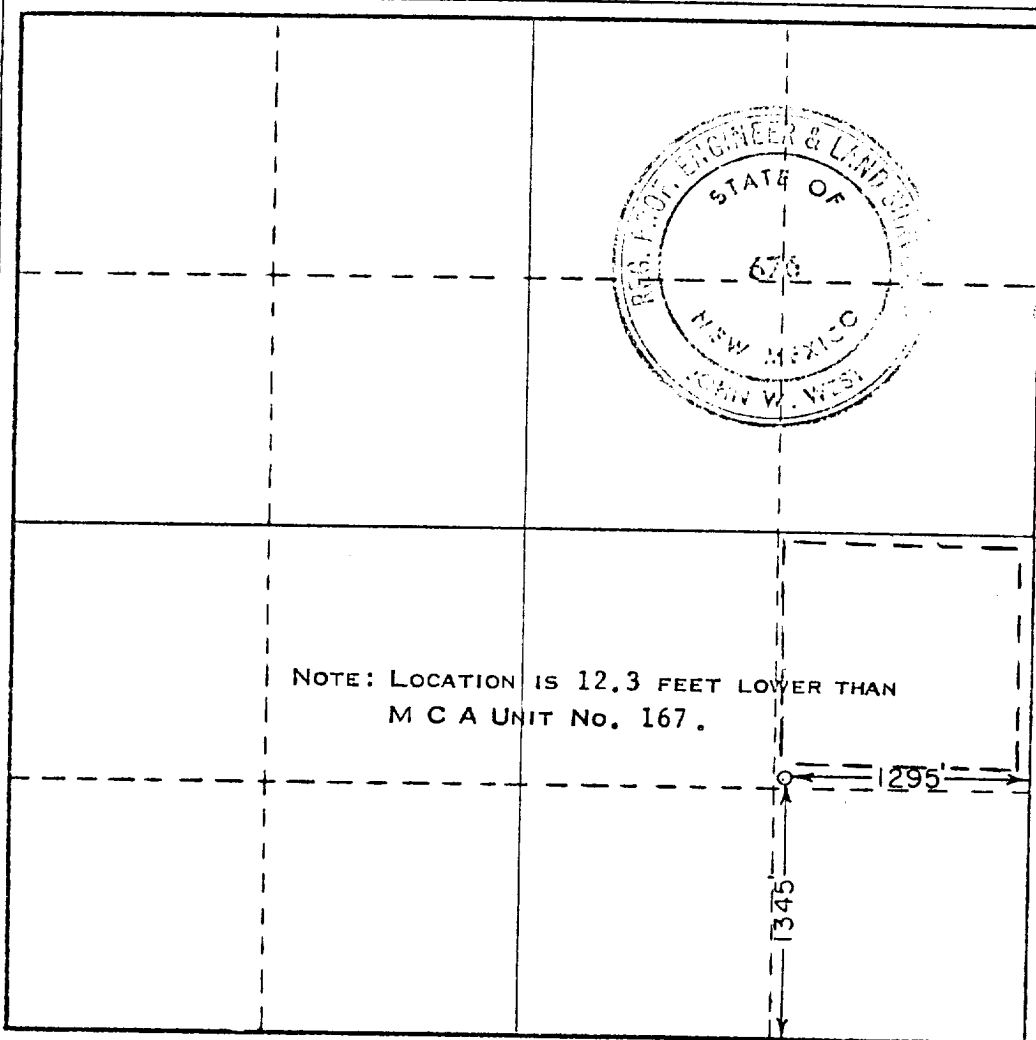

CERTIFICATION

I hereby certify that the information contained herein is true and complete to the best of my knowledge and belief.

Name *Thompson*
Position *Admin Supervisor*
Company *Continental Oil Co*
Date *December 29, 1971*

I hereby certify that the well location shown on this plat was plotted from field notes of actual surveys made by me or under my supervision, and that the same is true and correct to the best of my knowledge and belief.

Date Surveyed
DECEMBER 27, 1971
Registered Professional Engineer and/or Land Surveyor
W. W. West

Certificate No. **676**

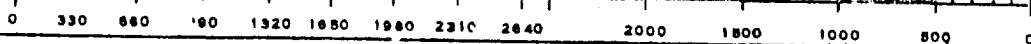



RECEIVED

AM 11 11

U. S. DEPARTMENT OF AGRICULTURE
WASHINGTON, D. C.