

NO. OF COPIES RECEIVED	
DISTRIBUTION	
SANTA FE	
FILE	
U.S.G.S.	
LAND OFFICE	
OPERATOR	

# NEW MEXICO OIL CONSERVATION COMMISSION

Form C-101  
Revised 1-1-65 *70-612 24-74*

5A. Indicate Type of Lease
STATE <input type="checkbox"/> FEE <input checked="" type="checkbox"/>
5. State Oil & Gas Lease No.
7. Unit Agreement Name
8. Farm or Lease Name
9. Well No.
10. Indicate Pool or Field
11. Name of Pool or Field
12. County
13. Lease

APPLICATION FOR PERMIT TO DRILL, DEEPEN, OR PLUG BACK	
1a. Type of Work	
b. Type of Well DRILL <input checked="" type="checkbox"/> DEEPEN <input type="checkbox"/> PLUG BACK <input type="checkbox"/>	
OIL WELL <input checked="" type="checkbox"/> GAS WELL <input type="checkbox"/> OTHER <input type="checkbox"/> SINGLE ZONE <input type="checkbox"/> MULTIPLE ZONE <input type="checkbox"/>	
2. Name of Operator	
Green & Michaelson Producing Co.	
3. Address of Operator	
314 Building of the Southwest, Midland, Texas 79701	
4. Location of Well	
UNIT LETTER 0 LOCATED 467 FEET FROM THE South LINE	
AND 1980 FEET FROM THE East LINE OF SEC. 21 TWP. 16S RGE. 38E NMPM	
5. Proposed Depth	
9000	
6. Formation	
Abo	
7. Rotary or C.T.	
Rotary	
8. Elevations (Show whether DF, RT, etc.)	
3715 Gr.	
9. Kind & Status Plug. Bond	
Blanket	
10. Drilling Contractor	
Moran	
11. Approx. Date Work will start	
27, March 1972	

## PROPOSED CASING AND CEMENT PROGRAM

SIZE OF HOLE	SIZE OF CASING	WEIGHT PER FOOT	SETTING DEPTH	SACKS OF CEMENT	EST. TOP
17	13 3/8	48	400	400 Sx.	Cir. to Top
11	8 5/8	24 & 32	4550	350 Sx.	3600
7 7/8	4 1/2	11.6 & 10.5	9000	1000 Sx.	4400

The 8 1/2 will be a liner from 4400 to T.D.

THE COMMISSION MUST BE NOTIFIED  
24 HOURS AHEAD TO RUN CASING.  
*13 7/8*

APPROVAL VALID  
FOR 90 DAYS UNLESS  
DRILLING COMMENCED,  
EXPIRES *6-27-72*

IN ABOVE SPACE DESCRIBE PROPOSED PROGRAM; IF PROPOSAL IS TO DEEPEN OR PLUG BACK, GIVE DATA ON PRESENT PRODUCTIVE ZONE AND PROPOSED NEW PRODUCTIVE ZONE. GIVE BLOWOUT PREVENTER PROGRAM, IF ANY.

I hereby certify that the information above is true and complete to the best of my knowledge and belief.

Signed *L. P. Michaelson* Title Vice President Date 3027072

(This space for State Use)

APPROVED BY *John H. Hines* TITLE SUPERVISOR DISTRICT I DATE MAR 27 1972

CONDITIONS OF APPROVAL, IF ANY:

RECEIVED

MAR 27 1972  
OIL CONSERVATION COMM.  
HOBBS, N. M.

NEW MEXICO OIL CONSERVATION COMMISSION  
WELL LOCATION AND ACREAGE DEDICATION PLAT

Form C-102  
Supersedes C-128  
Effective 1-1-65

All distances must be from the outer boundaries of the Section.

Operator <b>Green &amp; Michaelson Producing Co.</b>			Lease <b>Clardy</b>		Well No. <b>1</b>
Unit Letter <b>0</b>	Section <b>21</b>	Township <b>16S</b>	Range <b>38E</b>	County <b>Lea</b>	
Actual Footage Location of Well: <b>467</b> feet from the <b>South</b> line and <b>1980</b> feet from the <b>East</b> line					
Ground Level Elev: <b>3715</b>	Producing Formation <b>Abo</b>		Pool <b>Garrett Drinkard</b>		Dedicated Acreage: <b>40</b> Acres

1. Outline the acreage dedicated to the subject well by colored pencil or hachure marks on the plat below.
2. If more than one lease is dedicated to the well, outline each and identify the ownership thereof (both as to working interest and royalty).
3. If more than one lease of different ownership is dedicated to the well, have the interests of all owners been consolidated by communitization, unitization, force-pooling, etc?

☒ Yes ☐ No If answer is "yes," type of consolidation **Communitization**

If answer is "no," list the owners and tract descriptions which have actually been consolidated. (Use reverse side of this form if necessary.) \_\_\_\_\_

No allowable will be assigned to the well until all interests have been consolidated (by communitization, unitization, forced-pooling, or otherwise) or until a non-standard unit, eliminating such interests, has been approved by the Commission.

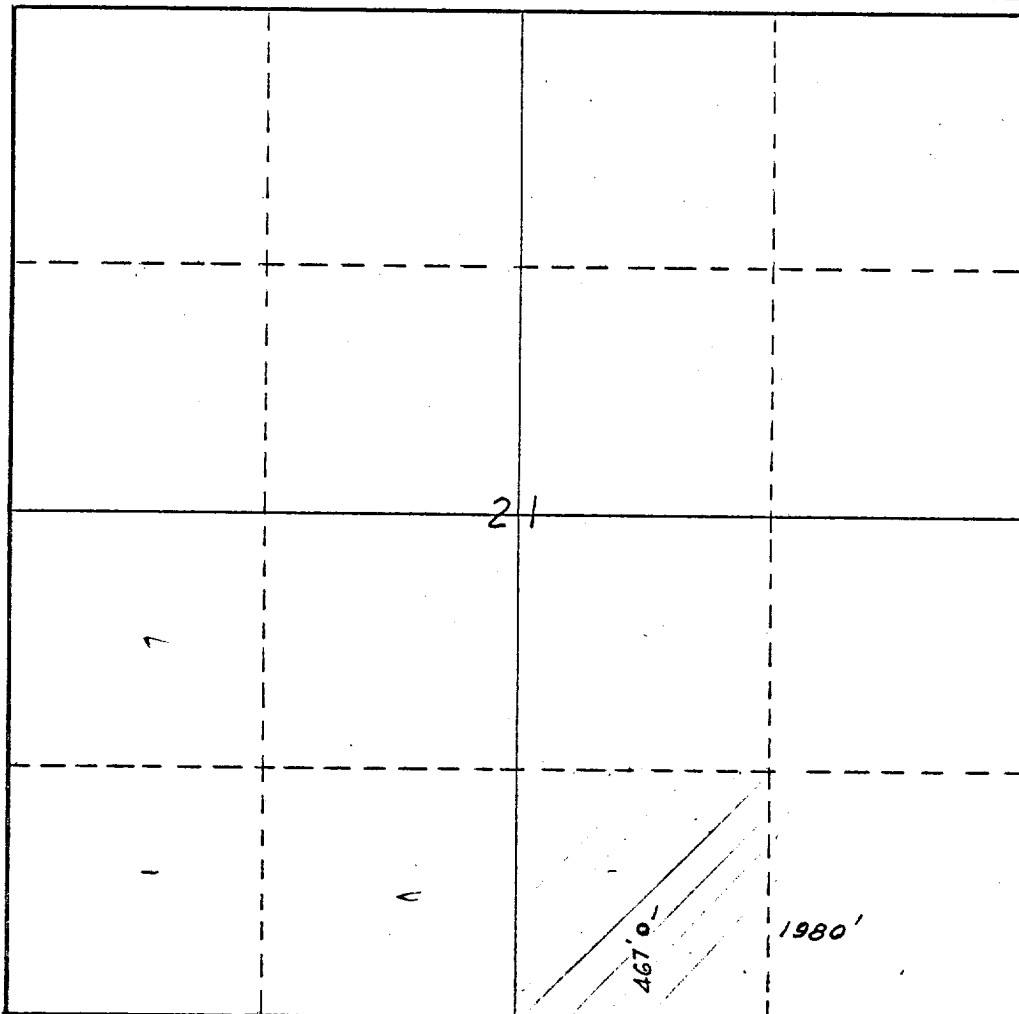

CERTIFICATION

I hereby certify that the information contained herein is true and complete to the best of my knowledge and belief.

Name **L. H. Michaelson**  
Position **Vice President**

Company **Green & Michaelson Prod. Co.**

Date **27, March 1972**

I hereby certify that the well location shown on this plat was plotted from field notes of actual surveys made by me or under my supervision, and that the same is true and correct to the best of my knowledge and belief.

Date Surveyed **March 27, 1972**  
Registered Professional Engineer and/or Land Surveyor **1390**  
**J. F. JOHNSON**  
Certificate No. **1390**

173

RECEIVED

MAR 25 1972

OIL CONSERVATION COMM.  
HOUSTON, TX