

STATE OF NEW MEXICO
ENERGY AND MINERALS DEPARTMENT

NO. OF COPIES RECEIVED	
DISTRIBUTION	
SANTA FE	
FILE	
U.S.G.S.	
LAND OFFICE	
OPERATOR	

OIL CONSERVATION DIVISION
P. O. BOX 2088
SANTA FE, NEW MEXICO 87501

Form C-103
Revised 10-1-78

3a. Indicate Type of Lease	
State <input type="checkbox"/>	Fee <input checked="" type="checkbox"/>
3. State Oil & Gas Lease No.	

SUNDRY NOTICES AND REPORTS ON WELLS

(DO NOT USE THIS FORM FOR PROPOSALS TO DRILL OR TO DEEPEN OR PLUG BACK TO A DIFFERENT RESERVOIR.
USE "APPLICATION FOR PERMIT -" (FORM C-101) FOR SUCH PROPOSALS.)

1. <input type="checkbox"/> OIL WELL <input type="checkbox"/> GAS WELL <input type="checkbox"/> OTHER- Dry (P&A)		7. Unit Agreement Name
2. Name of Operator Harvey E. Yates Company		8. Farm or Lease Name Allen
3. Address of Operator P. O. Box 1933, Roswell, New Mexico 88201		9. Well No. 1
4. Location of Well UNIT LETTER <u>N</u> <u>1650</u> FEET FROM THE <u>West</u> LINE AND <u>660</u> FEET FROM THE <u>South</u> LINE, SECTION <u>1</u> TOWNSHIP <u>15S</u> RANGE <u>36E</u> NMPM.		10. Field and Pool, or Whicat N.E. Caudill
15. Elevation (Show whether DF, RT, GR, etc.) 3886 DF		12. County Lea

Check Appropriate Box To Indicate Nature of Notice, Report or Other Data
NOTICE OF INTENTION TO: SUBSEQUENT REPORT OF:

PERFORM REMEDIAL WORK <input type="checkbox"/>	PLUG AND ABANDON <input checked="" type="checkbox"/>	REMEDIAL WORK <input type="checkbox"/>	ALTERING CASING <input type="checkbox"/>
TEMPORARILY ABANDON <input type="checkbox"/>	CHANGE PLANS <input type="checkbox"/>	COMMENCE DRILLING OPNS. <input type="checkbox"/>	PLUG AND ABANDONMENT <input type="checkbox"/>
PULL OR ALTER CASING <input type="checkbox"/>	OTHER <input type="checkbox"/>	CASING TEST AND CEMENT JOB <input type="checkbox"/>	OTHER <input type="checkbox"/>

17. Describe Proposed or Completed Operations (Clearly state all pertinent details, and give pertinent dates, including estimated date of starting any proposed work) SEE RULE 1603.

Harvey E. Yates Company plans to set a 100' plug @ 1115' to 1015', a 100' plug @ 350' to 450' and 10 sx surface plug.

There is not a dry hole marker installed at the request of the farmer. The 12 3/4" csg is cut off 3' below the surface with a plate welded over the 12 3/4" casing.

Received verbal approval from Paul Kautz 10/15/86.

18. I hereby certify that the information above is true and complete to the best of my knowledge and belief.

SIGNED Jayne Collins TITLE Production Analyst DATE 10/15/86

ORIGINAL SIGNED BY JERRY SEXTON
DISTRICT I SUPERVISOR

APPROVED BY _____ TITLE _____ DATE OCT 17 1986

CONDITIONS OF APPROVAL, IF ANY:

RECEIVED
OCT 16 1986
C.C.B.
HOBBS OFFICE

NO. OF COPIES RECEIVED	
DISTRIBUTION	
SANTA FE	
FILE	
S.O.S.	
LAND OFFICE	
OPERATOR	

NEW MEXICO OIL CONSERVATION COMMISSION

Form C-101
Revised 1-1-85

5A. Indicate Type of Lease	
STATE <input type="checkbox"/>	FEE <input checked="" type="checkbox"/>
5. State Oil & Gas Lease No.	

APPLICATION FOR PERMIT TO DRILL, DEEPEN, OR PLUG BACK

1a. Type of Work		7. Unit Agreement Name	
b. Type of Well DRILL <input type="checkbox"/> DEEPEN <input checked="" type="checkbox"/> PLUG BACK <input type="checkbox"/> OIL WELL <input checked="" type="checkbox"/> GAS WELL <input type="checkbox"/> OTHER <u>Re-entry</u> SINGLE ZONE <input type="checkbox"/> MULTIPLE ZONE <input type="checkbox"/>		8. Farm or Lease Name <u>Allen</u>	
2. Name of Operator <u>Harvey E. Yates Co.</u>		9. Well No. <u>1</u>	
3. Address of Operator <u>P.O. Box 1933 Roswell, New Mexico</u>		10. Field and Pool, or Wildcat <u>N.E. Caudill</u>	
4. Location of Well UNIT LETTER <u>N</u> LOCATED <u>1650</u> FEET FROM THE <u>West</u> LINE AND <u>660</u> FEET FROM THE <u>South</u> LINE OF SEC. <u>1</u> TWP. <u>15-S</u> R. <u>36-E</u> N.M.P.M.		12. County <u>Lea</u>	
18. Proposed Depth <u>11050</u>		19A. Formation <u>Wolfcamp</u>	
20. Rotary or C.T. <u>Rotary</u>		21. Elevations (Show whether D.F., R.I., etc.) <u>3886 DF</u>	
21A. Kind & Status Plug. Bond <u>50,000 Blanket</u>		21B. Drilling Contractor <u>Monument</u>	
22. Approx. Date Work will start <u>ASAP</u>			

PROPOSED CASING AND CEMENT PROGRAM

SIZE OF HOLE	SIZE OF CASING	WEIGHT PER FOOT	SETTING DEPTH	SACKS OF CEMENT	EST. TOP
17 1/2"	12 1/4	43	400	400	Surface
11"	8 5/8	32 & 24	4860	400	3000'
7 7/8	5 1/2	20 & 17#	11050	400	600 Above Pay

This well was drilled and P & A by VF Petroleum 5-5-72
Harvey E. Yates Co. is planning to Re-Entry the above well
& deepen by 100 plus feet. The Sundry Notice with all plugs &
cement is attached with the additional paperwork needed.

Re-entry attempted by Gabled S. Corp. 6/21/80.

Permit Expires 6 Months From Approval
Date Unless Drilling Underway.

IN ABOVE SPACE DESCRIBE PROPOSED PROGRAM IF PROPOSAL IS TO DEEPEN OR PLUG BACK, GIVE DATA ON PRESENT PRODUCTIVE ZONE AND PROPOSED NEW PRODUCTIVE ZONE. GIVE CEMENT PREVENTED PROGRAM, IF ANY.

I hereby certify that the information above is true and complete to the best of my knowledge and belief.

Signed N.M. Young Title Drilling Superintendent Date 9-29-86
(This space for State Use)

APPROVED BY ORIGINAL SIGNED BY JERRY SEXTON
DISTRICT I SUPERVISOR

OCT 1 1986

RECEIVED

SEP 30 1986

OFFICE
HONORARY

NO. OF COPIES RECEIVED	
DISTRIBUTION	
SANTA FE	
FILE	
U.S.G.S.	
LAND OFFICE	
OPERATOR	

NEW MEXICO OIL CONSERVATION COMMISSION

Form C-103
Supersedes Old
C-102 and C-103
Effective 1-4-65

5a. Indicate Type of Lease	
State <input type="checkbox"/>	Fee <input checked="" type="checkbox"/>
5. State Oil & Gas Lease No.	
7. Unit Agreement Name	
1	
8. Farm or Lease Name	
Allen	
9. Well No.	
1	
10. Field and Pool, or Wildcat	
Wildcat	
12. County	
Lea	

SUNDRY NOTICES AND REPORTS ON WELLS

DO NOT USE THIS FORM FOR PROPOSALS TO DRILL OR TO DEEPEN OR PLUG BACK TO A DIFFERENT RESERVOIR.
USE "APPLICATION FOR PERMIT TO DRILL" (FORM C-101) FOR SUCH PROPOSALS.

OIL WELL ☐ GAS WELL ☐ OTHER: Dry Hole

1. Name of Operator

V-F Petroleum

2. Address of Operator

1212 Vaughn Building, Midland, Texas 79701

3. Location of Well

UNIT LETTER N 1650 FEET FROM THE West LINE AND 660 FEET FROM
THE South LINE, SECTION 1 TOWNSHIP 15-S RANGE 36-E NMPM.

15. Elevation (Show whether Dr, RT, Gs, etc.)

Check Appropriate Box To Indicate Nature of Notice, Report or Other Data

NOTICE OF INTENTION TO:

SUBSEQUENT REPORT OF:

PERFORM REMEDIAL WORK <input type="checkbox"/>	PLUG AND ABANDON <input type="checkbox"/>	REMEDIAL WORK <input type="checkbox"/>	ALTERING CASING <input type="checkbox"/>
IMPROPERLY ABANDON <input type="checkbox"/>	CHANGE PLANS <input type="checkbox"/>	COMMENCE DRILLING CPNS. <input type="checkbox"/>	PLUG AND ABANDONMENT <input checked="" type="checkbox"/>
TELL OR ALTER CASING <input type="checkbox"/>	OTHER <input type="checkbox"/>	CASING TEST AND CEMENT JOBS <input type="checkbox"/>	

Describe Proposed or Completed Operations (Clearly state all pertinent details, and give pertinent dates, including estimated date of starting any proposed work). SEE RULE 1103.

Well was drilled to a total depth of 10,932'. No oil or gas was found in commercial quantities. P&A 4-28-72.

The well was plugged as follows:

Plug #1 (Bottom)	10,900'	100' 30 sx.
Plug #2 (Aso)	8,220'	100' 30 sx.
Plug #3 (Glorieta)	6,384'	100' 30 sx.
Plug #4 (8-5/8" casing)	4,880'	100' 30 sx.
Plug #5 (8-5/8" stub)	1,100'	89' 50 sx.
Plug #6 (Surface Casing)	400'	89' 50 sx.

A plug was placed at the surface of 12-3/4" casing at the request of land owner. He plans to convert this well to a water supply well for irrigation purposes. Your forms for this water supply well will follow.

I, I hereby certify that the information above is true and complete to the best of my knowledge and belief.

W. F. Vagstad Co-owner

DATE 5-5-72

RECEIVED

SEP 30 1986

OCC
HOBBS OFFICE

**NEW MEXICO OIL CONSERVATION COMMISSION
WELL LOCATION AND ACREAGE DEDICATION PLAT**

Form C-102
Supersedes C-128
Effective 1-1-65

All distances must be from the outer boundaries of the Section.

Operator Harvey E. Yates Company			Lease Allen		Well No. 1
Unit Letter N	Section 1	Township 15S	Range 36-E	County Lea	
Actual Footage Location of Well: 660 feet from the South line and 1650 feet from the West line					
Ground Level Elev. 3868	Producing Formation Wolfcamp		Pool NE Caudill		Dedicated Acreage 80 Acres

1. Outline the acreage dedicated to the subject well by colored pencil or hachure marks on the plat below.
2. If more than one lease is dedicated to the well, outline each and identify the ownership thereof (both as to working interest and royalty).
3. If more than one lease of different ownership is dedicated to the well, have the interests of all owners been consolidated by communitization, unitization, force-pooling, etc?

☐ Yes ☐ No If answer is "yes," type of consolidation _____

If answer is "no," list the owners and tract descriptions which have actually been consolidated. (Use reverse side of this form if necessary.) _____

No allowable will be assigned to the well until all interests have been consolidated (by communitization, unitization, forced-pooling, or otherwise) or until a non-standard unit, eliminating such interests, has been approved by the Commission.

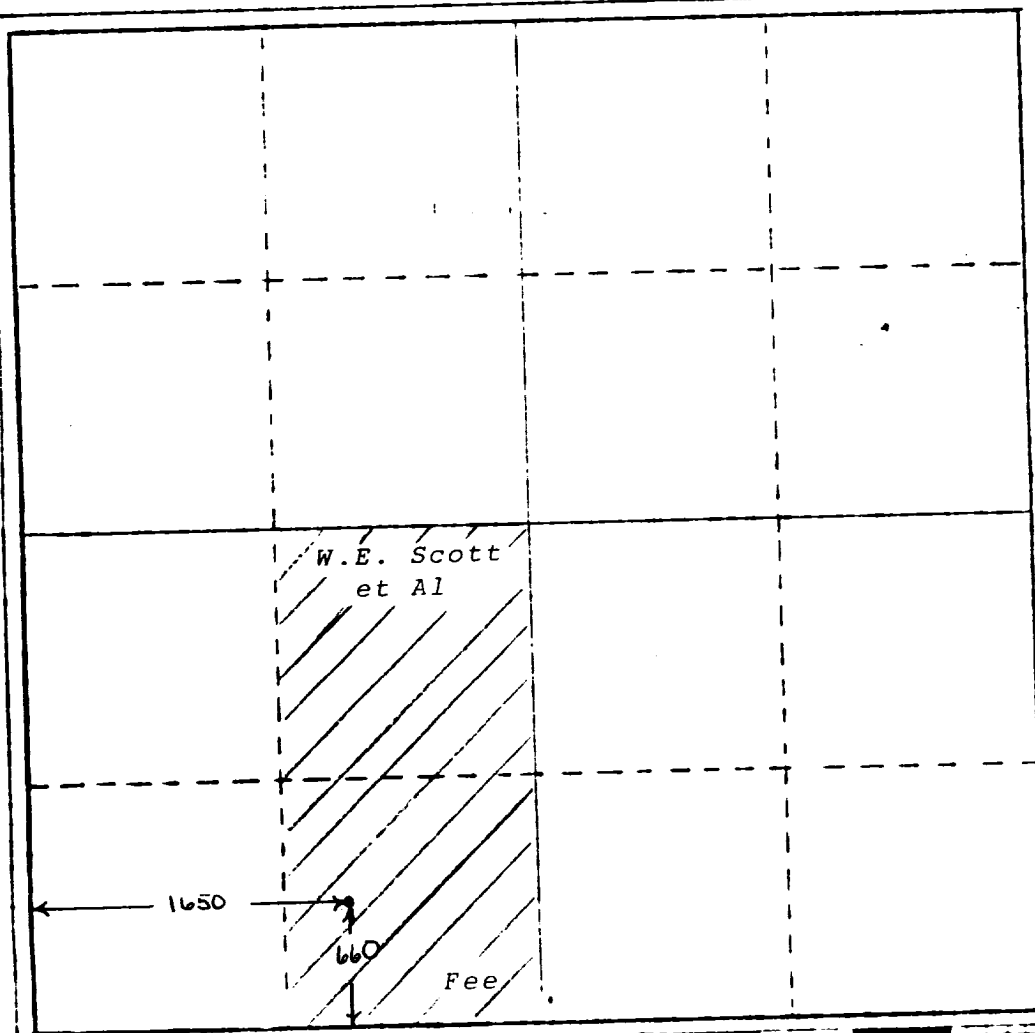

CERTIFICATION

I hereby certify that the information contained herein is true and complete to the best of my knowledge and belief.

N.M. Young

N.M. Young

Location

Drilling superintendent

Company

Harvey E. Yates Company

Date

September 29, 1986

I hereby certify that the well location shown on this plat was plotted from field notes of actual surveys made by me or under my supervision, and that the same is true and correct to the best of my knowledge and belief.

Date Surveyed

Registered Professional Engineer
or Licensed Surveyor

RECEIVED

SEP 30 1986

A.C.D.

HOEBS OFFICE

Harvey E. Yates Company

Allen #1

660' FSL

1650' FWL

Sec 1 T-15S R-36E

Lea Co. N.M.

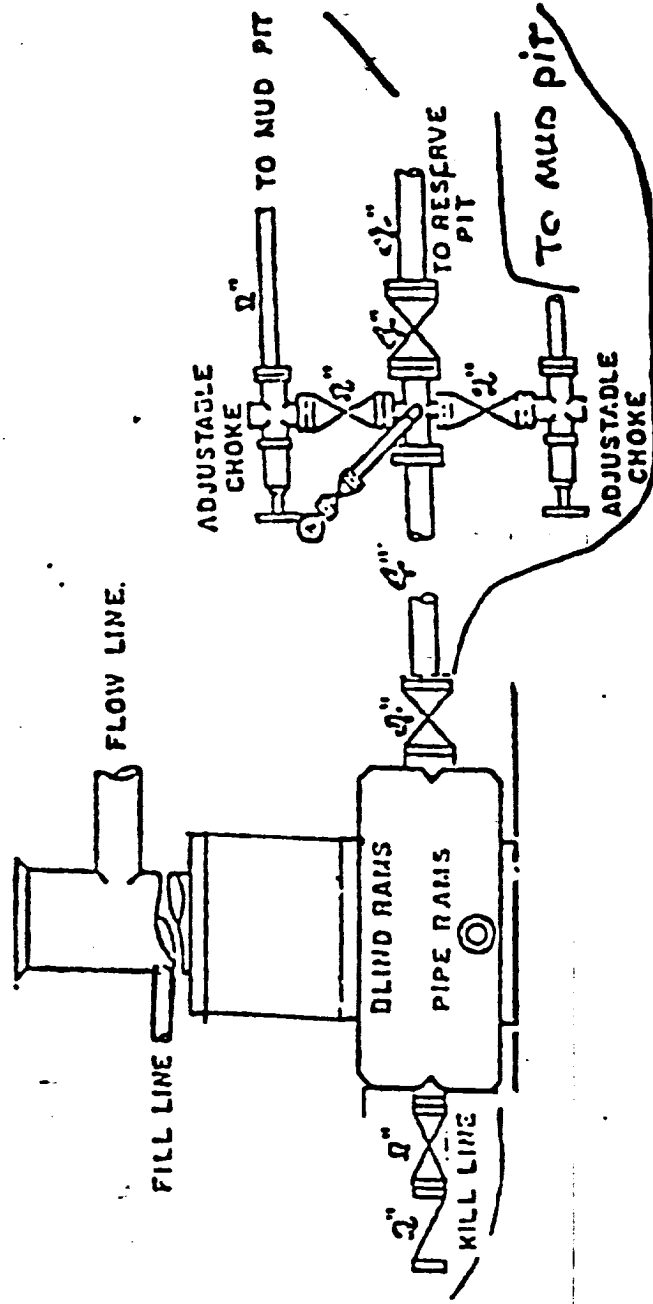

10" X 1500 Series