

UNITED STATES
DEPARTMENT OF THE INTERIOR
GEOLOGICAL SURVEY

APPLICATION FOR PERMIT TO DRILL, DEEPEN, OR PLUG BACK

1a. TYPE OF WORK

DRILL ☒DEEPEN ☐PLUG BACK ☐

b. TYPE OF WELL

OIL
WELL ☒GAS
WELL ☐OTHER ☐SINGLE
ZONE ☒MULTIPLE
ZONE ☐

2. NAME OF OPERATOR

Continental oil Company

3. ADDRESS OF OPERATOR

Box 460 Hobbs, New Mexico

4. LOCATION OF WELL (Report location clearly and in accordance with any State requirements.)*

At surface

1345' FSL and 1295' FWL of Sec 27

At proposed prod. zone

14. DISTANCE IN MILES AND DIRECTION FROM NEAREST TOWN OR POST OFFICE*

15. DISTANCE FROM PROPOSED*

LOCATION TO NEAREST
PROPERTY OR LEASE LINE, FT.
(Also to nearest drlg. unit line, if any)

18. DISTANCE FROM PROPOSED LOCATION*

TO NEAREST WELL, DRILLING, COMPLETED,
OR APPLIED FOR, ON THIS LEASE, FT.

16. NO. OF ACRES IN LEASE

7853

19. PROPOSED DEPTH

4260'

17. NO. OF ACRES ASSIGNED
TO THIS WELL

40

20. ROTARY OR CABLE TOOLS

Rotary

21. ELEVATIONS (Show whether DF, RT, GR, etc.)

3982' est gnd

22. APPROX. DATE WORK WILL START*

5-29-72

23.

PROPOSED CASING AND CEMENTING PROGRAM

SIZE OF HOLE	SIZE OF CASING	WEIGHT PER FOOT	SETTING DEPTH	QUANTITY OF CEMENT
12 1/4"	8 5/8" H-40	20#	1000'	Circ - 475 sacks
7 7/8"	5 1/2" J-55	14#	4260'	300 sacks

It is proposed to drill a straight hole to a TD of 4260' and complete as a Mayburg San Andres producer. Blow-out preventer will be installed. mud program - 0 - 1000' (8.5 - 9.5 # spud mud) and 1000' - 4260' (10-12 # salt gel)

Unorthodox location of this well was approved by NMOC Admin Order NSL-554.

IN ABOVE SPACE DESCRIBE PROPOSED PROGRAM: If proposal is to deepen or plug back, give data on present productive zone and proposed new productive zone. If proposal is to drill or deepen directionally, give pertinent data on subsurface locations and measured and true vertical depths. Give blowout preventer program, if any.

24.

SIGNED

TITLE

Admin. Supervisor

DATE

5-11-72

(This space for Federal or State office use)

PERMIT NO.

APPROVAL DATE

APPROVED
MAY 12 1972

APPROVED BY

TITLE

ARTHUR R. BROWN
DISTRICT ENGINEER

CONDITIONS OF APPROVAL, IF ANY:

*See Instructions On Reverse Side

USGSC(5) MCA(3) File

RECEIVED

MAY 16 1972

OIL CONSERVATION
HOBBS, N. M.

NEW MEXICO OIL CONSERVATION COMMISSION
WELL LOCATION AND ACREAGE DEDICATION PLAT

Form C-102
Supersedes C-128
Effective 1-1-65

All distances must be from the outer boundaries of the Section.

Operator CONTINENTAL OIL COMPANY			Lease M C A UNIT			Well No. 315
Unit Letter L	Section 27	Township 17 South	Range 32 East	County Lea		
Actual Footage Location of Well: 1345 feet from the South line and 1295 feet from the West line						
Ground Level Elev.	Producing Formation Grayburg San Andres		Pool Maly G-SA Repres		Dedicated Acreage: 40 Acres	

1. Outline the acreage dedicated to the subject well by colored pencil or hachure marks on the plat below.
2. If more than one lease is dedicated to the well, outline each and identify the ownership thereof (both as to working interest and royalty).
3. If more than one lease of different ownership is dedicated to the well, have the interests of all owners been consolidated by communitization, unitization, force-pooling, etc?

☐ Yes ☐ No If answer is "yes," type of consolidation _____

If answer is "no," list the owners and tract descriptions which have actually been consolidated. (Use reverse side of this form if necessary.) _____

No allowable will be assigned to the well until all interests have been consolidated (by communitization, unitization, forced-pooling, or otherwise) or until a non-standard unit, eliminating such interests, has been approved by the Commission.

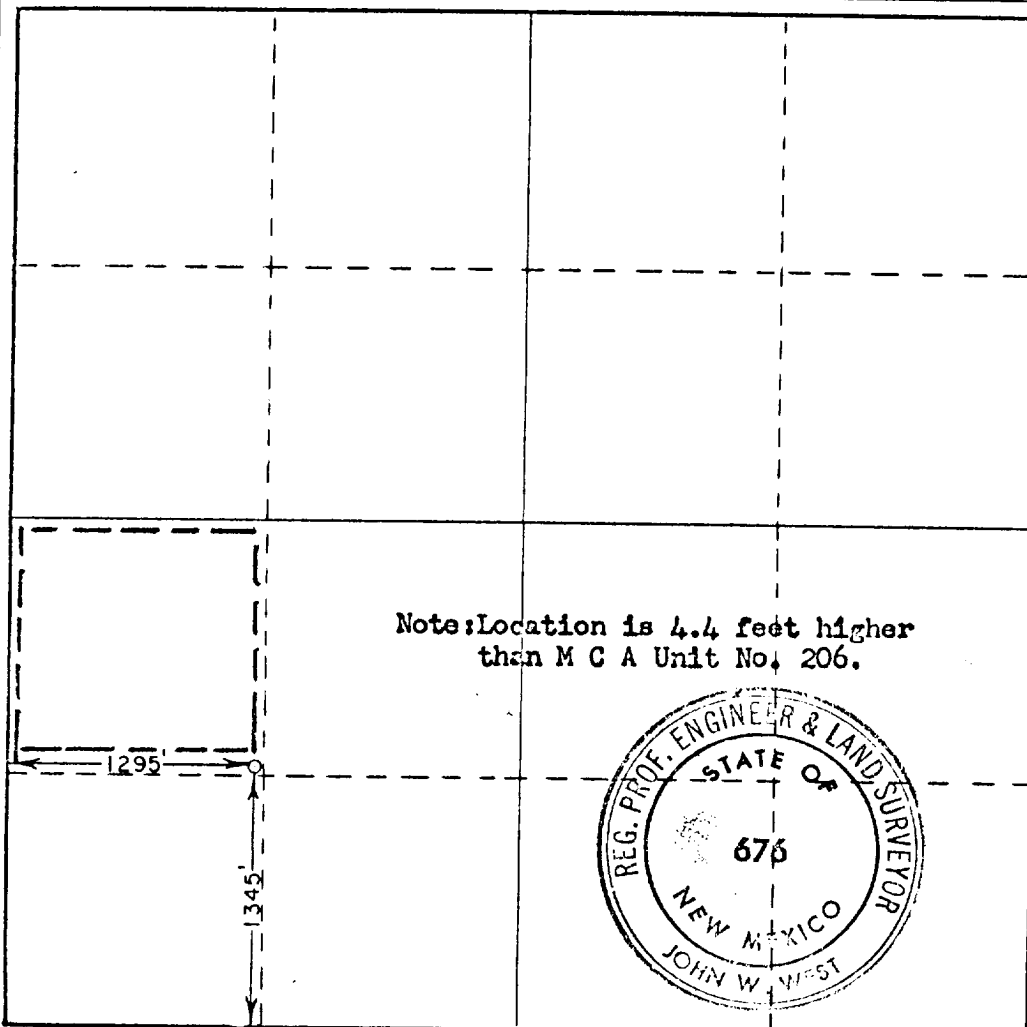

CERTIFICATION

I hereby certify that the information contained herein is true and complete to the best of my knowledge and belief.

Name *John W. West*
Position *Admin Supervisor*
Company *Continental Oil Co*
Date *May 11, 1972*

I hereby certify that the well location shown on this plat was plotted from field notes of actual surveys made by me or under my supervision, and that the same is true and correct to the best of my knowledge and belief.

Date Surveyed
April 29, 1972

Registered Professional Engineer and/or Land Surveyor

John W West

Certificate No. **676**

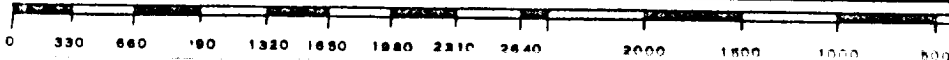

RECEIVED

MAY 16 1972

OIL CONSERVATION COMM.
HOBBS, N. M.