

NO. OF COPIES RECEIVED	
DISTRIBUTION	
SANTA FE	
FILE	
U.S.G.S.	
LAND OFFICE	
OPERATOR	

NEW MEXICO OIL CONSERVATION COMMISSION

Form C-101
Revised 1-1-65

5A. Indicate Type of Lease	
STATE <input checked="" type="checkbox"/>	FEE <input type="checkbox"/>
5. State Oil & Gas Lease No.	
B-2148	

APPLICATION FOR PERMIT TO DRILL, DEEPEN, OR PLUG BACK

1a. Type of Work		7. Unit Agreement Name	
b. Type of Well OIL WELL <input checked="" type="checkbox"/> GAS WELL <input type="checkbox"/> OTHER <input type="checkbox"/>		8. Farm or Lease Name State 18-B	
2. Name of Operator Murphy H. Baxter		9. Well No. 9	
3. Address of Operator 814 Bldg. of the Southwest, Midland, Texas 79701		10. Field and Pool, or Wildcat Maljamar (G-SA)	
4. Location of Well UNIT LETTER O LOCATED 1310' FEET FROM THE South LINE AND 1330' FEET FROM THE East LINE OF SEC. 18 TWP. 17S RGE. 33E NMPM		12. County Lea	
19. Proposed Depth 4500'		19A. Formation Grayburg-SA	
20. Rotary or C.T. Rotary		21. Elevations (Show whether DF, RT, etc.) 4190.0 GL	
21A. Kind & Status Plug. Bond Blanket-Current		21B. Drilling Contractor Cactus Drilling Company	
22. Approx. Date Work will start November 24, 1972			

23.

PROPOSED CASING AND CEMENT PROGRAM

SIZE OF HOLE	SIZE OF CASING	WEIGHT PER FOOT	SETTING DEPTH	SACKS OF CEMENT	EST. TOP
12-1/4"	8-5/8"	24	350	300	Circulated
7-7/8"	5-1/2"	14	4500	450	2500'

APPROVAL VALID
FOR 90 DAYS
DURING WHICH PERIOD

EXPIRES 2-29-73

IN ABOVE SPACE DESCRIBE PROPOSED PROGRAM: IF PROPOSAL IS TO DEEPEN OR PLUG BACK, GIVE DATA ON PRESENT PRODUCTIVE ZONE AND PROPOSED NEW PRODUCTIVE ZONE. GIVE BLOWOUT PREVENTER PROGRAM, IF ANY.

I hereby certify that the information above is true and complete to the best of my knowledge and belief.

Signed W. H. Sumner Title Petroleum Engineer Date November 20, 1972

(This space for State Use)

APPROVED BY [Signature] TITLE SUPERVISOR DISTRICT I DATE NOV 29 1972

CONDITIONS OF APPROVAL, IF ANY:

**NEW MEXICO OIL CONSERVATION COMMISSION
WELL LOCATION AND ACREAGE DEDICATION PLAT**

Form C-102
Supersedes C-128
Effective 1-1-65

All distances must be from the outer boundaries of the Section.

Operator MURPHY H. BAXTER			Lease STATE 18 B		Well No. 9
Unit Letter O	Section 18	Township 17 SOUTH	Range 33 EAST	County LEA	
Actual Footage Location of Well: <div style="display: flex; justify-content: space-between;"> 1310 feet from the SOUTH line and 1330 feet from the EAST line </div>					
Ground Level Elev. 4190	Producing Formation Grayburg-San Andres	Pool Maljamar (Grayburg-SA)	Dedicated Acreage: Acres		

1. Outline the acreage dedicated to the subject well by colored pencil or hachure marks on the plat below.
2. If more than one lease is dedicated to the well, outline each and identify the ownership thereof (both as to working interest and royalty).
3. If more than one lease of different ownership is dedicated to the well, have the interests of all owners been consolidated by communitization, unitization, force-pooling, etc?

☐ Yes ☐ No If answer is "yes," type of consolidation _____

If answer is "no," list the owners and tract descriptions which have actually been consolidated. (Use reverse side of this form if necessary.) _____

No allowable will be assigned to the well until all interests have been consolidated (by communitization, unitization, forced-pooling, or otherwise) or until a non-standard unit, eliminating such interests, has been approved by the Commission.

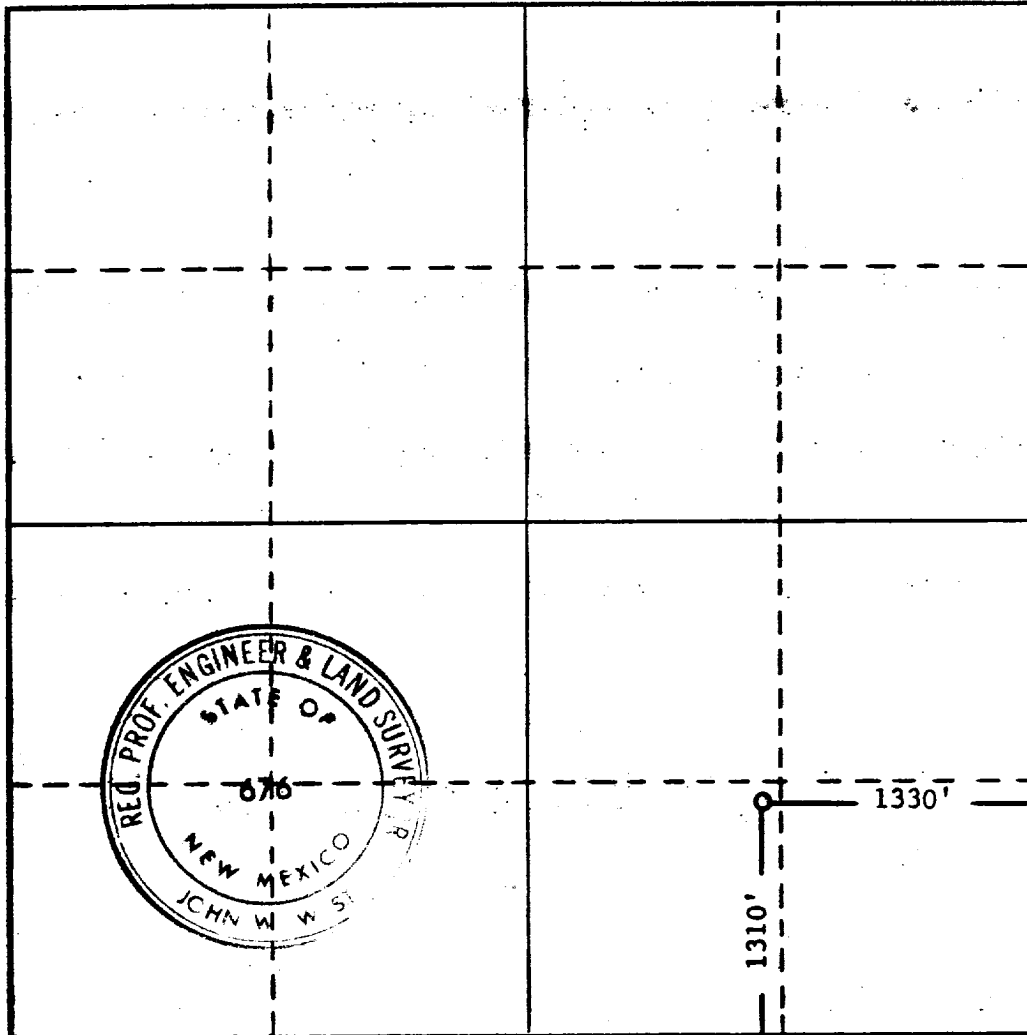

CERTIFICATION

I hereby certify that the information contained herein is true and complete to the best of my knowledge and belief.

Stacy E. Lopez
Name

Production Foreman

Position

Murphy H. Baxter

Company

November 20, 1972

Date

I hereby certify that the well location shown on this plat was plotted from field notes of actual surveys made by me or under my supervision, and that the same is true and correct to the best of my knowledge and belief.

Date Surveyed

11-16-1972

Registered Professional Engineer and/or Land Surveyor

John W. West
Certificate No.

676

0 330 660 990 1320 1650 1980 2310 2640 2970 3300 3630 3960 4290 4620 4950 5280 5610 5940 6270 6600