

| | |
|------------------------|--|
| NO. OF COPIES RECEIVED | |
| DISTRIBUTION | |
| SANTA FE | |
| FILE | |
| U.S.G.S. | |
| LAND OFFICE | |
| OPERATOR | |

NEW MEXICO OIL CONSERVATION COMMISSION

Form C-101
Revised 1-1-65

| | |
|---|------------------------------|
| 5A. Indicate Type of Lease | |
| STATE <input checked="" type="checkbox"/> | FEE <input type="checkbox"/> |
| 5. State Oil & Gas Lease No. B-2229 | |

APPLICATION FOR PERMIT TO DRILL, DEEPEN, OR PLUG BACK

| | | | |
|---|--|---|--|
| 1a. Type of Work | | 7. Unit Agreement Name | |
| b. Type of Well DRILL <input checked="" type="checkbox"/> DEEPEN <input type="checkbox"/> PLUG BACK <input type="checkbox"/> OIL WELL <input checked="" type="checkbox"/> GAS WELL <input type="checkbox"/> OTHER <input type="checkbox"/> SINGLE ZONE <input checked="" type="checkbox"/> MULTIPLE ZONE <input type="checkbox"/> | | 8. Farm or Lease Name Phillips E State | |
| 2. Name of Operator Phillips Petroleum Company | | 9. Well No. 16 | |
| 3. Address of Operator Room 711, Phillips Building, Odessa, Texas 79761 | | 10. Field and Pool, or Wildcat San Maljamar Grayburg/Andres | |
| 4. Location of Well UNIT LETTER K LOCATED 2310 FEET FROM THE south LINE 2307 FEET FROM THE west LINE OF SEC. 10 TWP. 17-S RGE. 33-E NMPM | | 12. County Lea | |
| 21. Elevations (Show whether D.F., RT, etc.) Later | | 20. Rotary or C.T. Rotary | |
| 21A. Kind & Status Plug. Bond Blanket | | 22. Approx. Date Work will start Upon approval. | |
| 21B. Drilling Contractor Later | | 13. Proposed Depth 4600' | |
| | | 14A. Formation San Andres | |

23. PROPOSED CASING AND CEMENT PROGRAM

| SIZE OF HOLE | SIZE OF CASING | WEIGHT PER FOOT | SETTING DEPTH | SACKS OF CEMENT | EST. TOP |
|--------------|----------------|-----------------|---------------|-----------------|------------|
| 12-1/4" | 8-5/8" | 20# | 350' | 300 | Circulate. |
| 7-7/8" | 4-1/2" | 11.6# | T.D. | 300 | 2800' |

Use Series 900 BOP, hydraulically operated.
Use mud additives as required for control.

APPROVAL VALID
FOR 90 DAYS UNLESS
DRILLING COMMENCED,

EXPIRES 3-1-73

IN ABOVE SPACE DESCRIBE PROPOSED PROGRAM: IF PROPOSAL IS TO DEEPEN OR PLUG BACK, GIVE DATA ON PRESENT PRODUCTIVE ZONE AND PROPOSED NEW PRODUCTIVE ZONE. GIVE BLOWOUT PREVENTER PROGRAM, IF ANY.

I hereby certify that the information above is true and complete to the best of my knowledge and belief.

Signature W. J. Mueller Title Senior Reservoir Engineer Date 11-28-72

(This space for State Use)

APPROVED BY [Signature] TITLE SUPERVISOR DISTRICT I DATE DEC 1 1972

CONDITIONS OF APPROVAL, IF ANY:

RECEIVED

NOV 5 1972

OIL CONSERVATION COMM.
HOBBS, N. M.

NEW MEXICO OIL CONSERVATION COMMISSION
WELL LOCATION AND ACREAGE DEDICATION PLAT

Form C-102
Supersedes C-128
Effective 1-1-65

All distances must be from the outer boundaries of the Section

| | | | | | |
|--|--|-----------------------------|--|--------------------------------|-----------------------|
| Operator PHILLIPS PETROLEUM COMPANY | | | Lease PHILLIPS "E" State | | Well No. 16 |
| Unit Letter K | Section 10 | Township 17 SOUTH | Range 33 EAST | County LEA | |
| Actual Footage Location of Well: 2310 feet from the SOUTH line and 2307 feet from the WEST line | | | | | |
| Ground Level Elev. 4143.9 | Producing Formation <i>Gravelly Sandstone</i> | | Pool <i>McJannet - Gravelly Sandstone</i> | Dedicated Acreage 40 | |

1. Outline the acreage dedicated to the subject well by colored pencil or hachure marks on the plat below.
2. If more than one lease is dedicated to the well, outline each and identify the ownership thereof (both as to working interest and royalty).
3. If more than one lease of different ownership is dedicated to the well, have the interests of all owners been consolidated by communitization, unitization, force-pooling, etc?

☐ Yes ☐ No If answer is "yes," type of consolidation _____

If answer is "no," list the owners and tract descriptions which have actually been consolidated. (Use reverse side of this form if necessary.) _____

No allowable will be assigned to the well until all interests have been consolidated (by communitization, unitization, forced-pooling, or otherwise) or until a non-standard unit, eliminating such interests, has been approved by the Commission.

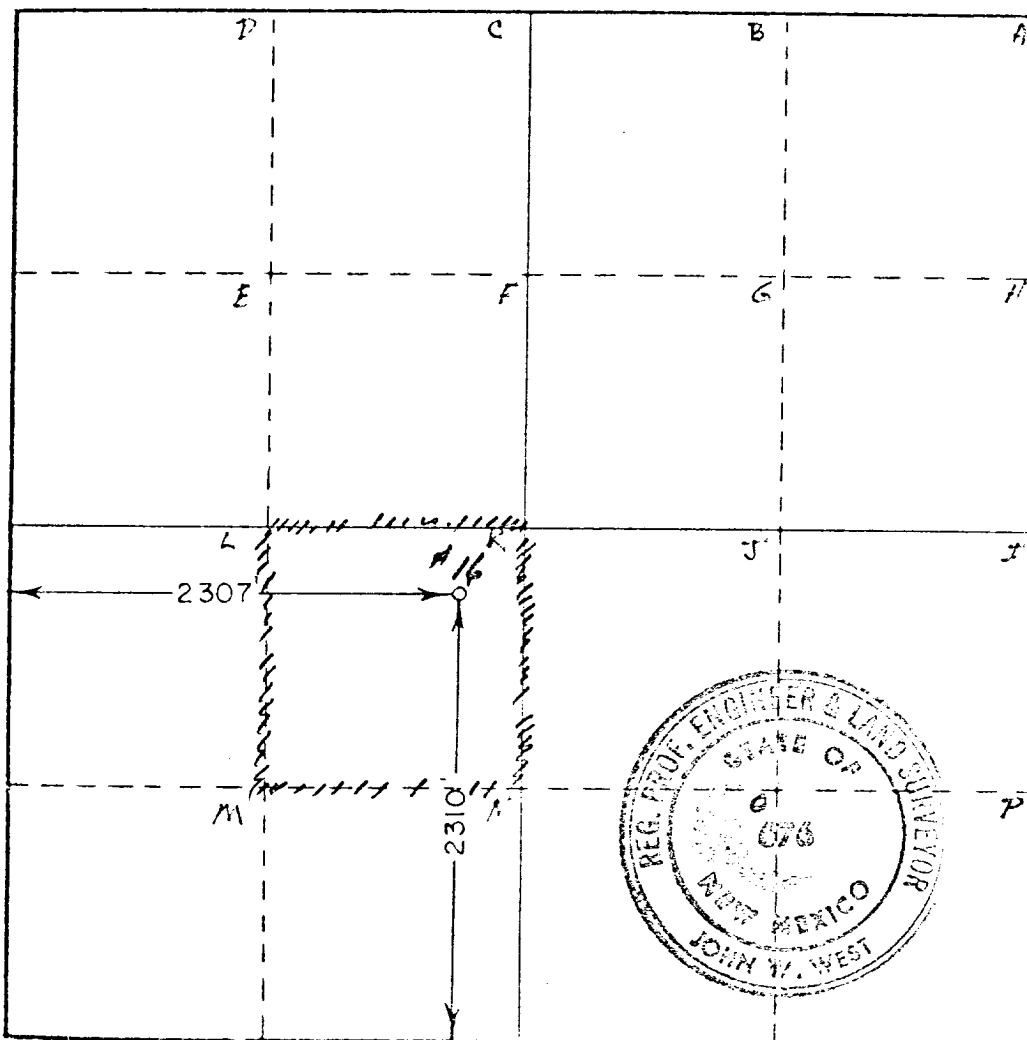

CERTIFICATION

I hereby certify that the information contained herein is true and complete to the best of my knowledge and belief.

[Signature]

Position

Senior Reservoir Engineer

Company

Phillips Petroleum Company

Date

I hereby certify that the well location shown on this plat was plotted from field notes of actual surveys made by me or under my supervision, and that the same is true and correct to the best of my knowledge and belief.

Date Surveyed

NOVEMBER 25, 1972

Registered Professional Engineer
and/or Land Surveyor

[Signature]

Certificate No.

11A

RECEIVED

NO 01 1972

OIL CONSERVATION COMM.
HOBBBS N. M.