

NO. OF COPIES RECEIVED	
DISTRIBUTION	
SANTA FE	
FILE	
U.S.G.S.	
LAND OFFICE	
OPERATOR	

NEW MEXICO OIL CONSERVATION COMMISSION

Form C-101
Revised 1-1-65

5A. Indicate Type of Lease	
STATE <input type="checkbox"/>	FEE <input checked="" type="checkbox"/>

5. State Oil & Gas Lease No.

APPLICATION FOR PERMIT TO DRILL, DEEPEN, OR PLUG BACK

1a. Type of Work		7. Unit Agreement Name	
b. Type of Well OIL WELL <input type="checkbox"/> GAS WELL <input checked="" type="checkbox"/> OTHER <input type="checkbox"/>		8. Farm or Lease Name E. L. HARRAD	
2. Name of Operator GREAT WESTERN DRILLING COMPANY		9. Well No. 1	
3. Address of Operator BOX 1659, MIDLAND, TEXAS 79701		10. Field and Pool, or Wildcatting WILBEAT	
4. Location of Well UNIT LETTER I LOCATED 1980 FEET FROM THE South LINE AND 660 FEET FROM THE East LINE OF SEC. 7 TWP. 16-S RGE. 35-E NMPM		12. County LEA	
19. Proposed Depth 12,800		19A. Formation MORROW	
20. Rotary or C.T. ROTARY		21. Elevations (Show whether DF, RT, etc.) 4039.9' GR	
21A. Kind & Status Plug. Bond BLANKET		21B. Drilling Contractor	
22. Approx. Date Work will start 12-15-72			

PROPOSED CASING AND CEMENT PROGRAM

SIZE OF HOLE	SIZE OF CASING	WEIGHT PER FOOT	SETTING DEPTH	SACKS OF CEMENT	EST. TOP
17 1/2"	13 3/8"	48#	300'	350	Circulate
11 "	8 5/8"	24# & 32#	4,700'	2000	Circulate
7 7/8 "	4 1/2"	13.5# & 11.6#	12,800'	500	

Objective: Morrow Formation

Logging: Gamma Ray-Sonic and Induction Electric from base of intermediate to total depth.

Mud Program: Fresh water to 10,700'. From 10,700' to T.D., fresh water gel, weight 10.5# to 10.7#/gal., viscosity 36 to 40.

Blowout Preventer: 10" Cameron Series 900 with blank and pipe rams and remote hydraulic controls. Preventer will be tested every 24 hours.

APPROVAL VALID
FOR 90 DAYS UNLESS
DRILLING COMMENCED,

EXPIRES 3-8-73

IN ABOVE SPACE DESCRIBE PROPOSED PROGRAM: IF PROPOSAL IS TO DEEPEN OR PLUG BACK, GIVE DATA ON PRESENT PRODUCTIVE ZONE AND PROPOSED NEW PRODUCTIVE ZONE. GIVE BLOWOUT PREVENTER PROGRAM, IF ANY.

I hereby certify that the information above is true and complete to the best of my knowledge and belief.

Signed [Signature] Title **Chief Engineer** Date **12-4-72**

(This space for State Use)

APPROVED BY [Signature] TITLE **SUPERVISOR DISTRICT I** DATE **DEC 8 1972**

CONDITIONS OF APPROVAL, IF ANY:

NEW MEXICO OIL CONSERVATION COMMISSION
WELL LOCATION AND ACREAGE DEDICATION PLAT

Form C-102
Supersedes C-128
Effective 1-1-65

All distances must be from the outer boundaries of the Section.

Operator GREAT WESTERN DRILLING CO.		Lease E. L. HARRAD		Well No. 1
Unit Letter I	Section 7	Township 16 SOUTH	Range 35 EAST	County LEA
Actual Footage Location of Well: 1980 feet from the SOUTH line and 660 feet from the EAST line				
Ground Level Elev. 4039.9	Producing Formation Morrow	Pool Wildcat	Dedicated Acreage: 320 Acres	

1. Outline the acreage dedicated to the subject well by colored pencil or hatchure marks on the plat below.
2. If more than one lease is dedicated to the well, outline each and identify the ownership thereof (both as to working interest and royalty).
3. If more than one lease of different ownership is dedicated to the well, have the interests of all owners been consolidated by communitization, unitization, force-pooling, etc?

☒ Yes ☐ No If answer is "yes," type of consolidation Communitization

If answer is "no," list the owners and tract descriptions which have actually been consolidated. (Use reverse side of this form if necessary.) None

No allowable will be assigned to the well until all interests have been consolidated (by communitization, unitization, forced-pooling, or otherwise) or until a non-standard unit, eliminating such interests, has been approved by the Commission.

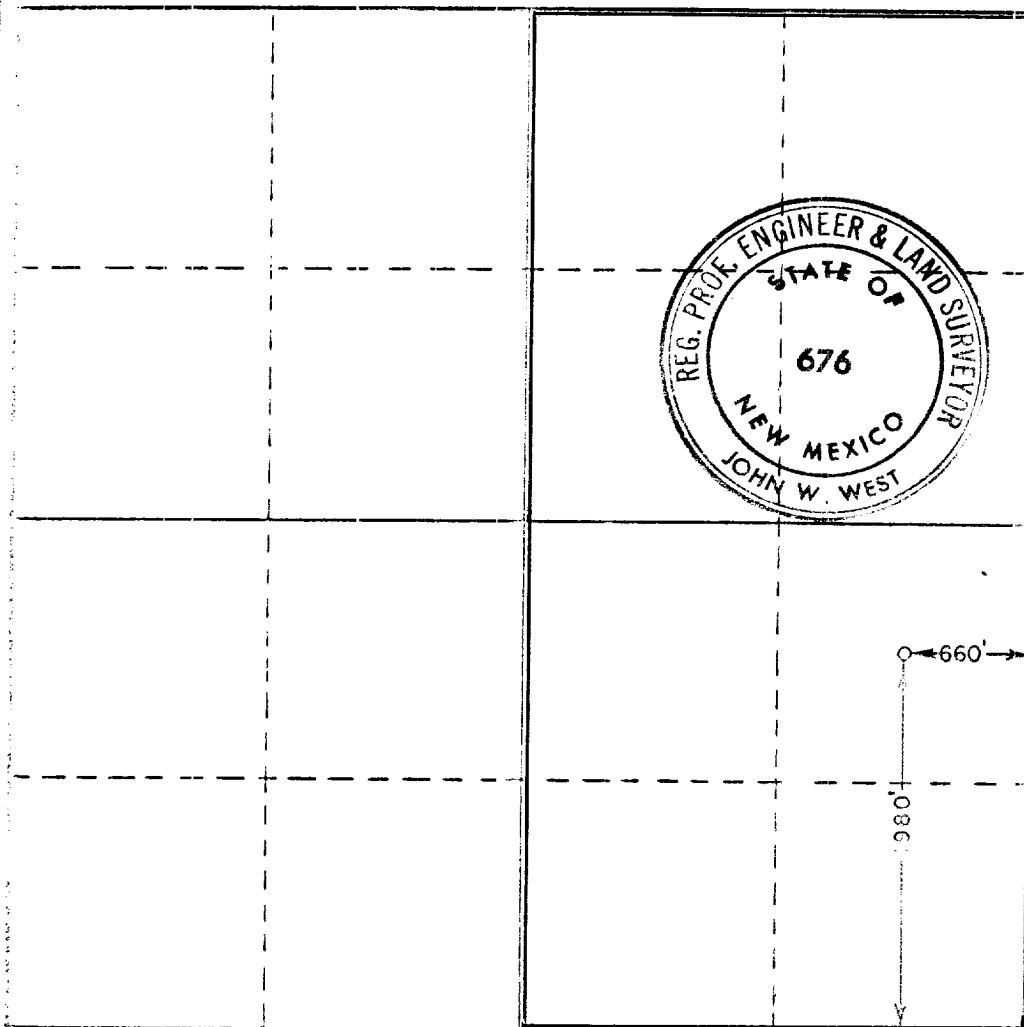

CERTIFICATION

I hereby certify that the information contained herein is true and complete to the best of my knowledge and belief.

R. I. Comstock
Name

R. I. Comstock
Position

Chief Engineer
Company

Great Western Drlg. Co.
Date

December 4, 1972

I hereby certify that the well location shown on this plat was plotted from field notes of actual surveys made by me or under my supervision, and that the same is true and correct to the best of my knowledge and belief.

Date Surveyed

NOVEMBER 27, 1972

Registered Professional Engineer
and/or Land Surveyor

John W. West
Certificate No.

676

0 330 660 990 1320 1650 1980 2310 2640 2970 3300

173

100-20000

[illegible]