

UNITED STATES
DEPARTMENT OF THE INTERIOR
GEOLOGICAL SURVEY

30-025-24352

APPLICATION FOR PERMIT TO DRILL, DEEPEN, OR PLUG BACK

1a. TYPE OF WORK
DRILL ☒ DEEPEN ☐ PLUG BACK ☐

b. TYPE OF WELL
OIL WELL ☒ GAS WELL ☐ OTHER ☐ SINGLE ZONE ☒ MULTIPLE ZONE ☐

2. NAME OF OPERATOR
Continental Oil Company

3. ADDRESS OF OPERATOR
Box 460 Hobbs, New Mexico

4. LOCATION OF WELL (Report location clearly and in accordance with any state requirements.)
At surface
1295' FSL and 1295' FEL of Sec 28
At proposed prod. zone
Same

14. DISTANCE IN MILES AND DIRECTION FROM NEAREST TOWN OR POST OFFICE*

5. LEASE DESIGNATION AND SERIAL NO.
LC-057210

6. IF INDIAN, ALLOTTEE OR TRIBE NAME

7. UNIT AGREEMENT NAME
MCA

8. FARM OR LEASE NAME
MCA Unit

9. WELL NO.
333

10. FIELD AND POOL, OR WILDCAT
Maj G-5A Repres

11. SEC., T., R., M., OR BLK. AND SURVEY OR AREA
Sec 28, T-17S, R-32E

12. COUNTY OR PARISH
Lea

13. STATE
N. Mexico

15. DISTANCE FROM PROPOSED* LOCATION TO NEAREST PROPERTY OR LEASE LINE, FT. (Also to nearest drig. unit line, if any)

16. NO. OF ACRES IN LEASE
7853

17. NO. OF ACRES ASSIGNED TO THIS WELL
40

18. DISTANCE FROM PROPOSED LOCATION* TO NEAREST WELL, DRILLING, COMPLETED, OR APPLIED FOR, ON THIS LEASE, FT.

19. PROPOSED DEPTH

20. ROTARY OR CABLE TOOLS
Rotary

21. ELEVATIONS (Show whether DF, RT, GR, etc.)

22. APPROX. DATE WORK WILL START*
1-25-73

23. PROPOSED CASING AND CEMENTING PROGRAM

SIZE OF HOLE	SIZE OF CASING	WEIGHT PER FOOT	SETTING DEPTH	QUANTITY OF CEMENT
12 1/4"	8 5/8", H-40	20#	925'	Cement - 470 Sacks
7 7/8"	5 1/2", J-55	14#	4175'	500 Sacks

It is proposed to drill a straight hole to a T D of 4175' and complete as a Grayberg Son Andres producer. mud Program (0-925-8.5-9.5 Spud mud) and 925'-4175' mud Program (9.0-10.5 salt gel). Sufficient blowout prevention protection will be installed prior to commencing work.

V-door of drilling rig will face to the west. The drilling pod is 180' X 130' and the pits 200' X 200'.

IN ABOVE SPACE DESCRIBE PROPOSED PROGRAM: If proposal is to deepen or plug back, give data on present productive zone and proposed new productive zone. If proposal is to drill or deepen directionally, give pertinent data on subsurface locations and measured and true vertical depths. Give blowout prevention program, if any.

24. SIGNED Robert Gault II TITLE Admin. Supervisor DATE 1-11-73

(This space for Federal or State office use)

PERMIT NO. _____ APPROVED _____

APPROVED BY _____ TITLE _____ DATE _____

CONDITIONS OF APPROVAL, IF ANY:

APPROVED
JAN 22 1973
ARTHUR R. BROWN
DISTRICT ENGINEER

*See Instructions On Reverse Side

110005 MCA-3 File

NEW MEXICO OIL CONSERVATION COMMISSION
WELL LOCATION AND ACREAGE DEDICATION PL

Form C-102
Supersedes C-128
Effective 1-1-65

All distances must be from the outer boundaries of the Section

Operator CONTINENTAL OIL COMPANY		Lease MCA UNIT		Well No. 333
Unit Letter P	Section 28	Township 17 SOUTH	Range 32 EAST	County LEA
Actual Footage Location of Well: 1295 feet from the SOUTH line and 1295 feet from the EAST line				
Ground Level Elev.	Producing Formation Grayburg San Andres	Pool Malj G-SA Repress	Dedicated Acreage: 40 Acres	

- Outline the acreage dedicated to the subject well by colored pencil or hachure marks on the plat below.
- If more than one lease is dedicated to the well, outline each and identify the ownership thereof (both as to working interest and royalty).
- If more than one lease of different ownership is dedicated to the well, have the interests of all owners been consolidated by communitization, unitization, force-pooling, etc?

☐ Yes ☐ No If answer is "yes," type of consolidation _____

If answer is "no," list the owners and tract descriptions which have actually been consolidated. (Use reverse side of this form if necessary.) _____

No allowable will be assigned to the well until all interests have been consolidated (by communitization, unitization, forced-pooling, or otherwise) or until a non-standard unit, eliminating such interests, has been approved by the Commission.

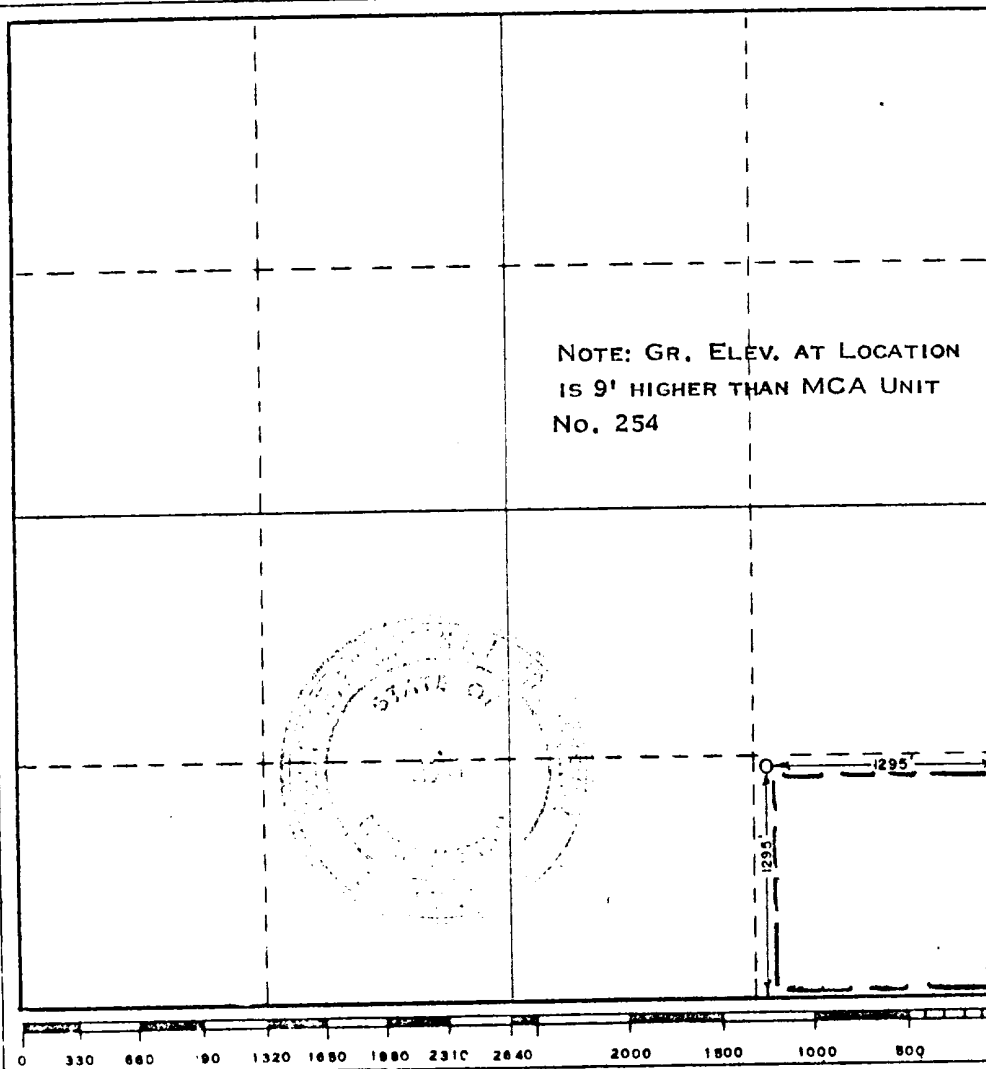

CERTIFICATION

I hereby certify that the information contained herein is true and complete to the best of my knowledge and belief.

Name Robert Gault III
Position Admin. Supervisor
Company Continental Oil Co
Date January 11, 1973

I hereby certify that the well location shown on this plat was plotted from field notes of actual surveys made by me or under my supervision, and that the same is true and correct to the best of my knowledge and belief.

Date Surveyed DECEMBER 30, 1972
Registered Professional Engineer and/or Land Surveyor John W West
Certificate No. 676

ENVIRONMENT CONSIDERATION STATEMENT

Application to Drill on Federal Leases

The attached plat shows the existing roads and, by red coloring, the proposed roads to service the proposed well. The plat also shows the location of tank battery and flowlines. There are no camps or airstrips contemplated to serve this lease.

Litter, such as paper, scrap iron, etc., will be picked up and hauled away. Salt water and other undesirable liquids will be picked up for disposal in approved disposal wells. Mud, drill cuttings, and other inert material will be disposed of by burying in the reserve pit when it is abandoned and the surface restored to level condition.

The second plat shows the proposed layout of the drilling rig in relation to the pad and shows the location of mud tanks, reserve pits, pipe racks, etc.

R-32-E

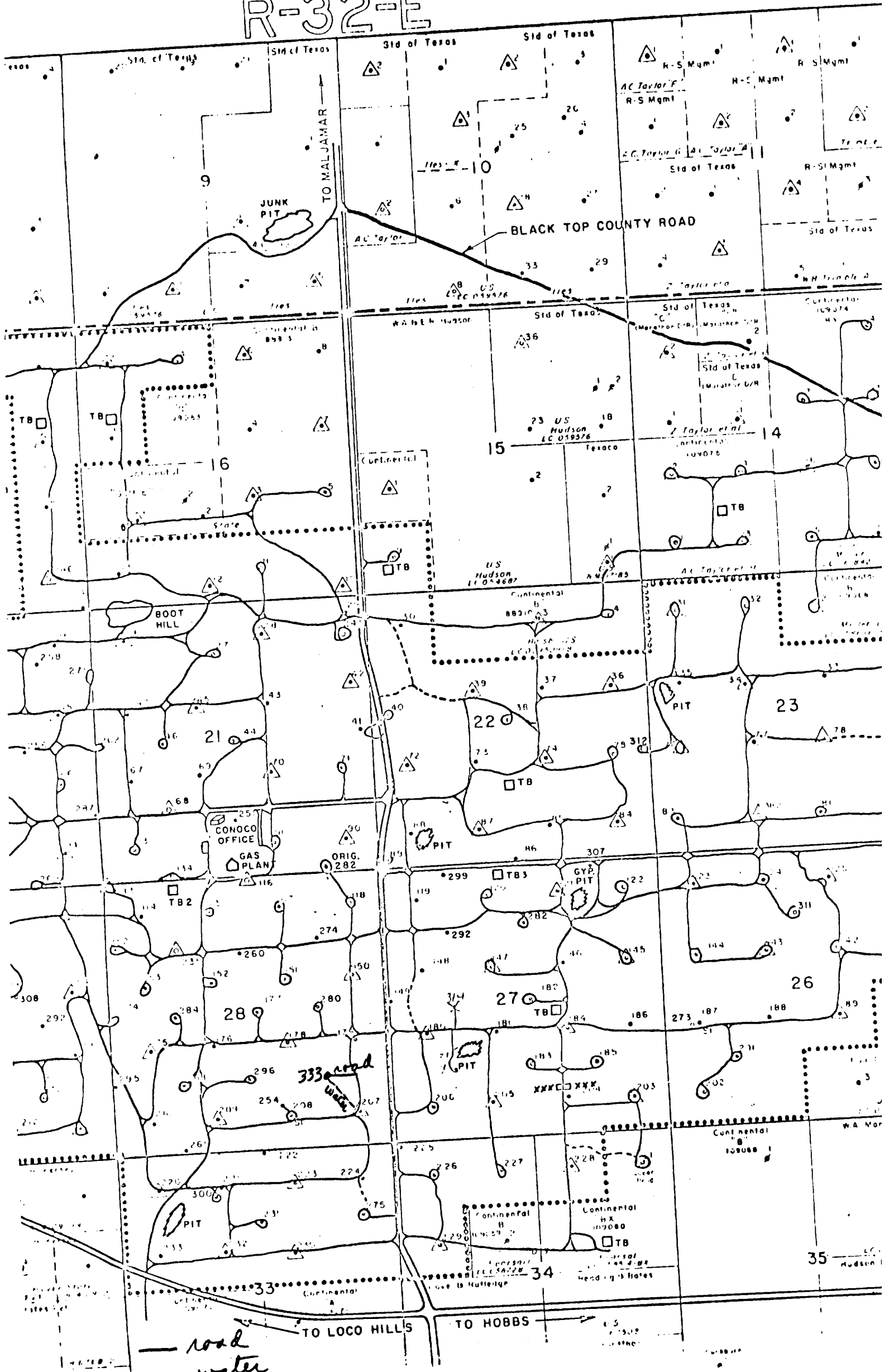

CACTUS DRILLING CO.

RIG # 52

CONTINENTAL OIL CO.

MCA UNIT

MALJAHAR WATER FLOOD

LEA CO., NEW MEXICO

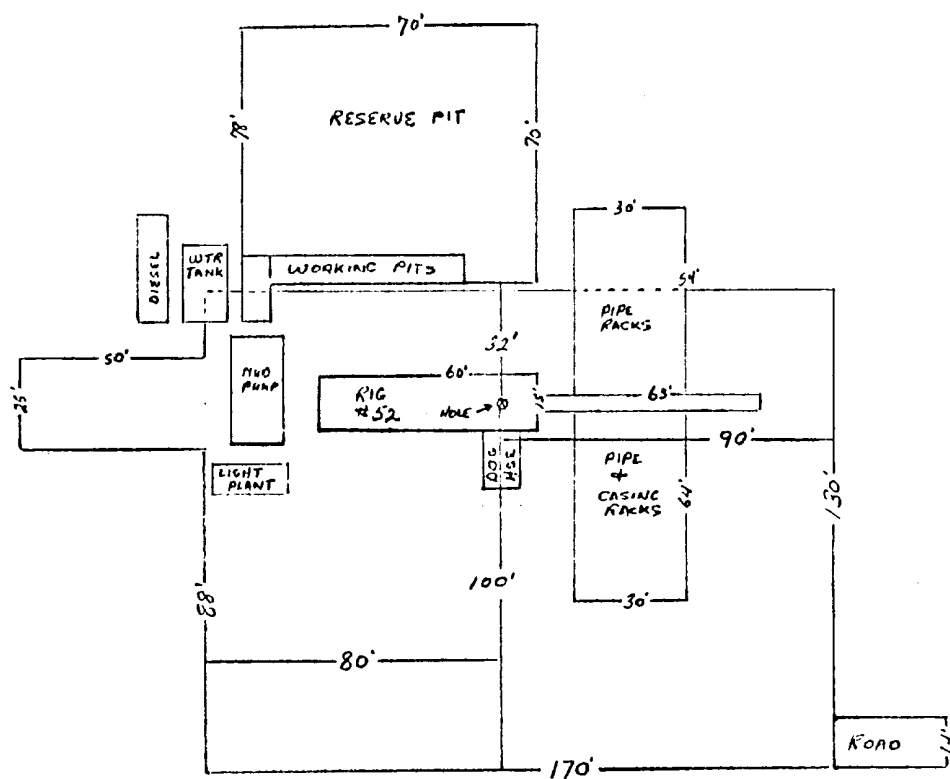

LOCATION:

130' - N to S

170' - E to W

HOLE: 30' FNL

80' FWL

100' FSL

90' FEL

25' X 50' STINGER ON WEST SIDE
OF LOCATION FOR TRAILER MTD RIG.

3/16 INCH = 10 FOOT