

UNITED STATES
DEPARTMENT OF THE INTERIOR
GEOLOGICAL SURVEY

058396

APPLICATION FOR PERMIT TO DRILL, DEEPEN, OR PLUG BACK

1a. TYPE OF WORK
DRILL ☒ DEEPEN ☐ PLUG BACK ☐

b. TYPE OF WELL
OIL WELL ☒ GAS WELL ☐ OTHER ☐ SINGLE ZONE ☒ MULTIPLE ZONE ☐

2. NAME OF OPERATOR
Continental oil Company

3. ADDRESS OF OPERATOR
Box 460 Hobbs, New Mexico

4. LOCATION OF WELL (Report location clearly and in accordance with any State requirements.)
At surface
2615' FNL and 25' FEL of Sec 27
At proposed prod. zone

14. DISTANCE IN MILES AND DIRECTION FROM NEAREST TOWN OR POST OFFICE*

15. DISTANCE FROM PROPOSED*
LOCATION TO NEAREST
PROPERTY OR LEASE LINE, FT.
(Also to nearest drlg. unit line, if any)

18. DISTANCE FROM PROPOSED LOCATION*
TO NEAREST WELL, DRILLING, COMPLETED,
OR APPLIED FOR, ON THIS LEASE, FT.

21. ELEVATIONS (Show whether DF, RT, GR, etc.)

23. PROPOSED CASING AND CEMENTING PROGRAM

SIZE OF HOLE	SIZE OF CASING	WEIGHT PER FOOT	SETTING DEPTH	QUANTITY OF CEMENT
12 1/4"	8 5/8" J-40	20 #	975'	Circ - 500 sacks
7 7/8"	5 1/2" J-55	14 #	4280'	450 sacks

It is proposed to drill a straight hole to a TD of 4280' and complete as a Shayberg Son Andres producer. Sufficient blowout prevention protection will be installed prior to work. mud program - 0-975' (8.5-9.5 Spud Mud) and 975'-4280' (9.0-10.5 Salt gel).

The v-door of drilling rig will face to the east. The drilling pod will be 180' x 130' and the pits 200' x 200'.

IN ABOVE SPACE DESCRIBE PROPOSED PROGRAM: If proposal is to deepen or plug back, give data on present productive zone and proposed new productive zone. If proposal is to drill or deepen directionally, give pertinent data on subsurface locations and measured and true vertical depths. Give blowout prevention program, if any.

24. SIGNED: Robert Gault III TITLE: Admin. Supervisor DATE: 2-8-73

(This space for Federal or State office use)

PERMIT NO. APPROVAL DATE

APPROVED BY TITLE DATE

CONDITIONS OF APPROVAL, IF ANY:

*See Instructions On Reverse Side

USGS(5) MCA-3 File

NEW MEXICO OIL CONSERVATION COMMISSION
WELL LOCATION AND ACREAGE DEDICATION PL

Form C-102
Supersedes C-128
Effective 1-1-65

All distances must be from the outer boundaries of the Section.

Operator CONTINENTAL OIL COMPANY		Lease MCA UNIT		Well No. 337	
Unit Letter H	Section 27	Township 17 SOUTH	Range 32 EAST	County LEA	
Actual Footage Location of Well: 2615 feet from the NORTH line and 25 feet from the EAST line					
Ground Level Elev.	Producing Formation <i>Grayburg Sandstone</i>		Pool <i>Maly' G-SA Report 40</i>	Dedicated Acreage: Acres	

- Outline the acreage dedicated to the subject well by colored pencil or hachure marks on the plat below.
- If more than one lease is dedicated to the well, outline each and identify the ownership thereof (both as to working interest and royalty).
- If more than one lease of different ownership is dedicated to the well, have the interests of all owners been consolidated by communitization, unitization, force-pooling, etc?

☐ Yes ☐ No If answer is "yes," type of consolidation _____

If answer is "no," list the owners and tract descriptions which have actually been consolidated. (Use reverse side of this form if necessary.) _____

No allowable will be assigned to the well until all interests have been consolidated (by communitization, unitization, forced-pooling, or otherwise) or until a non-standard unit, eliminating such interests, has been approved by the Commission.

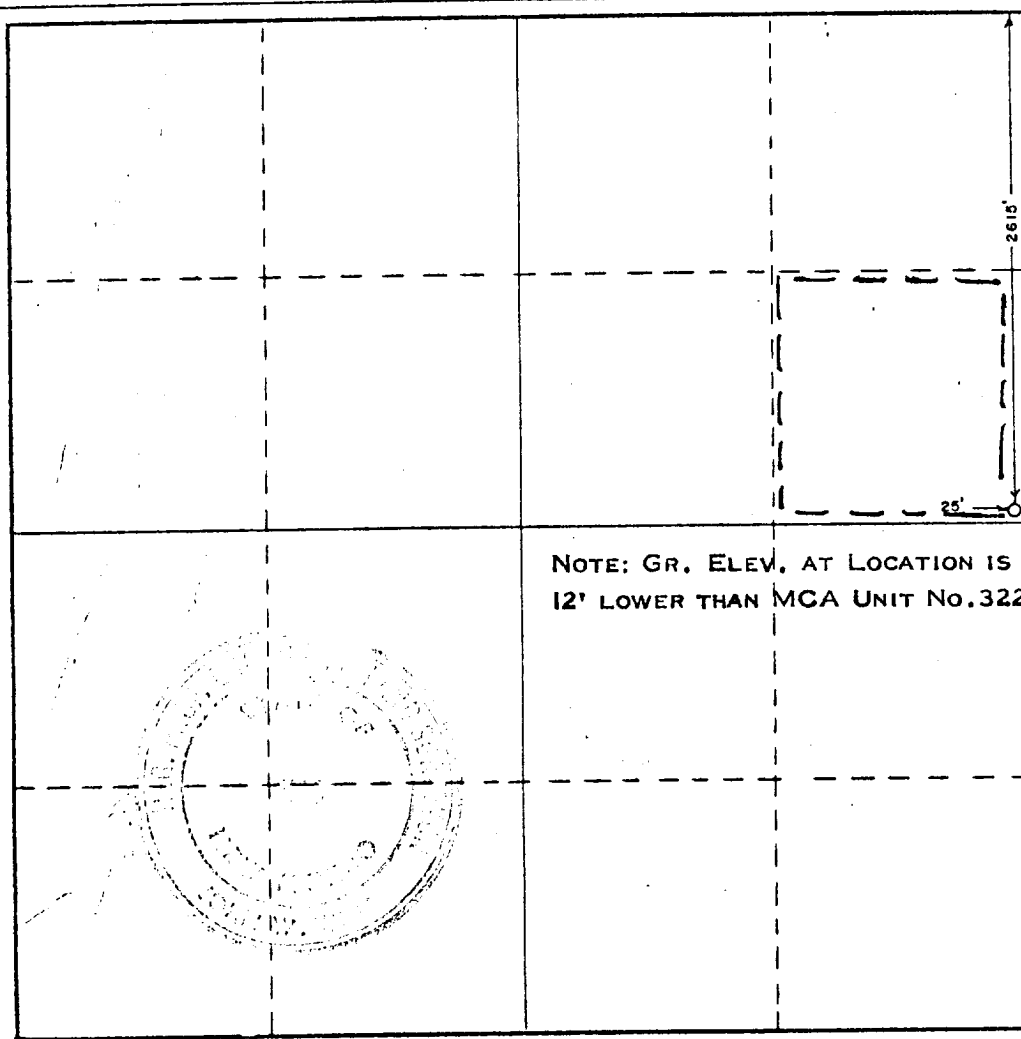

CERTIFICATION

I hereby certify that the information contained herein is true and complete to the best of my knowledge and belief.

Name *Robert Gault III*
Position *Admin. Supervisor*
Company *Continental Oil Co.*
Date *Feb 8, 1973*

I hereby certify that the well location shown on this plat was plotted from field notes of actual surveys made by me or under my supervision, and that the same is true and correct to the best of my knowledge and belief.

Date Surveyed
DECEMBER 30, 1972

Registered Professional Engineer
and/or Land Surveyor

Edmund West
Certificate No. **676**

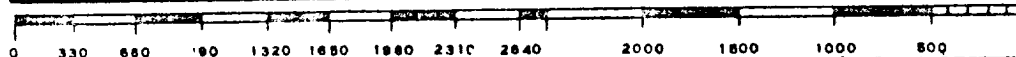

ENVIRONMENT CONSIDERATION STATEMENT

Application to Drill on Federal Leases

The attached plat shows the existing roads and, by red coloring, the proposed roads to service the proposed well. The plat also shows the location of tank battery and flowlines. There are no camps or airstrips contemplated to serve this lease.

Litter, such as paper, scrap iron, etc., will be picked up and hauled away. Salt water and other undesirable liquids will be picked up for disposal in approved disposal wells. Mud, drill cuttings, and other inert material will be disposed of by burying in the reserve pit when it is abandoned and the surface restored to level condition.

The second plat shows the proposed layout of the drilling rig in relation to the pad and shows the location of mud tanks, reserve pits, pipe racks, etc.

R-32-E

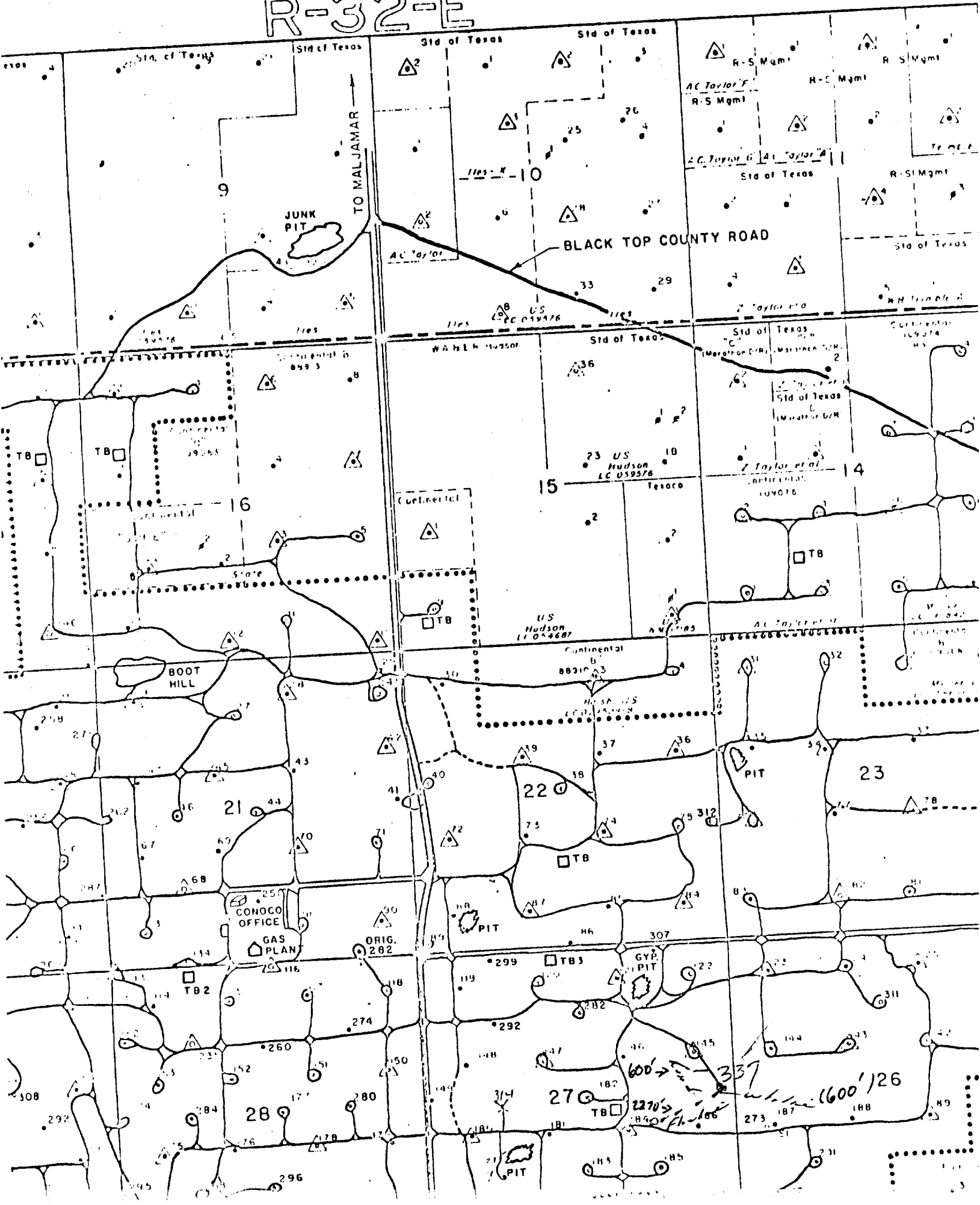

CACTUS DRILLING CO.
RIG # 52

CONTINENTAL OIL CO.
MCA UNIT
MALJAHAR WATER FLOOD
LEA CO., NEW MEXICO

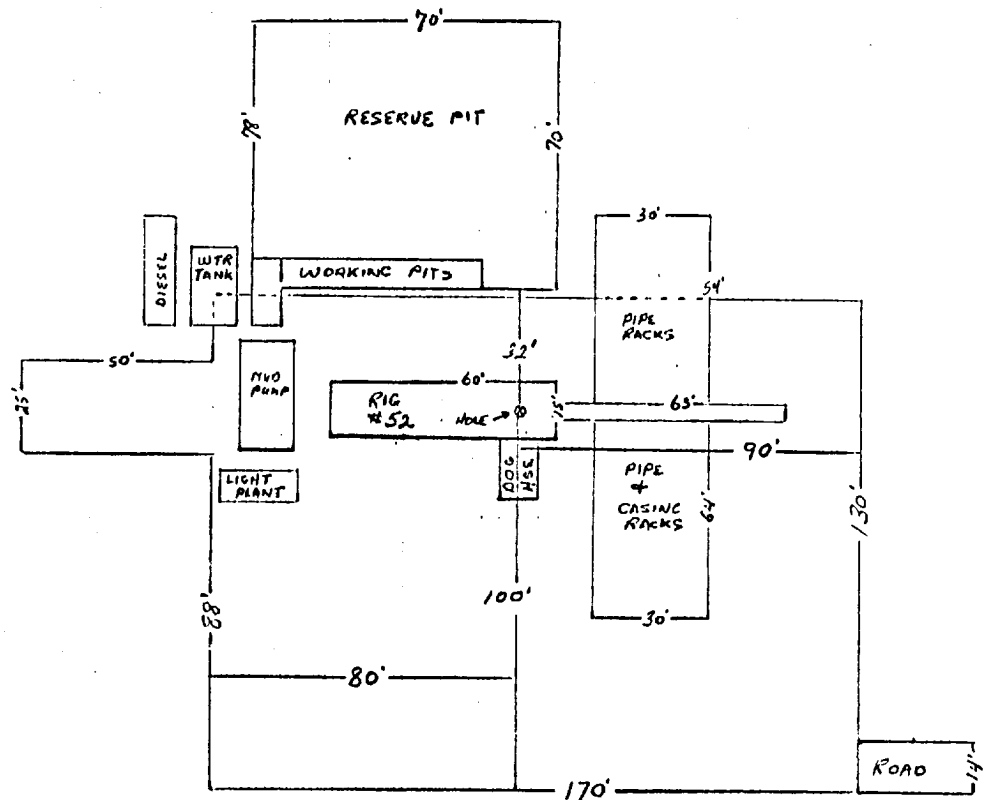

LOCATION:

130' - N to S
170' - E to W

HOLE: 30' FNL
80' FWL
100' FSL
90' FEL

25' X 50' STINGER ON WEST SIDE
OF LOCATION FOR TRAILER MTD RIG.

3/16 INCH = 10 FOOT