

1. NO. OF COPIES RECEIVED	
DISTRIBUTION	
SANTA FE	
FILE	
U.S.G.S.	
LAND OFFICE	
OPERATOR	

# NEW MEXICO OIL CONSERVATION COMMISSION

Form C-101  
Revised 1-1-65

5A. Indicate Type of Lease	
STATE <input checked="" type="checkbox"/>	FEE <input type="checkbox"/>
5. State Oil & Gas Lease No.	
B-2148	
7. Unit Agreement Name	
8. Farm or Lease Name	
Western State	
9. Well No.	
17	
10. Field and Pool, or Wildcat	
Maljamar Grayburg-S. A.	
12. County	
Lea	
19. Proposed Depth	19A. Formation
4,400'	Andres
20. Rotary or C.T.	
Rotary	
21. Elevations (Show whether DF, RT, etc.)	21A. Kind & Status Plug. Bond
4201 G.L.	Blanket
21B. Drilling Contractor	22. Approx. Date Work will start
Cactus Drilling Co.	4-10-73

1a. Type of Work	
DRILL <input checked="" type="checkbox"/> DEEPEN <input type="checkbox"/> PLUG BACK <input type="checkbox"/>	
b. Type of Well	
OIL WELL <input checked="" type="checkbox"/>	GAS WELL <input type="checkbox"/> OTHER <input type="checkbox"/>
2. Name of Operator	
Pennzoil Company	
3. Address of Operator	
P. O. Drawer 1828 - Midland, Texas 79701	
4. Location of Well	
UNIT LETTER F	LOCATED 1330' FEET FROM THE North LINE
AND 1330' FEET FROM THE West	LINE OF SEC. 20 TWP. 17-S RGE. 33-E NMPM
19. Proposed Depth	
4,400'	
19A. Formation	
Grayburg-San /	
20. Rotary or C.T.	
Rotary	
21. Elevations (Show whether DF, RT, etc.)	
4201 G.L.	
21A. Kind & Status Plug. Bond	
Blanket	
21B. Drilling Contractor	
Cactus Drilling Co.	
22. Approx. Date Work will start	
4-10-73	

## PROPOSED CASING AND CEMENT PROGRAM

SIZE OF HOLE	SIZE OF CASING	WEIGHT PER FOOT	SETTING DEPTH	SACKS OF CEMENT	EST. TOP
12 1/4"	9 5/8"	36#	1400'	650 SX	Circ.
8 3/4"	7"	26#	4395'	435 SX	2000'

Blowout preventers will be installed after the 9 5/8" casing is set.

APPROVAL VALID  
FOR 90 DAYS UNLESS  
DRILLING COMMENCED,

EXPIRES SEPT. 9, 1973

IN ABOVE SPACE DESCRIBE PROPOSED PROGRAM: IF PROPOSAL IS TO DEEPEN OR PLUG BACK, GIVE DATA ON PRESENT PRODUCTIVE ZONE AND PROPOSED NEW PRODUCTIVE ZONE. GIVE BLOWOUT PREVENTER PROGRAM, IF ANY.

I hereby certify that the information above is true and complete to the best of my knowledge and belief.

Signed J. C. Raney Title Petroleum Engineer Date 3-27-73

(This space for State Use)

APPROVED BY John A. Raney TITLE \_\_\_\_\_ DATE \_\_\_\_\_

CONDITIONS OF APPROVAL, IF ANY:

NEW MEXICO OIL CONSERVATION COMMISSION  
WELL LOCATION AND ACREAGE DEDICATION PLAT

Form C-102  
Supersedes C-128  
Effective 1-1-65

All distances must be from the outer boundaries of the Section

Operator <b>PENNZOIL COMPANY</b>			Lease <b>Western-State</b>		Well No. <b>17</b>
Unit Letter <b>F</b>	Section <b>20</b>	Township <b>17 South</b>	Range <b>33 East</b>	County <b>Lea</b>	
Actual Footage Location of Well: <b>1330</b> feet from the <b>north</b> line and <b>1330</b> feet from the <b>west</b> line					
Ground Level Elev. <b>4201.4</b>	Producing Formation <b>Grayburg-San Andres</b>		Pool <b>Maljamar</b>	Dedicated Acreage: <b>40</b> Acres	

1. Outline the acreage dedicated to the subject well by colored pencil or hachure marks on the plat below.
2. If more than one lease is dedicated to the well, outline each and identify the ownership thereof (both as to working interest and royalty).
3. If more than one lease of different ownership is dedicated to the well, have the interests of all owners been consolidated by communitization, unitization, force-pooling, etc?

☐ Yes ☐ No If answer is "yes," type of consolidation \_\_\_\_\_

If answer is "no," list the owners and tract descriptions which have actually been consolidated. (Use reverse side of this form if necessary.) \_\_\_\_\_

No allowable will be assigned to the well until all interests have been consolidated (by communitization, unitization, forced-pooling, or otherwise) or until a non-standard unit, eliminating such interests, has been approved by the Commission.

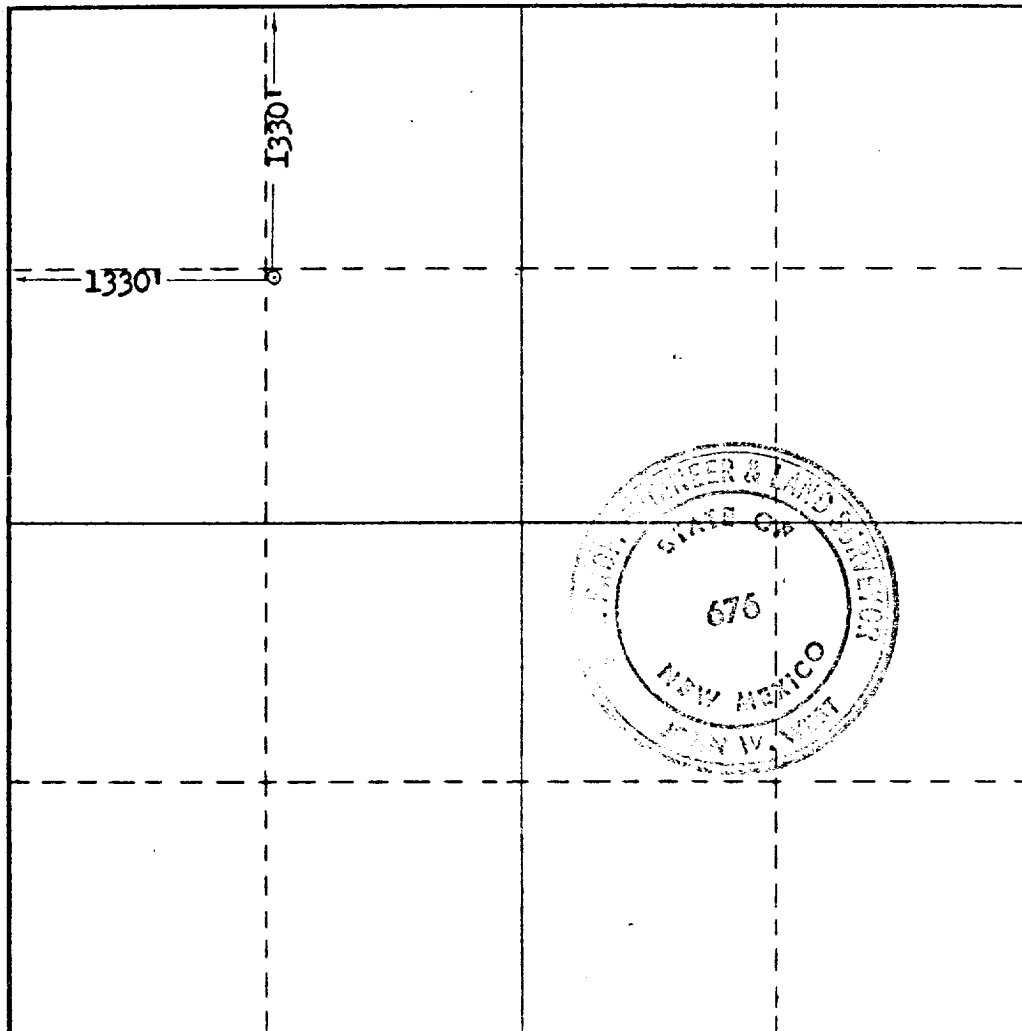

CERTIFICATION

I hereby certify that the information contained herein is true and complete to the best of my knowledge and belief.

Name  
*J. C. Raney*  
Position  
**Petroleum Engineer**  
Company  
**Pennzoil Company**

Date  
**3-27-73**

I hereby certify that the well location shown on this plat was plotted from field notes of actual surveys made by me or under my supervision, and that the same is true and correct to the best of my knowledge and belief.

Date Surveyed  
**March 6, 1973**  
Registered Professional Engineer  
and/or Land Surveyor

Certificate No.  
**676**

