

UNITED STATES  
DEPARTMENT OF THE INTERIOR

## GEOLOGICAL SURVEY

## APPLICATION FOR PERMIT TO DRILL, DEEPEN, OR PLUG BACK

## 1a. TYPE OF WORK

DRILL ☒DEEPEN ☐PLUG BACK ☐

## b. TYPE OF WELL

OIL  
WELL ☒GAS  
WELL ☐

OTHER

SINGLE  
ZONE ☒MULTIPLE  
ZONE ☐

## 2. NAME OF OPERATOR

Continental Oil Company

## 3. ADDRESS OF OPERATOR

Box 460 Hobbs, New Mexico

## 4. LOCATION OF WELL (Report location clearly and in accordance with any State requirements.\*)

At surface

55' FSL and 1200' FWL of Sec 27

At proposed prod. zone

Same

## 14. DISTANCE IN MILES AND DIRECTION FROM NEAREST TOWN OR POST OFFICE\*

## 10. DISTANCE FROM PROPOSED\*

LOCATION TO NEAREST

PROPERTY OR LEASE LINE, FT.

(Also to nearest drlg. unit line, if any)

## 18. DISTANCE FROM PROPOSED LOCATION\*

TO NEAREST WELL, DRILLING, COMPLETED,  
OR APPLIED FOR, ON THIS LEASE, FT.

## 16. NO. OF ACRES IN LEASE

7853

## 17. NO. OF ACRES ASSIGNED

TO THIS WELL

40

## 19. PROPOSED DEPTH

4425'

## 20. ROTARY OR CABLE TOOLS

rotary

## 21. ELEVATIONS (Show whether DF, RT, GR, etc.)

3970' gr

## 22. APPROX. DATE WORK WILL START\*

8-30-73

## 23.

## PROPOSED CASING AND CEMENTING PROGRAM

SIZE OF HOLE	SIZE OF CASING	WEIGHT PER FOOT	SETTING DEPTH	QUANTITY OF CEMENT
12 1/4"	8 5/8", H-40	20 #	1050'	Circ - 525 sacks
7 7/8"	5 1/2", K-55	14 #	4425'	350 sacks

It is proposed to drill a straight hole to a TD of 4425' and complete as a Hayling San Andres oilwell. Mud program - 0-1050' (8.5-9.5 Spud mud) and 1050'-4425' (9.5-10.5 salt gel). Blowout preventer program is attached.

IN ABOVE SPACE DESCRIBE PROPOSED PROGRAM: If proposal is to deepen or plug back, give data on present productive zone and proposed new productive zone. If proposal is to drill or deepen directionally, give pertinent data on subsurface locations and measured and true vertical depths. Give blowout preventer program, if any.

## 24.

SIGNED

(This space for Federal or State office use)

TITLE

Admin. Supervisor

DATE

8-14-73

PERMIT NO.

APPROVAL

APPROVED

AUG 22 1973

ARTHUR R. BROWN  
DISTRICT ENGINEER

APPROVED BY

TITLE

CONDITIONS OF APPROVAL, IF ANY:

\*See Instructions On Reverse Side

USGS-6 MCA-3 File

**RECEIVED**

AUG 28 1973

**OIL CONSERVATION COMM.**  
**HOBBS, N. M.**

NEW MEXICO OIL CONSERVATION COMMISSION  
WELL LOCATION AND ACREAGE DEDICATION

Form C-102  
Supersedes C-128  
Effective 1-1-65

All distances must be from the outer boundaries of the Section.

Operator <b>CONTINENTAL OIL COMPANY</b>			Lease <b>M C A</b>		Well No. <b>346</b>
Unit Letter <b>M</b>	Section <b>27</b>	Township <b>17 SOUTH</b>	Range <b>32 EAST</b>	County <b>LEA</b>	

Actual Footage Location of Well:

**55** feet from the **SOUTH** line and **1200** feet from the **WEST** line

Ground Level Elev.	Producing Formation <i>Grayburg San Andres</i>	Pool <i>Maly 2-SA Repress</i>	Dedicated Acreage: <b>40</b>	Acres
--------------------	---	----------------------------------	---------------------------------	-------

1. Outline the acreage dedicated to the subject well by colored pencil or hachure marks on the plat below.
2. If more than one lease is dedicated to the well, outline each and identify the ownership thereof (both as to working interest and royalty).
3. If more than one lease of different ownership is dedicated to the well, have the interests of all owners been consolidated by communitization, unitization, force-pooling, etc?

☐ Yes ☐ No If answer is "yes," type of consolidation \_\_\_\_\_

If answer is "no," list the owners and tract descriptions which have actually been consolidated. (Use reverse side of this form if necessary.) \_\_\_\_\_

No allowable will be assigned to the well until all interests have been consolidated (by communitization, unitization, forced-pooling, or otherwise) or until a non-standard unit, eliminating such interests, has been approved by the Commission.

CERTIFICATION

I hereby certify that the information contained herein is true and complete to the best of my knowledge and belief.

*John W. West*  
Position  
**Admin. Supervisor**  
Company  
**Continental Oil Co.**  
Date  
**August 14, 1973**

I hereby certify that the well location shown on this plat was plotted from field notes of actual surveys made by me or under my supervision, and that the same is true and correct to the best of my knowledge and belief.

Date Surveyed  
**JUNE 8, 1973**

Registered Professional Engineer and/or Land Surveyor

*John W. West*  
Certificate No. **676**

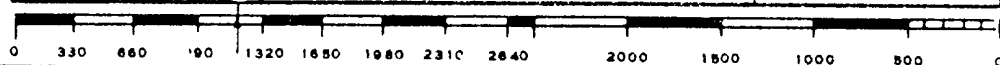

**RECEIVED**

**AUG 23 1973**

**U.S. CONSERVATION COMM.  
HOBBS, N. M.**

## Development Plan For Surface Use

1. Existing roads including location of the exit from the main highway

See Attached Map

2. Planned access roads

See Below and Attached Map

- a. Length and width of new road -  $12' \times 1780'$
- b. Roads will be ~~compacted or~~ surfaced

3. Location of existing wells

See Attached Map

4. Lateral roads to well location

See Attached Map

5. Location of tank batteries and flowlines

See Attached Map

6. Location and type of water supply

( ) Water will be hauled to location

(☒) See attached map for location of proposed water lines

7. Methods for handling waste disposal

Litter, such as paper, scrap iron, etc., will be picked up and disposed of. Salt water and other undesirable liquids will be disposed of by approved methods. Drilling fluids, drill cuttings, and other inert material will be disposed of by burying in the reserve pit when it is abandoned and the surface restored to level condition.

8. and 9. Location of camps and airstrips

There are no camps or airstrips contemplated to serve this lease.

10. Location of layout to include position of the rig, mud tanks, reserve pits, burn pits, pipe racks, etc.

See Below and Attached plat

- a. Size of drilling pad -  $180' \times 130'$
- b. Drilling pad ~~compacted or~~ surfaced

11. Plans for restoration of the surface

Surface will be levelled and properly conditioned.

12. Other information that may be used in evaluating the impact on environment

The terrain in this area is generally flat with very little vegetation. No streams or other major water sheds are located in this area.



CONTINENTAL OIL COMPANY  
Blow-out Preventer Specifications

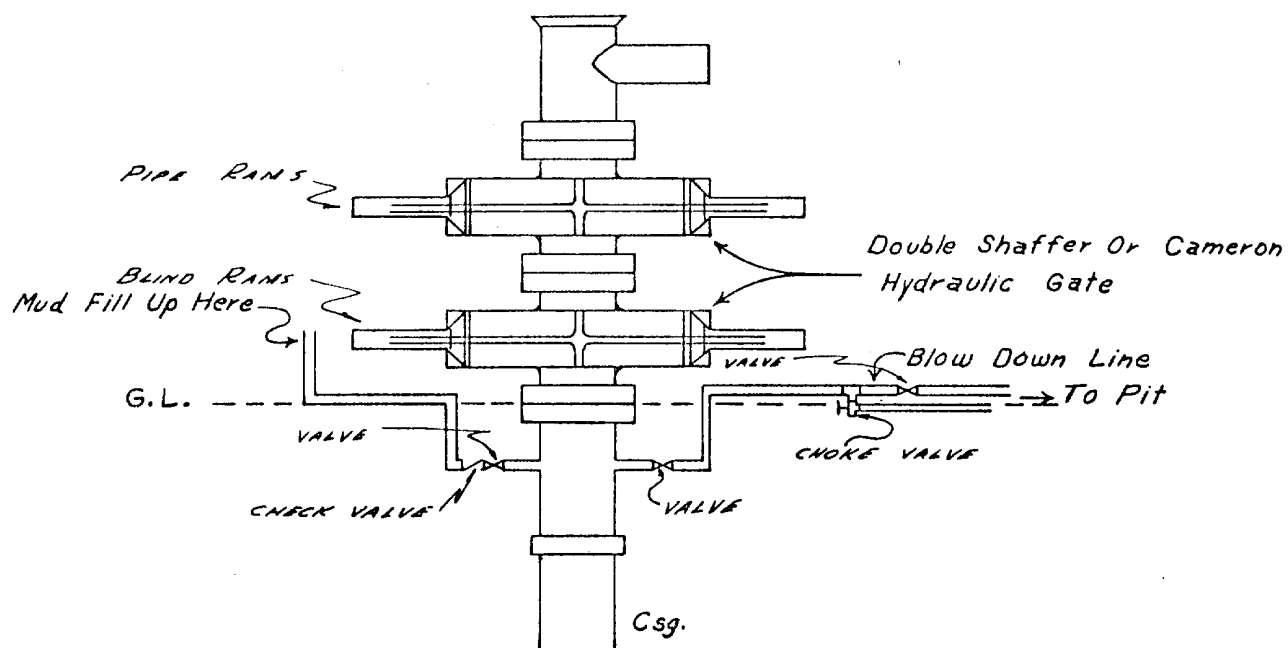

NOTE:

Manual and hydraulic controls with closing unit no less than 75' from well head.

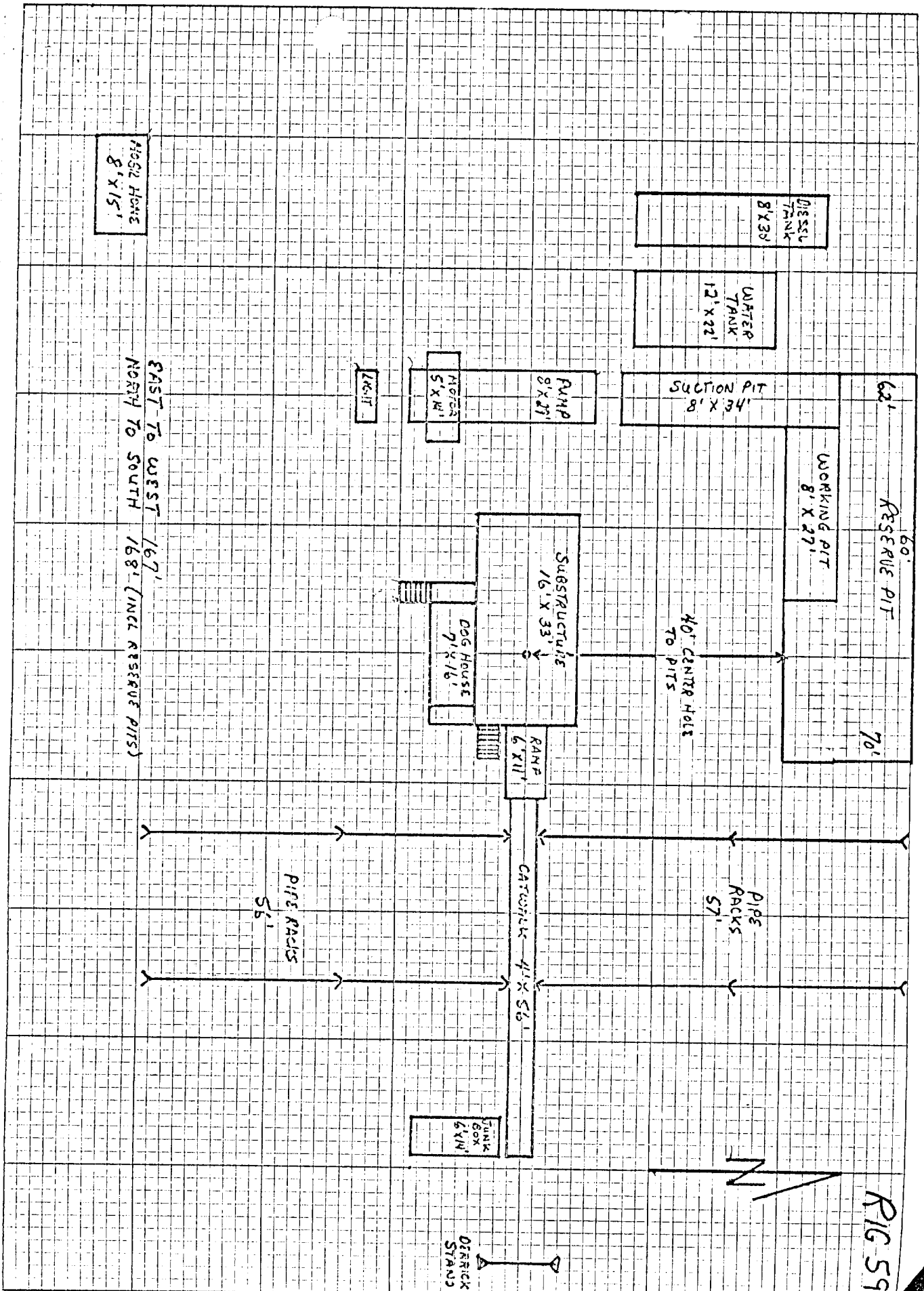

FIG 59



RECEIVED

AUG 28 1973

OIL CONSERVATION COMM.  
MOBBS, N. H.

413